

APN 05-141-070

RECORDING REQUESTED BY
First American Title Company of Nevada
ORDER # 2001-54777-S/Esc#406156-CD
APN 0000-05-141-070

WHEN RECORDED MAIL TO
Name Charles C. Pierce
Street Address 1601 Second Street
City State Zip San Rafael, CA 94901

MAIL TAX STATEMENT TO ABOVE

SPACE ABOVE THIS LINE FOR RECORDER'S USE

Grant Deed

The undersigned grantor(s) declare(s):
Documentary transfer tax is \$ -0- Interspousal Transfer
(X) computed on full value of property conveyed, or
() computed on full value less value of liens and encumbrances remaining at time of sale.
() Unincorporated area: () City of
() Realty not sold.

FOR A VALUABLE CONSIDERATION, receipt of which is hereby acknowledged,
Linda K. Pierce, the spouse of the grantee herein

hereby GRANT(S) to Charles C. Pierce, a married man as his sole and separate property

that property in Douglas County, State of Nevada, described as: Exhibit A attached hereto and made a part hereof

Mail Tax Statements to Grantee at address above

Date January 27, 2002

Linda K. Pierce
Linda K. Pierce

STATE OF CALIFORNIA
COUNTY OF Marin

On 2/1/02 before me, the undersigned, a Notary Public in and for said State, personally appeared Linda K. Pierce

personally known to me (or proved to me on the basis of satisfactory evidence) to be the person(s) whose name(s) is/are subscribed to the within instrument and acknowledged to me that he/she/they executed the same in his/her/their authorized capacity(ies), and that by his/her/their signature(s) on the instrument the person(s), or the entity upon behalf of which the person(s) acted, executed the instrument.

WITNESS my hand and official seal.

Signature *Angela Gosselin*
Name Angela Gosselin
(typed or printed)

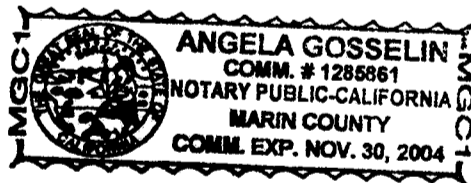

(This area for official notarial seal)

FTGIS-140 8/94

MAIL TAX STATEMENTS AS DIRECTED ABOVE

0534375

BK0202PG2964

It is the express intent of the grantor, being the spouse of the grantee, to convey all right, title and interest of the grantor, community or otherwise, in and to the herein described property, to the grantee as his/her sole and separate property.

Linda K. Pierce
Linda K. Pierce

SOLE AND SEPARATE PROPERTY

0534375
BK0202PG2965

DESCRIPTION

All that certain lot, piece or parcel of land situate in the County of Douglas, State of Nevada, described as follows:

Lot 82, as shown on the Map of ZEPHYR KNOLLS SUBDIVISION, UNIT NO. 4, filed in the Office of the County Recorder of Douglas County, State of Nevada on October 14, 1957, in Book 1 of Maps, Document No. 12699.

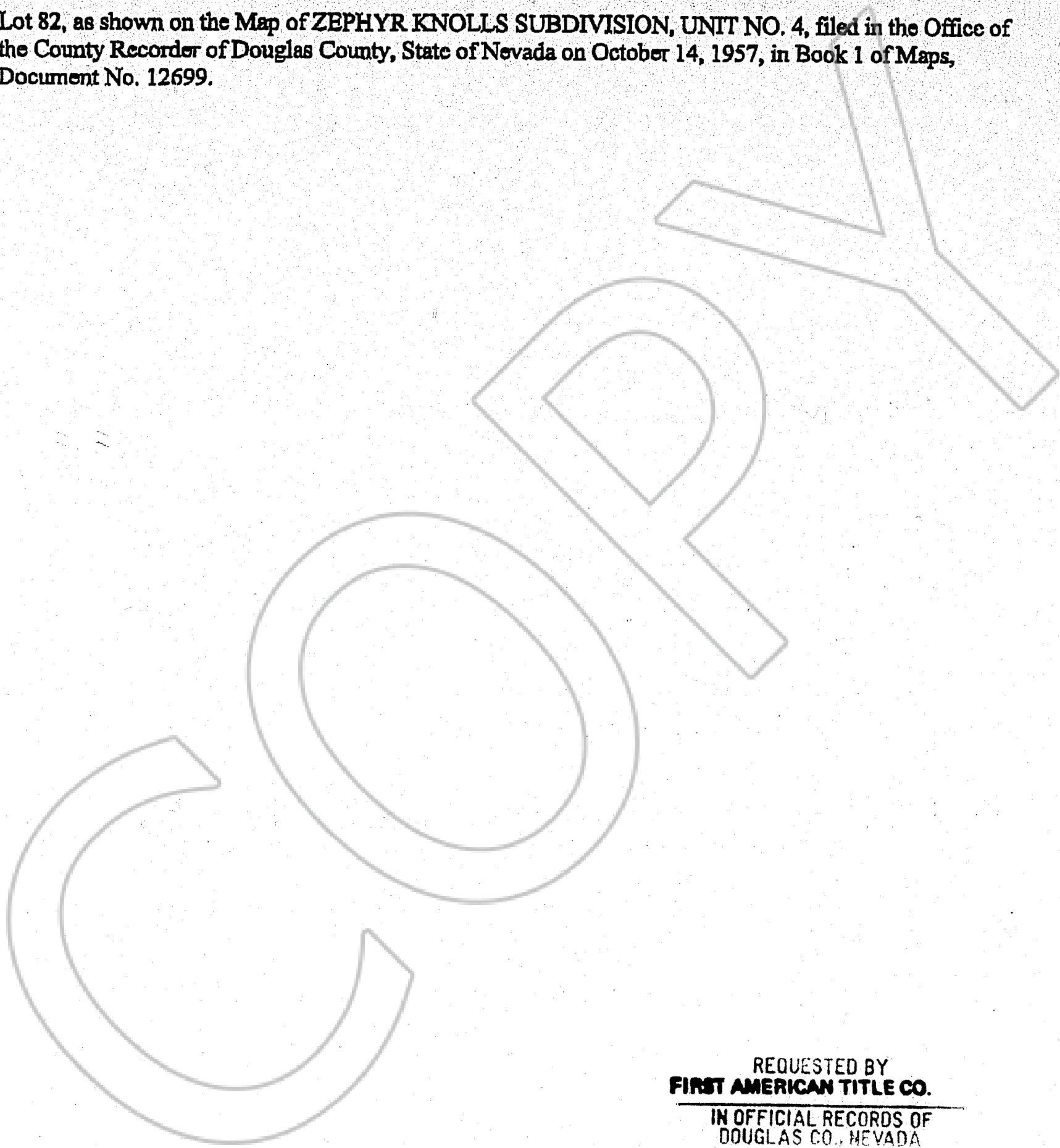

REQUESTED BY
FIRST AMERICAN TITLE CO.

IN OFFICIAL RECORDS OF
DOUGLAS CO., NEVADA

2002 FEB -8 PM 4: 04

LINDA SLATER
RECORDER

s/ *16* PAID *KJ* DEPUTY

0534375

BK 0202 PG 2966