

APN: 1220-15-511-007

PREPARED BY:

John Markert
Bank Of Blue Valley

11935 Riley
Overland Park, KS 66225
AND WHEN RECORDED MAIL TO

NAME Bank Of Blue Valley
ADDRESS
CITY & STATE 11935 Riley
Overland Park, KS 66225

Loan # 01-0581 2001-54466KM

SPACE ABOVE THIS LINE FOR RECORDER'S USE

Corporation Assignment of Real Estate Mortgage

FOR VALUE RECEIVED, the undersigned hereby grants, assigns and transfers to
WELLS FARGO HOME MORTGAGE, INC.
all the rights, title and interest of undersigned in and to that certain Real Estate Mortgage dated **MAY 11, 2001**,
exec uted by
ROBERT L. WIGTON AND SUSAN L. BULLARD

to **Bank Of Blue Valley**
a corporation organized under the laws of The State of Kansas and whose principal place of business is
11935 Riley, Overland Park, KS 66225
and recorded in Liber 501 page(s) 4610 Doc. No. 514267 **DOUGLAS** County Records.
State of **NEVADA** described hereinafter as follows:

SEE ATTACHED LEGAL DESCRIPTION

ALSO KNOWN AS: 974 BIRDIE COURT
GARNERVILLE, NEVADA 89410

TOGETHER with the note or notes therein described or referred to, the money due and to become due thereon with interest,
and all rights accrued or to accrue under said Real Estate Mortgage. Bank Of Blue Valley

STATE OF Kansas
COUNTY OF Johnson

On 11/4/02 before me,
the undersigned, a Notary Public in and for said County and
State, personally appeared **JOHN MARKERT**
known to me to be the **VICE PRESIDENT**
and , known to me to be

of the corporation herein which
executed the within instrument, that the seal affixed to said
instrument is the corporate seal of said corporation; that said
instrument was signed and sealed on behalf of said corporation
pursuant to its by-laws or a resolution of its Board of Directors
and that he/she acknowledges said instrument to be the free act
and deed of said corporation.

Notary Public *Angie R. Hunt* Johnson County,
My Commission Expires *KANSAS*

John Markert
By: **JOHN MARKERT**
Its: **VICE PRESIDENT**
By:
Its:
Witness: **KATHY HERBERT**

(THIS AREA FOR OFFICIAL NOTARIAL SEAL)

NOTARY PUBLIC
ANGIE R. HUNT
My Appt. Exp. 4/1/05
STATE OF KANSAS

0535593

BK0202PG08664

DESCRIPTION

All that certain lot, piece or parcel of land situate in the County of Douglas, State of Nevada, described as follows:

PARCEL 1:

Lot 10 as said lot is shown on the Official Plat of GARDNERVILLE RANCHOS UNIT NO. 3, filed in the office of the County Recorder of Douglas County, State of Nevada, on June 1, 1965, as File No. 28310 and amended on June 4, 1965, as file No. 28378.

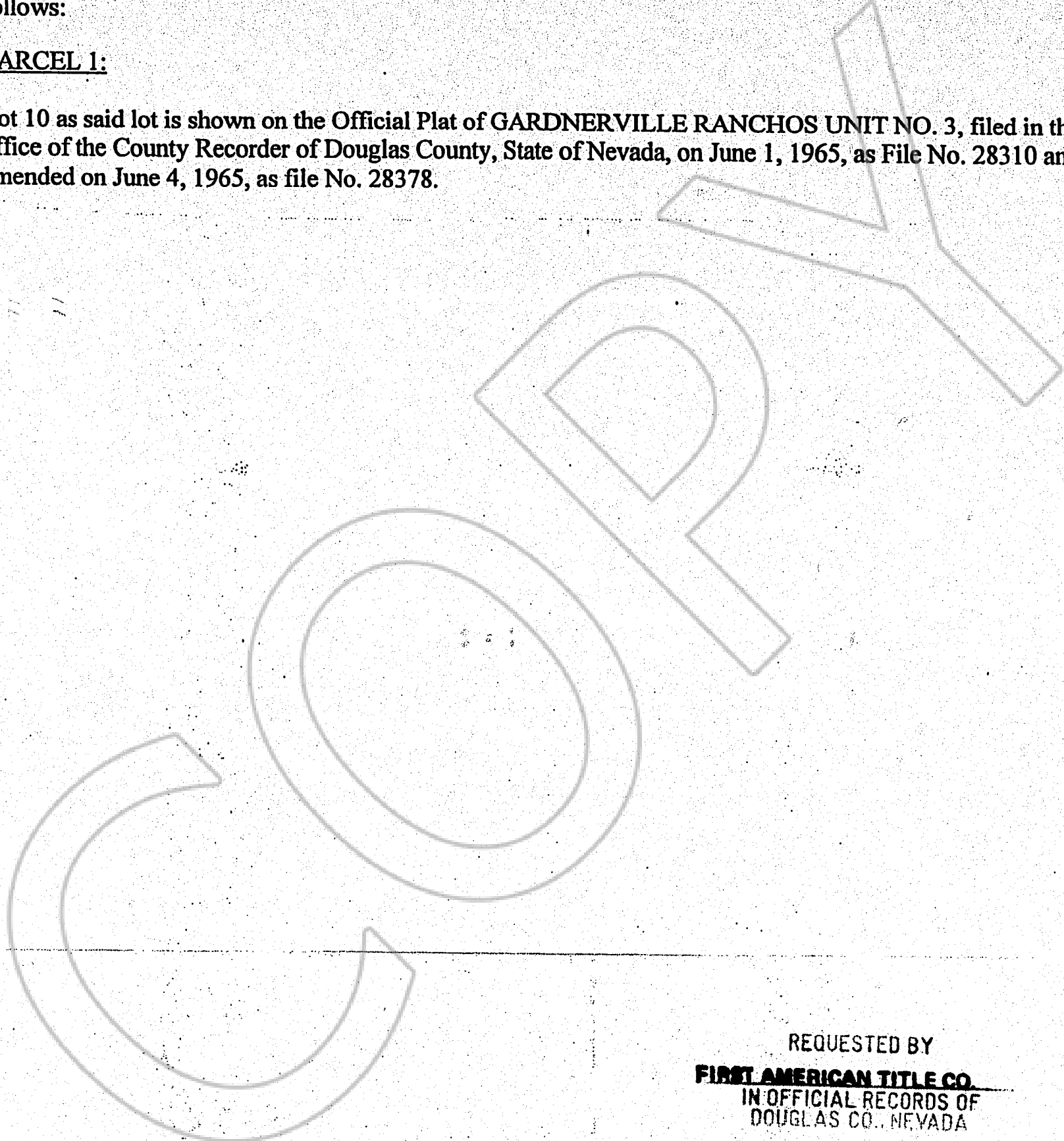

REQUESTED BY
FIRST AMERICAN TITLE CO.
IN OFFICIAL RECORDS OF
DOUGLAS CO., NEVADA

2002 FEB 26 AM 11: 28

LINDA SLATER
RECORDER

\$ 15⁰⁰ PAID *KJ* DEPUTY

0535593

BK 0202 PG 08665