

A.P.N. # 1420-07-616-039

RECORDING REQUESTED BY:  
**STEWART TITLE COMPANY**

WHEN RECORDED MAIL TO:

MAIL TAX STATEMENTS TO:

R.P.T.T. \$ 0 #8  
ESCROW NO. 020300723A  
Full Value

**MINER**  
**967 OPALITE DRIVE**  
**CARSON CITY, NV 89705**

### GRANT, BARGAIN, SALE DEED

THIS INDENTURE WITNESSETH: That **JEFFREY P. MINER AND KAREN D. MINER, HUSBAND AND WIFE**

in consideration of \$10.00, the receipt of which is hereby acknowledged, does hereby Grant, Bargain Sell and Convey to **JEFFREY PAUL MINER AND KAREN DIANE MINER, TRUSTEES OF THE JEFFREY PAUL MINER AND KAREN DIANE MINER REVOCABLE TRUST DATED 2-8-01**

and to the heirs and assigns of such Grantee forever, all that real property situated in the County of **DOUGLAS** State of Nevada, bounded and described as follows:  
**SEE EXHIBIT "A" ATTACHED HERETO AND MADE A PART HEREOF**

Together with all and singular the tenements, hereditaments and appurtenances thereunto belonging or in anywise appertaining, and any reversions, remainders, rents, issues or profits thereof.

DATE: **February 28, 2002**

*Jeffrey P. Miner*  
\_\_\_\_\_  
**JEFFREY P. MINER**  
*Karen D. Miner*  
\_\_\_\_\_  
**KAREN D. MINER**



STATE OF Nevada }  
COUNTY OF Douglas } ss.

This instrument was acknowledged before me on 3/6/02,  
by, JEFFREY P. MINER and KAREN D. MINER

Signature *M. Omohundro*  
\_\_\_\_\_  
Notary Public

**0536653**  
**BK0302PG03410**

**LEGAL DESCRIPTION**

The land referred to herein is situated in the State of Nevada, County of Douglas, described as follows:

Lot 89, Block B, as shown on the filed map of HIGHLAND ESTATES UNIT NO. 2, filed in the office of the County Recorder of Douglas County, State of Nevada, on July 27, 1978, as Document No. 17090.

Assessors Parcel No. 1420-07-616-039

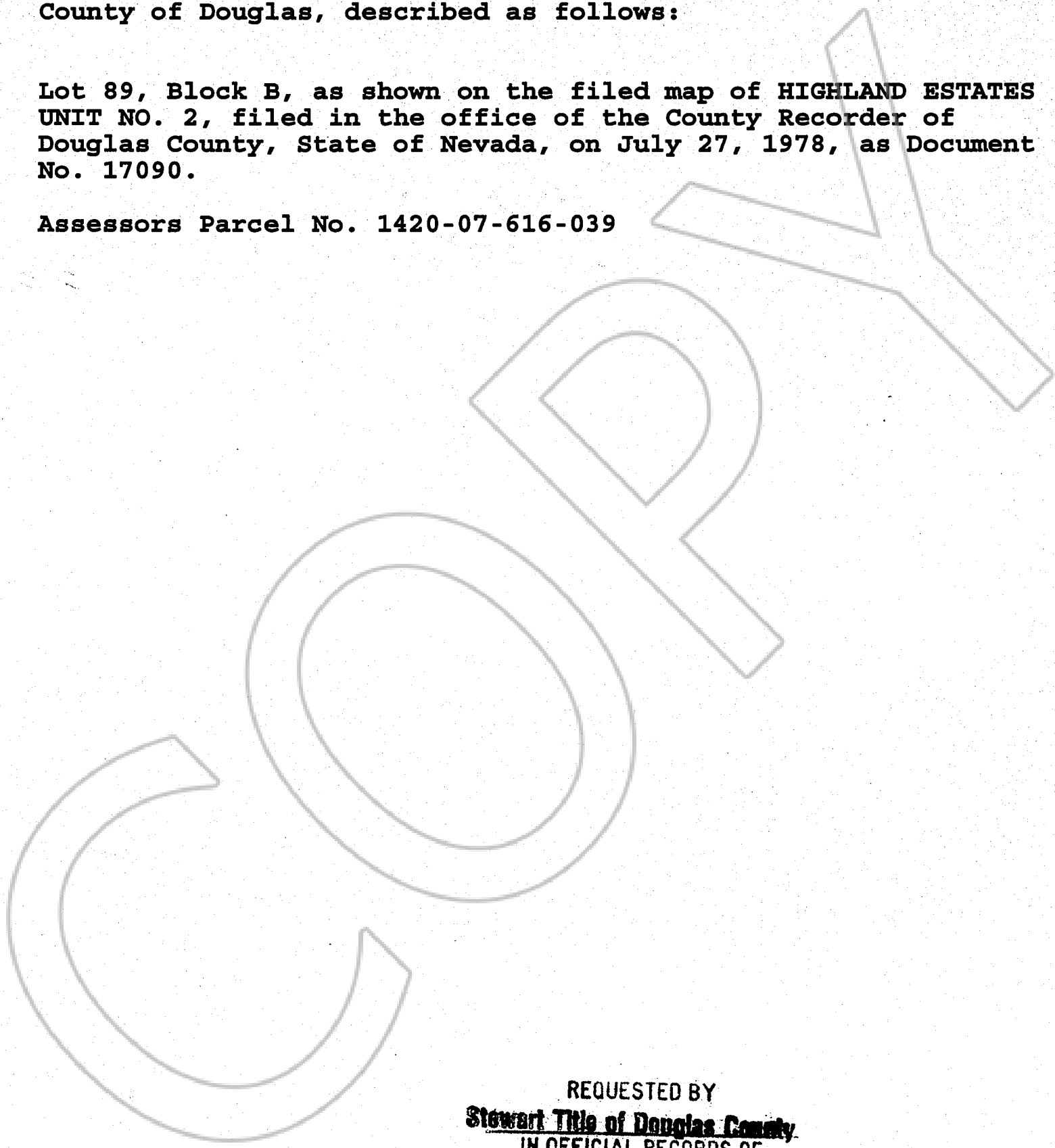

REQUESTED BY  
~~Stewart Title of Douglas County~~  
IN OFFICIAL RECORDS OF  
DOUGLAS CO., NEVADA

2002 MAR 11 AM 10:43

LINDA SLATER  
RECORDER

\$15<sup>00</sup> PAID *Kg* DEPUTY

0536653

BK0302PG03411