

LEGAL DESCRIPTION

The land referred to herein is situated in the State of Nevada,
County of, described as follows:

A parcel of land situate in the Northwest 1/4 of the Southeast
1/4, of Section 33, Township 14 North, Range 20 East,
M.D.B.&M., Douglas County, State of Nevada, more particularly
described as follows:

Parcel A, as shown on that Parcel Map for Roland Lemus,
Recorded on April 25, 1979, in Book 479, Page 1377, as Document
No. 31831, Official Records of Douglas County, State of Nevada.

APN 1420-33-701-014

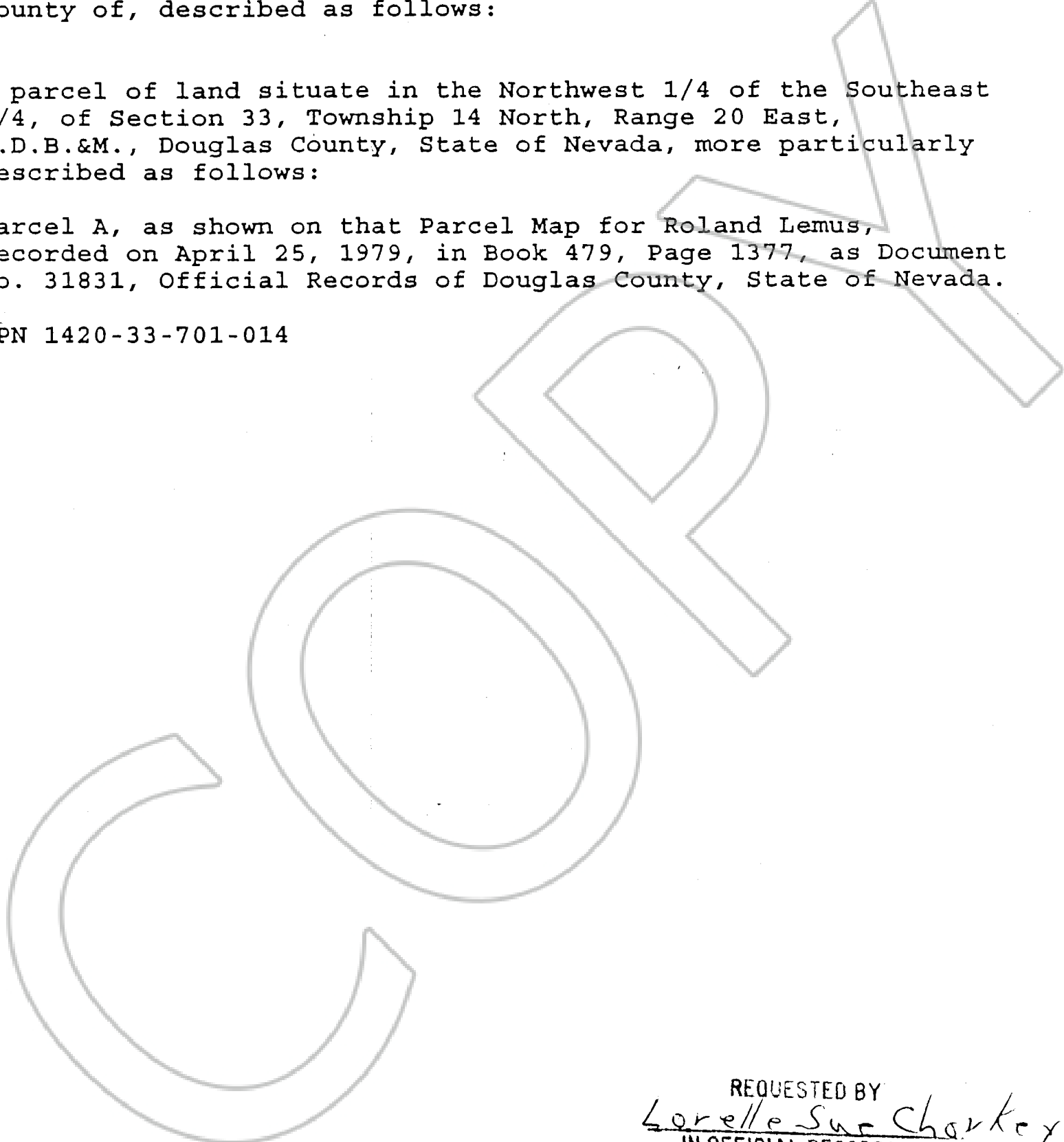

REQUESTED BY
Lorelle Sue Charkey
IN OFFICIAL RECORDS OF
DOUGLAS CO., NEVADA

2002 MAR 13 AM 11:54

LINDA SLATER
RECORDER

\$ *15.00* PAID *ka* DEPUTY

0536881

BK0302PG04519