

EXHIBIT "A"

LEGAL DESCRIPTION

ESCROW NO.: 010203137

Unit C as set forth on the Condominium Map of Lot 69, TAHOE VILLAGE UNIT NO. 1, filed for record in the office of the County Recorder of Douglas County, on November 12, 1974, in Book 1174, Page 264, Document No. 76347 of Official Records being a subdivision Lot 69, Amended map of Tahoe Village Unit No. 1, (formerly Alpine Village Unit No. 1), filed for record in the office of the County Recorder of Douglas County, State of Nevada, on December 7, 1971, in Book 94, Page 203, as Document No. 55769.

TOGETHER WITH an undivided 1/4 interest in the common area as set forth on the CONDOMINIUM MAP OF LOT 69.

Assessor's Parcel No. 40-140-040

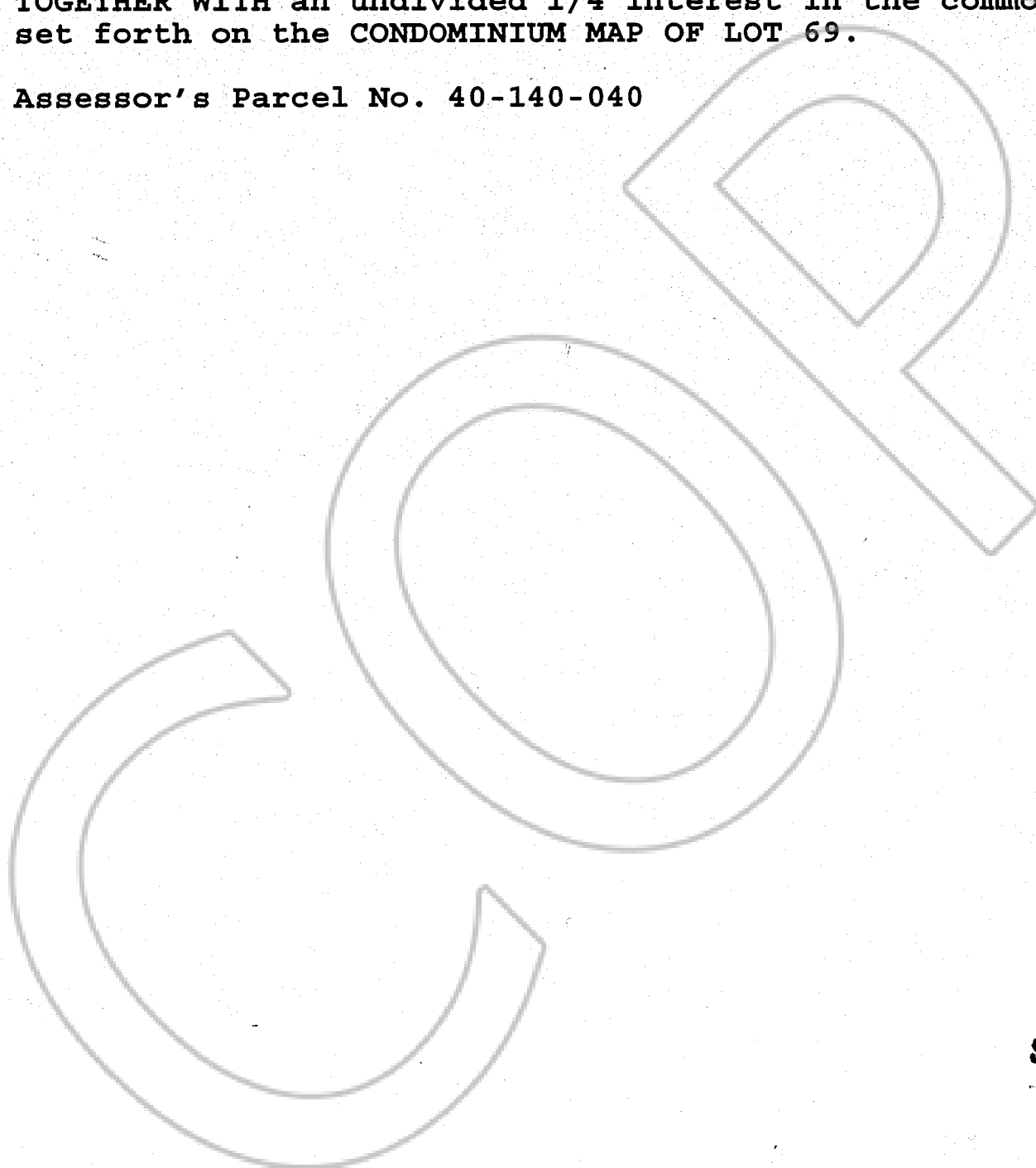

REQUESTED BY
Stewart Title of Douglas County

IN OFFICIAL RECORDS OF
DOUGLAS CO., NEVADA

2002 APR 22 PM 3: 57

LINDA SLATER
RECORDER

\$ 15⁰⁰ PAID BC DEPUTY

0540224

BK 0402 PG 06670