

15.

✓ RBMG, INC.
9710 TWO NOTCH ROAD
COLUMBIA, SC 29223
ATTENTION: SHERILL E. SEERY

MORTGAGEE'S AFFIDAVIT

The undersigned, DENISE EASTERLING, does hereby depose and say as follows:

1. That I am an authorized officer of the mortgagee (or assignee), Mortgage Electronic Registration Systems, Inc.
2. That this affidavit refers to the Mortgage from Eric Negrete and Dionna Negrete to Mortgage Electronic Registration Systems, Inc. as nominee for RBMG, INC., in relation to property located at 784 Saddle Court, Gardnerville, NV 89410, Dated March 12, 2002, and recorded at the Douglas County Recorder's Office in Book 0302, Page 05850 and/or Document Number 0537151. ****SEE LEGAL DESCRIPTION ATTACHED****
3. That the Mortgage Identification Number (MIN) was either omitted or incorrect on said Mortgage.
4. That the correct MIN for the Mortgage is MIN 1000144-2000161058-5 and that the MERS telephone number to call for information when using this MIN is (888) 679-6377.

Signed this 17th day of April, 2002

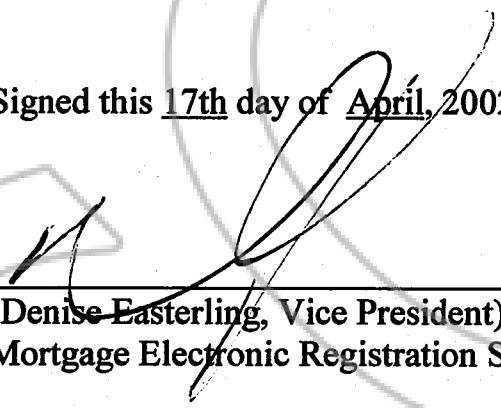

 (Denise Easterling, Vice President)
 Mortgage Electronic Registration Systems, Inc.

State of South Carolina
County of Lexington

On this 17th day of April, 2002, before me, the undersigned, Abby C. Ray, a Notary Public in and for said County and State personally appeared Denise Easterling, who is the Vice President of the corporation herein which executed the within instrument.



 Notary Public
 MY COMMISSION EXPIRES: 9/21/10

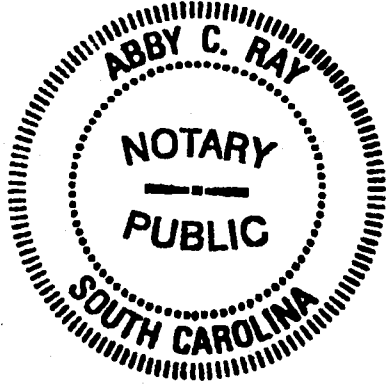

0540476

BK 0402 PG 07428

EXHIBIT "A"

THE LAND REFERRED TO HEREIN IS SITUATED IN THE STATE OF NEVADA, COUNTY OF DOUGLAS, DESCRIBED AS FOLLOWS:

ALL THAT CERTAIN LOT, PIECE OR PARCEL OF LAND SITUATE IN THE COUNTY OF DOUGLAS, STATE OF NEVADA, DESCRIBED AS FOLLOWS:

A PORTION OF THE NORTH ½ OF THE NORTH ½ OF THE NORTHEAST ¼ OF SECTION 24, TOWNSHIP 12 NORTH, RANGE 20 EAST, M.D.B. &M., MORE PARTICULARLY DESCRIBED AS FOLLOWS:

PARCEL B1 AS SHOWN ON THE PARCEL MAP FOR LUCY JOYCE #1, FILED FOR RECORD OCTOBER 22, 1990, IN BOOK 1090, PAGE 3218, AS DOCUMENT NO. 237138, OFFICIAL RECORDS, DOUGLAS COUNTY, NEVADA, BEING A RE-SUBDIVISION OF PARCEL B OF THE PARCEL MAP FOR PETER S. BOWIE AS DOCUMENT NO. 13230.

A.P. N. 1220-24-501-006

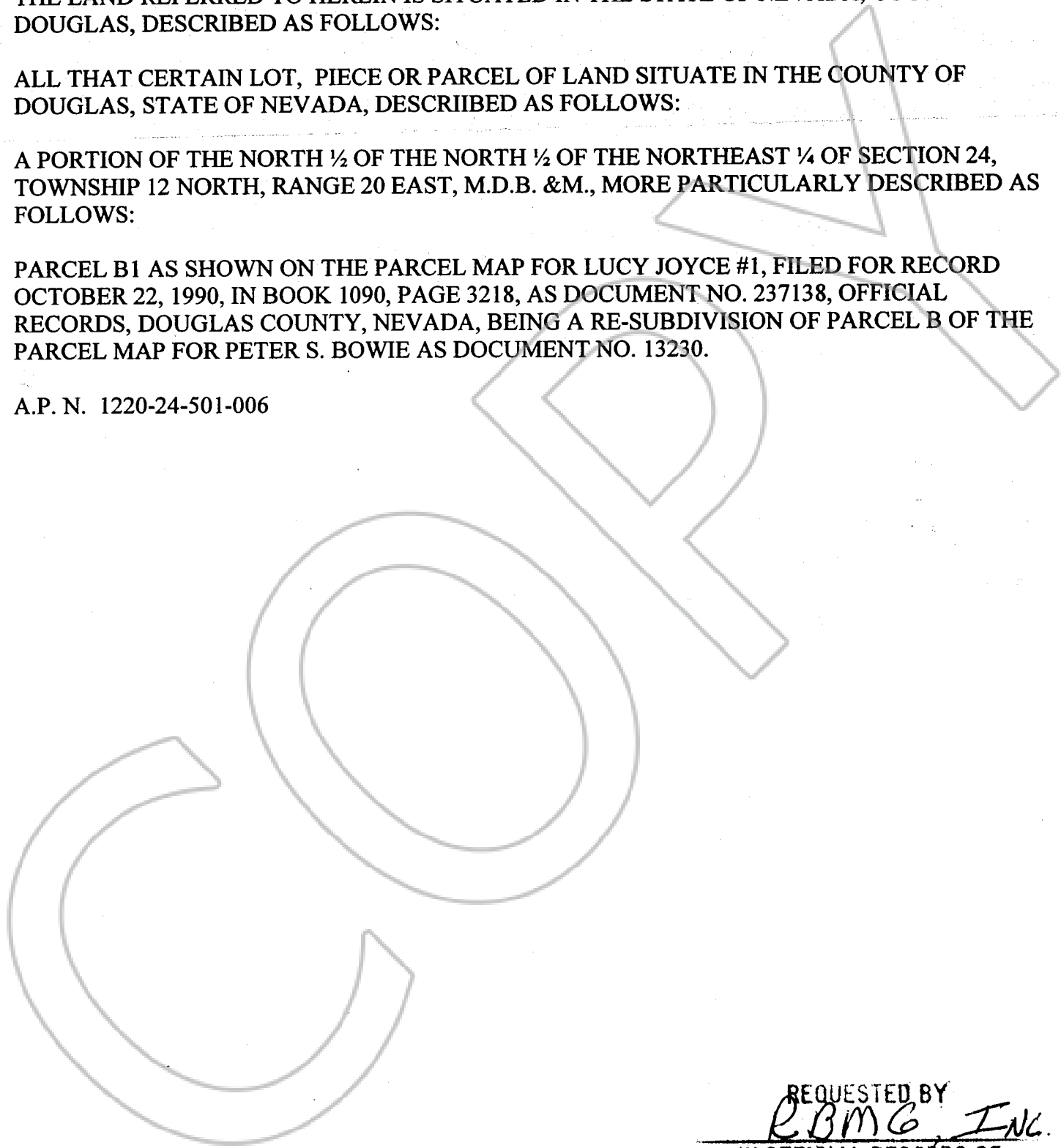

REQUESTED BY
R.B.M.G. INC.
IN OFFICIAL RECORDS OF
DOUGLAS CO. NEVADA

2002 APR 24 PM 1:50

LINDA SLATER
RECORDER

\$ 15.00 PAID *[Signature]* DEPUTY

0540476

BK0402PG07429