



IN WITNESS WHEREOF, I have hereunto set my hand, signed, and executed  
this GENERAL POWER OF ATTORNEY on this 11 day of April, 2002.

Isabell Seebold  
ISABELL SEEBOLD

Subscribed, sworn to and acknowledged before me by ISABELL SEEBOLD  
this 11 day of April, 2002.

My Commission Expires: Oct. 3, 2005

Linda G. Stille **SEAL**  
Notary Public, Ky. State at Large

PREPARED BY:

H. Douglas Willen

H. Douglas Willen  
FLETCHER, COTTHOFF & WILLEN  
700 South Main Street  
P.O. Box 1107  
Hopkinsville, KY 42241-1107  
(502) 885-7671

SEE Exhibit "A"

0540639

BK0402PG07919

**LEGAL DESCRIPTION**

The land referred to herein is situated in the State of Nevada, County of Douglas, described as follows:

Lot 95 as shown on the map of SIERRA VIEW SUBDIVISION, filed in the office of the County Recorder on April 18, 1960, under File No. 15897.

Assessors Parcel No. 1420-34-710-059

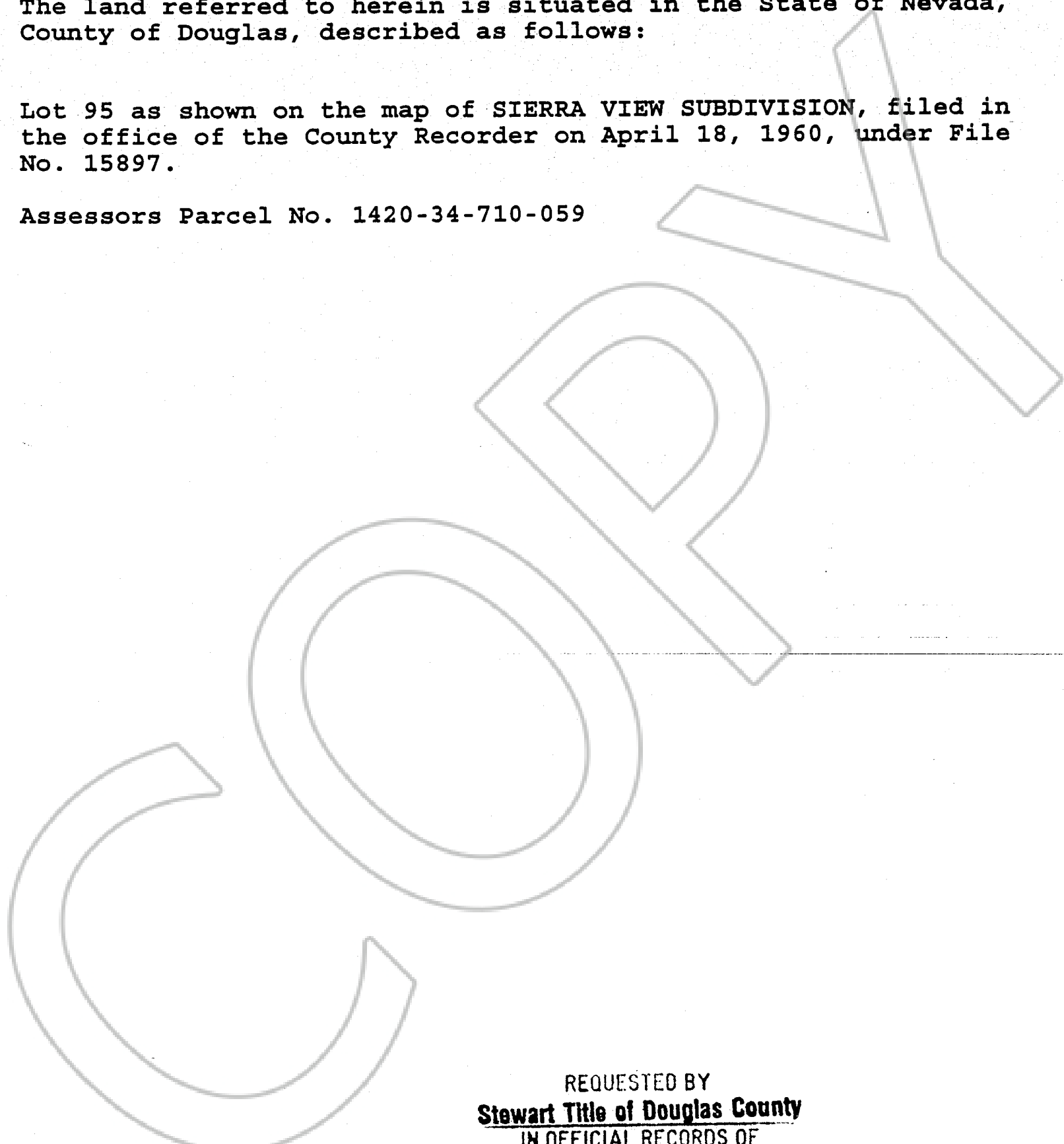

REQUESTED BY  
**Stewart Title of Douglas County**  
IN OFFICIAL RECORDS OF  
DOUGLAS CO., NEVADA

2002 APR 25 PM 3: 28

LINDA SLATER  
RECORDER

\$16<sup>00</sup> PAID *KJ* DEPUTY

0540639

BK0402PG07920