

LEGEND

- FOUND 5/8" REBAR/CAP
PLS 6200
- ◆ FOUND AS NOTED
- ▲ SET 5/8" REBAR/CAP
PLS 8659

REFERENCE DATA

RECORD MAP DOCUMENT No. 471564
RECORD OF SURVEY DDC. No. 479081
PARCEL MAP DOCUMENT No. 363387
RECORD OF SURVEY DDC. No. 452098
RECORD OF SURVEY DDC. No. 449373
RECORD MAP DOCUMENT No. 369825
ASSESSOR PLATS

OWNER'S CERTIFICATE

I THE UNDERSIGNED OWNER OF THE AFFECTED PARCELS AS SHOWN ON THIS MAP DO HEREBY STATE:
1) I HAVE EXAMINED THIS PLAT AND APPROVE AND AUTHORIZE ITS RECORDING;
2) I AGREE TO EXECUTE THE REQUIRED DOCUMENTS CREATING ANY EASEMENT WHICH IS SHOWN HEREON;
3) I AGREE TO EXECUTE THE REQUIRED DOCUMENTS ABANDONING ANY EXISTING EASEMENT PURSUANT TO THE PROVISIONS OF NRS 278.010 TO 278.630, INCLUSIVE AND SECTIONS 2 AND 3 OF CHAPTER 479 OF THE SIXTY-SIXTH LEGISLATIVE SESSION;
4) ALL PROPERTY TAXES ON THE LAND FOR THE FISCAL YEAR HAVE BEEN PAID;
5) ANY LENDER WITH AN IMPOUND ACCOUNT FOR THE PAYMENT OF TAXES HAS BEEN NOTIFIED OF THE ADJUSTMENT OF THE BOUNDARY LINE OR THE TRANSFER OF THE LAND.

Nick Disalvo 5-17-02
NICK DISALVO DATE

OWNER'S CERTIFICATE

WE THE UNDERSIGNED OWNERS OF THE AFFECTED PARCELS AS SHOWN ON THIS MAP DO HEREBY STATE:
1) WE HAVE EXAMINED THIS PLAT AND APPROVE AND AUTHORIZE ITS RECORDING;
2) WE AGREE TO EXECUTE THE REQUIRED DOCUMENTS CREATING ANY EASEMENT WHICH IS SHOWN HEREON;
3) WE AGREE TO EXECUTE THE REQUIRED DOCUMENTS ABANDONING ANY EXISTING EASEMENT PURSUANT TO THE PROVISIONS OF NRS 278.010 TO 278.630, INCLUSIVE AND SECTIONS 2 AND 3 OF CHAPTER 479 OF THE SIXTY-SIXTH LEGISLATIVE SESSION;
4) ALL PROPERTY TAXES ON THE LAND FOR THE FISCAL YEAR HAVE BEEN PAID;
5) ANY LENDER WITH AN IMPOUND ACCOUNT FOR THE PAYMENT OF TAXES HAS BEEN NOTIFIED OF THE ADJUSTMENT OF THE BOUNDARY LINE OR THE TRANSFER OF THE LAND.

Carlos Iribarren 5-17-02
CARLOS IRIBARREN, TRUSTEE DATE

Isabel R. Iribarren 5-17-02
ISABEL R. IRIBARREN, TRUSTEE DATE

STATE OF NEVADA }
COUNTY OF DOUGLAS } S.S.

ON THIS 17 DAY OF MAY, IN THE YEAR 2002, BEFORE ME, *Peggy A. Elwell* /NOTARY PUBLIC, PERSONALLY APPEARED *Nick Disalvo* (OR PROVED TO ME ON THE BASIS OF SATISFACTORY EVIDENCE) TO BE THE PERSON WHOSE NAME IS SUBSCRIBED TO THIS INSTRUMENT, AND ACKNOWLEDGE THAT THEY EXECUTED IT.

WITNESS MY HAND AND OFFICIAL SEAL.

Peggy A. Elwell
NOTARY'S SIGNATURE
MY COMMISSION EXPIRES: 7/29/05

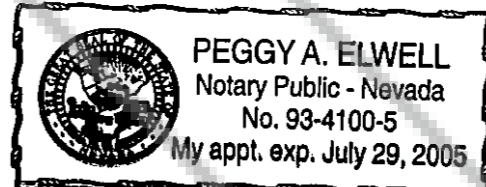

STATE OF NEVADA }
COUNTY OF DOUGLAS } S.S.

ON THIS 17 DAY OF MAY, IN THE YEAR 2002, BEFORE ME, *Linda C. Dick* /NOTARY PUBLIC, PERSONALLY APPEARED *Carlos Iribarren & Isabel R. Iribarren* (OR PROVED TO ME ON THE BASIS OF SATISFACTORY EVIDENCE) TO BE THE PERSONS WHOSE NAMES ARE SUBSCRIBED TO THIS INSTRUMENT, AND ACKNOWLEDGE THAT THEY EXECUTED IT.

WITNESS MY HAND AND OFFICIAL SEAL.

Linda C. Dick
NOTARY'S SIGNATURE
MY COMMISSION EXPIRES: 6-16-02

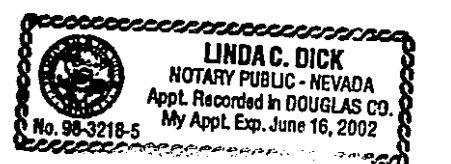

CLERK TREASURER'S CERTIFICATE

ALL PROPERTY TAXES FOR THE PARCELS SHOWN ON THIS MAP HAVE BEEN PAID IN FULL FOR THE FISCAL TAX YEAR 1220-04-002-007 & 1220-05-000-010

Barbara J. Reed 5/20/02
TREASURER DATE
By: *Sony Sanduque*, Chief Deputy Treasurer

COMMUNITY DEVELOPMENT DEPARTMENT CERTIFICATE

IT IS HEREBY CERTIFIED THAT THIS BOUNDARY LINE ADJUSTMENT WAS PRESENTED TO THE DOUGLAS COUNTY COMMUNITY DEVELOPMENT DEPARTMENT AND WAS DULY APPROVED.

Tammy G. Vogt 5-29-02
COMMUNITY DEVELOPMENT DEPARTMENT DATE
TAMMY G. VOGT
APN 1220-04-002-005
DISALVO NICK (NOT A PART)

SURVEYOR'S CERTIFICATE

I, DONALD A. DICK, A PROFESSIONAL LAND SURVEYOR LICENSED IN THE STATE OF NEVADA, HEREBY CERTIFY THAT:
1. A FIELD SURVEY OF THE BOUNDARIES OF THE AFFECTED PARCELS HAS BEEN PERFORMED BY ME OR UNDER MY DIRECT SUPERVISION AT THE INSTANCE OF CARLOS IRIBARREN.
2. THIS PLAT IS A TRUE AND ACCURATE REPRESENTATION OF THE LANDS SURVEYED.
3. ALL CORNERS AND ANGLE POINTS OF THE ADJUSTED PARCEL HAVE BEEN SET AND THE MONUMENTS ARE OF THE CHARACTER SHOWN AND OCCUPY THE POSITIONS INDICATED AND ARE OF SUFFICIENT NUMBER AND DURABILITY TO ENABLE THIS SURVEY TO BE RETRACED.
4. THE LANDS SURVEYED LIE WITHIN THE W 1/2 OF SECTION 4 AND THE E 1/2 OF SECTION 5, T12N, R20E, M.D.B. & M., AND THE SURVEY WAS COMPLETED ON 4-20-02.
5. THIS PLAT IS NOT IN CONFLICT WITH THE PROVISIONS OF NRS 278.010 THROUGH NRS 278.630 AND COMPLIES WITH ALL APPLICABLE STATE STATUTES AND ANY LOCAL ORDINANCES.

Donald A. Dick 5-15-02
DONALD A. DICK DATE
PLS 8659

LINE	LENGTH	BEARING
L1	54.72	S50°37'19"E
L2	30.00	N00°34'43"E
L3	74.54	S50°37'02"E
L4	77.70	S84°38'59"E
L5	27.38	S29°15'41"W
L6	24.57	N02°05'47"E

BASIS OF BEARINGS

THE BEARING OF N00°00'01" WEST ALONG THE EAST LINE OF PARCEL 3-C, AS SHOWN ON DOCUMENT # 248779, WAS USED AS THE BASIS OF BEARINGS FOR THIS MAP.

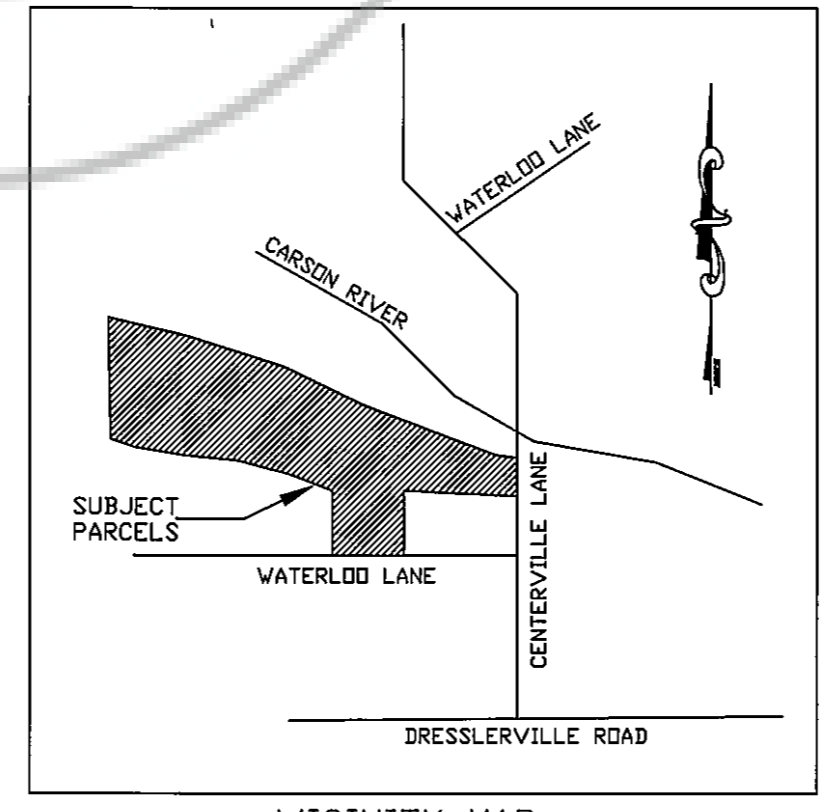
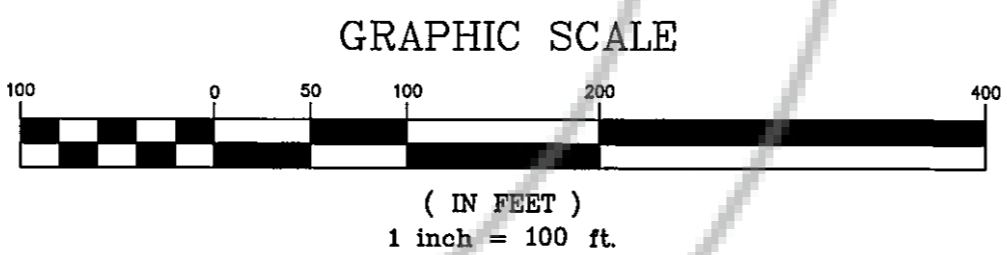

CERTIFICATION OF AMENDMENT
DOC# 667955 BK 0206 PG 4686

RECORDER'S CERTIFICATE

FILED FOR RECORD THIS 10th DAY OF JUNE, 2002, AT 15 MINUTES PAST 3 O'CLOCK P. M. IN BOOK 0602 OF OFFICIAL RECORDS, AT PAGE 2773; DOCUMENT NO. 544262
RECORDED AT THE REQUEST OF CARLOS IRIBARREN.

Barbara Clark, Deputy
DOUGLAS COUNTY RECORDER

Record of Survey
Supporting a Boundary Line Adjustment
FOR
NICK DISALVO AND CARLOS IRIBARREN AND ISABEL R. IRIBARREN FAMILY TRUST
BEING A PORTION OF THE WEST 1/2 OF SECTION 4 AND A PORTION OF THE EAST 1/2 OF SECTION 5 T 12 N, R 20 E, M.D.B. AND M., DOUGLAS COUNTY, NEVADA

G GREAT BASIN SURVEYING & MAPPING
B DONALD A. DICK PLS 8659
S 1005 EAGLE CT.
GARDNERVILLE, NV. 89410 775-265-3069

4+5-12-20
DOC# 544262 NICK DISALVO/IRIBARREN