

A.P.N. 1418-34-211-004

RECORDING REQUESTED BY
CHICAGO TITLE COMPANY

AND WHEN RECORDED MAIL TO

JOHN D. GILLMAN, SR.
200 SUGAR PINE ROAD
ZEPHYR COVE, NV 89448
1336 Shangri La Drive
Daytona Beach, FL 32119

Escrow No. 26028112 - A88
Order No. 26028112 -

86447-99

SPACE ABOVE THIS LINE FOR RECORDER'S USE

GRANT DEED

THE UNDERSIGNED GRANTOR(S) DECLARE(S)

DOCUMENTARY TRANSFER TAX IS \$ #3

unincorporated area City of ZEPHYR COVE

computed on the full value of the interest or property conveyed, or is

computed on the full value less the value of liens or encumbrances remaining at time of sale, and

FOR A VALUABLE CONSIDERATION, receipt of which is hereby acknowledged,
JOHN D. GILMAN, SR. WHO ACQUIRED TITLE AS JOHN D. GILMAN AND FRANCINE H. GILMAN,
HUSBAND AND WIFE AS JOINT TENANTS

hereby GRANT(S) to
JOHN D. GILMAN, SR. AND FRANCINE H. GILMAN, HUSBAND AND WIFE AS JOINT TENANTS

the following described real property in the City of ZEPHYR COVE
County of DOUGLAS, State of NEVADA
LEGAL DESCRIPTION ATTACHED HERETO AS EXHIBIT A

Dated JUNE 24, 2002
~~June 10, 2002~~

STATE OF NEVADA
COUNTY OF WASHOE
On JUNE 24, 2002 before me,
John D. Gilman Sr. Francine H. Gilman
a Notary Public in and for said County and State, personally appeared

John D. Gilman Sr.
JOHN D. GILMAN, SR.
Francine H. Gilman
FRANCINE H. GILMAN

personally known to me (or proved to me on the basis of satisfactory evidence) to be the person(s) whose name(s) is/are subscribed to the within instrument and acknowledged to me that he/she/they executed the same in his/her/their authorized capacity(ies), and that by his/her/their signature(s) on the instrument the person(s), or the entity upon behalf of which the person(s) acted, executed the instrument.

 **JOANNE HICKS**
Notary Public - Nevada
WASHOE COUNTY
My Commission Expires
March 10, 2003
No. 99-3241-2

WITNESS my hand and official seal.
Joanne Hicks
Signature of Notary

MARCH 10 2002
Date My Commission Expires FOR NOTARY SEAL OR STAMP

MAIL TAX STATEMENTS TO PARTY SHOWN ON FOLLOWING LINE: IF NO PARTY SO SHOWN, MAIL AS DIRECTED ABOVE

Name Street Address City, State & Zip

Legal Description

All that real property situate in the County of Douglas, State of Nevada, described as follows:

Lot 59, of LAKERIDGE ESTATES NO. 2, according to the map thereof, filed in the office of the County Recorder of Douglas County, State of Nevada, on June 13, 1957, in Book 1 of Maps, Page 114, as Document No. 12301.

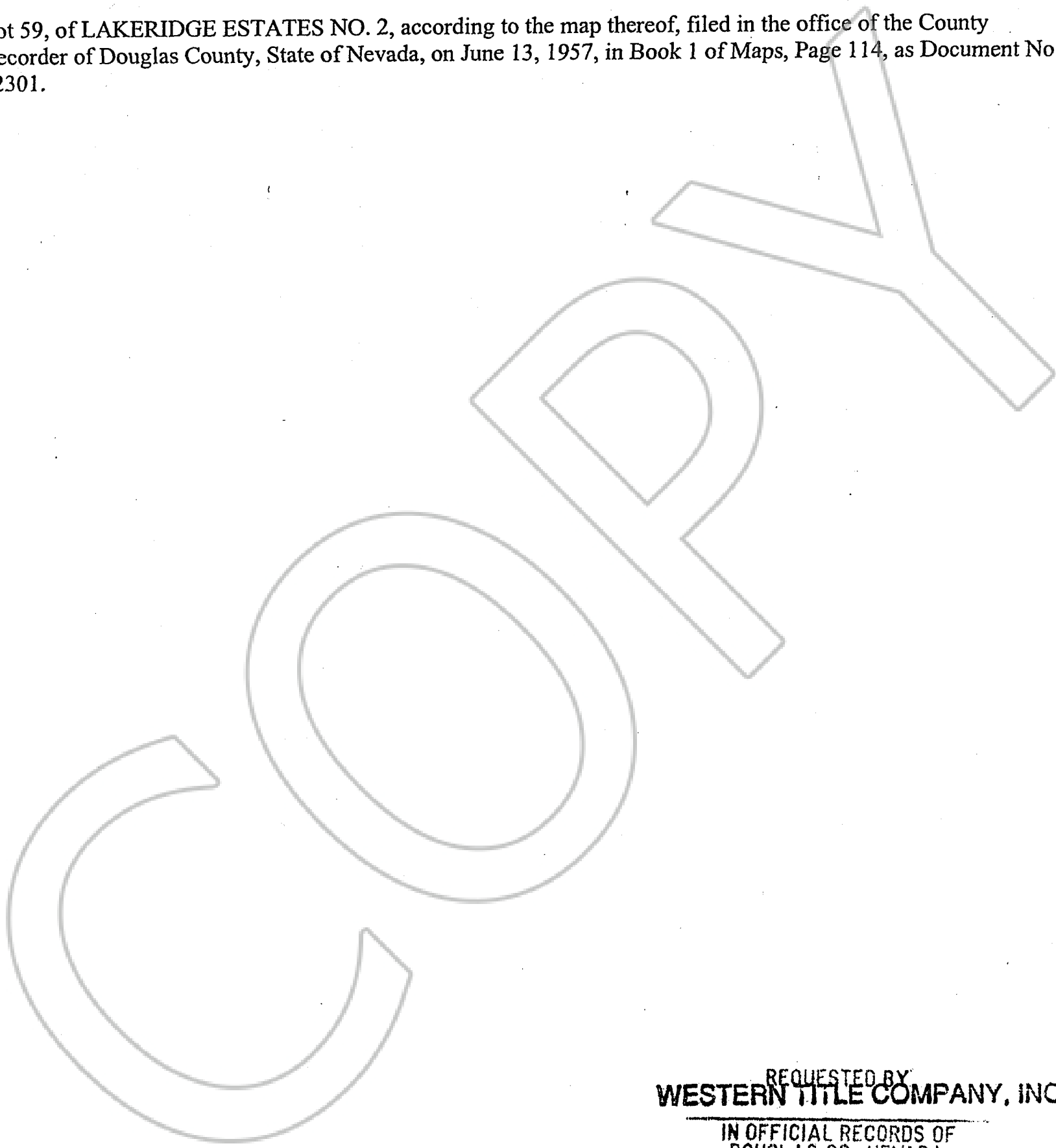

REQUESTED BY
WESTERN TITLE COMPANY, INC.

IN OFFICIAL RECORDS OF
DOUGLAS CO., NEVADA

2002 JUL -2 PM 12: 36

LINDA SLAYER
RECORDER

\$ 15⁰⁰ PAID Kg DEPUTY

0546290

BK 0702 PG 00785