

APN: 1320-30-816-011

DECLARATION OF HOMESTEAD

KNOW ALL MEN BY THESE PRESENTS:

That I **FRANCES M. PRITCHARD** am single and am now actually residing on the land and premises hereinafter described, consisting of the land and dwelling house thereon.

That I intend to use and claim the said property hereinafter described, together with the dwelling house thereon, and it's appurtenances, as a homestead.

That the property and premises herein referred to are situate in the City of _____, County of MINDEN, State of NEVADA, and are described as follows:

SEE ATTACHED EXHIBIT "A" FOR THE COMPLETE LEGAL DESCRIPTION

Property Commonly known as: 1670 BELARRA DRIVE
MINDEN, NV 89423

That I do, by these presents, hereby select and claim the said premises and its appurtenances as a homestead, and that all of the said property is necessary to the use and enjoyment as a homestead.

Dated: July 25, 2002

STATE OF NEVADA

COUNTY OF CARSON CITY

} s.s. *Frances M. Pritchard*
FRANCES M. PRITCHARD

This instrument was acknowledged before me on

July 25, 2002

by FRANCES M. PRITCHARD

K. Howell
Notary Public



(This area for official notarial seal)

SPACE BELOW THIS LINE FOR RECORDER'S USE

**RECORDING REQUESTED BY
Western Title Company, Inc.
AND WHEN RECORDED MAIL TO**

Name FRANCES M. PRITCHARD
Street Address 1670 BELARRA DRIVE
City, State Zip MINDEN, NV 89423

Order No. 00023648-501-KTH

0549352

BK 0802 PG 03503

EXHIBIT A

All that real property situated in the County of Douglas, State of Nevada, described as follows:

Lot 11, as shown on the map of BELARRA SUBDIVISION UNIT 2-A, filed for record in the Office of the County Recorder of Douglas County, State of Nevada, on July 26, 1977, in Book 777, Page 1250, as Document No. 11365.

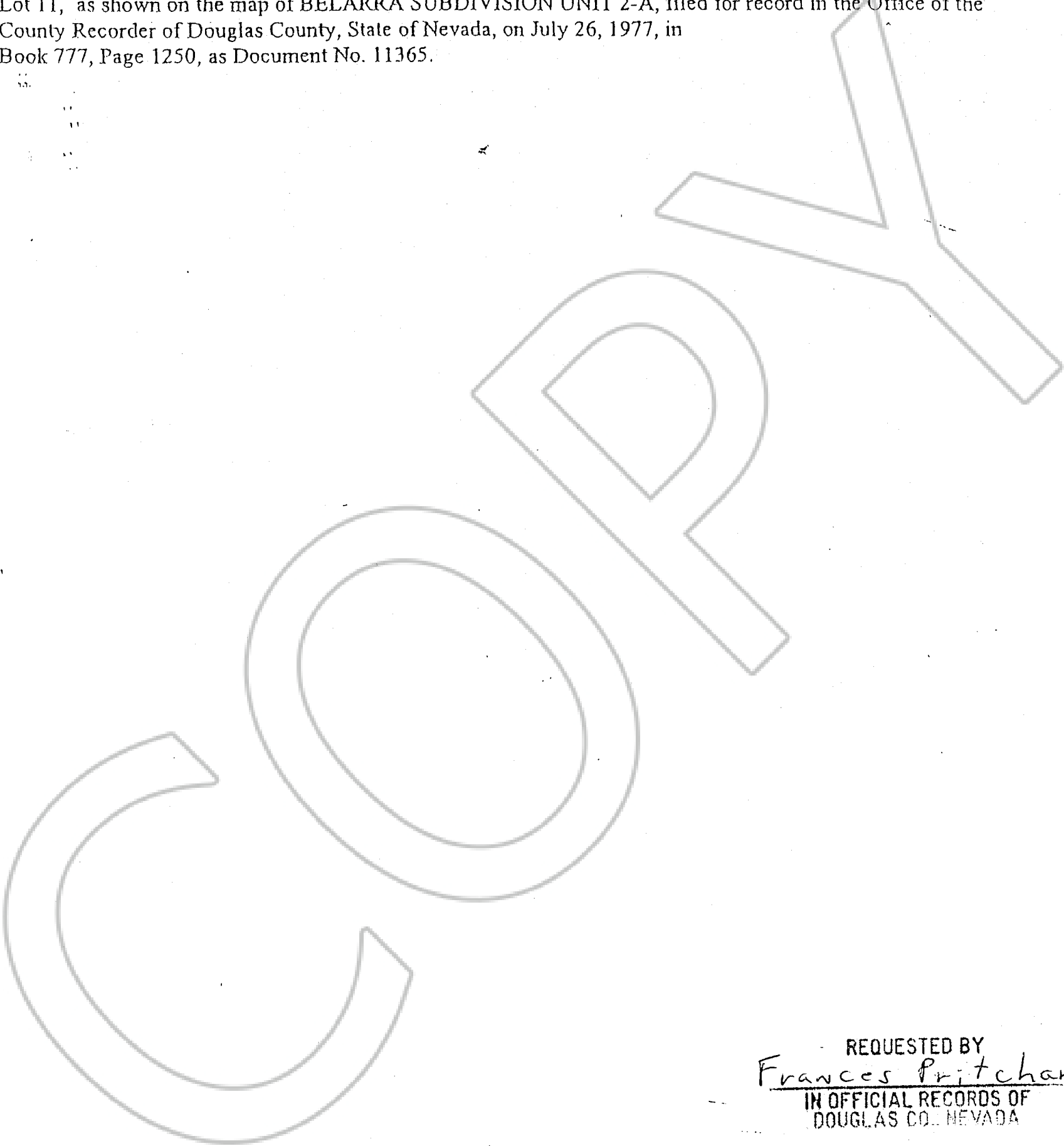

REQUESTED BY
Frances Pritchard
IN OFFICIAL RECORDS OF
DOUGLAS CO. NEVADA

2002 AUG 13 AM 11:44

LINDA SLATER
RECORDER

\$ 15⁰⁰ PAID KJ DEPUTY

0549352

BK0802PG03504