

A.P.N. # 1420-33-701-037

R.P.T.T. \$-0-<sup>#</sup> 3  
ESCROW NO. 020107428

RECORDING REQUESTED BY:  
**STEWART TITLE COMPANY**  
WHEN RECORDED MAIL TO:  
MAIL TAX STATEMENTS TO:  
MR. & MRS. GAPCH  
2658 CLAPHAM LANE  
MINDEN, NV 89423

### GRANT, BARGAIN, SALE DEED

THIS INDENTURE WITNESSETH: That **GARY GAPCH AND ELLONA G. GAPCH, HUSBAND AND WIFE AS JOINT TENANTS**

in consideration of \$10.00, the receipt of which is hereby acknowledged, does hereby Grant, Bargain Sell and Convey to **GARY GAPCH AND ELLONA GAPCH, HUSBAND AND WIFE AS JOINT TENANTS**

and to the heirs and assigns of such Grantee forever, all that real property situated in the County of **DOUGLAS** State of Nevada, bounded and described as follows:

SEE EXHIBIT "A" ATTACHED HERETO AND MADE A PART HEREOF

Together with all and singular the tenements, hereditaments and appurtenances thereunto belonging or in anywise appertaining, and any reversions, remainders, rents, issues or profits thereof.

DATE: **August 21, 2002**

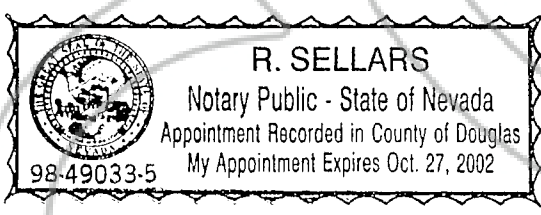

Gary Gapch  
GARY GAPCH

Ellona G. Gapch  
ELLONA G. GAPCH

STATE OF NEVADA }  
COUNTY OF DOUGLAS } ss.

This instrument was acknowledged before me on 8/26/02,  
by, GARY GAPCH AND ELLONA  
G. GAPCH

Signature \_\_\_\_\_  
Notary Public

**0551118**  
**BK0802PG11290**

**EXHIBIT "A"**

**LEGAL DESCRIPTION**

ESCROW NO.: 020107428

A portion of the Southeast 1/4 of Section 33, Township 14 North, Range 20 East, M.D.B.&M., more particularly described as follows:

Parcel E on that certain Parcel Map for HAROLD R. CLAPHAM, filed in the office of the County Recorder of Douglas County, State of Nevada, on February 3, 1976, in Book 276, at Page 75, as Document No. 87065, of Official Records.

ASSESSOR'S PARCEL NO. 1420-33-701-037

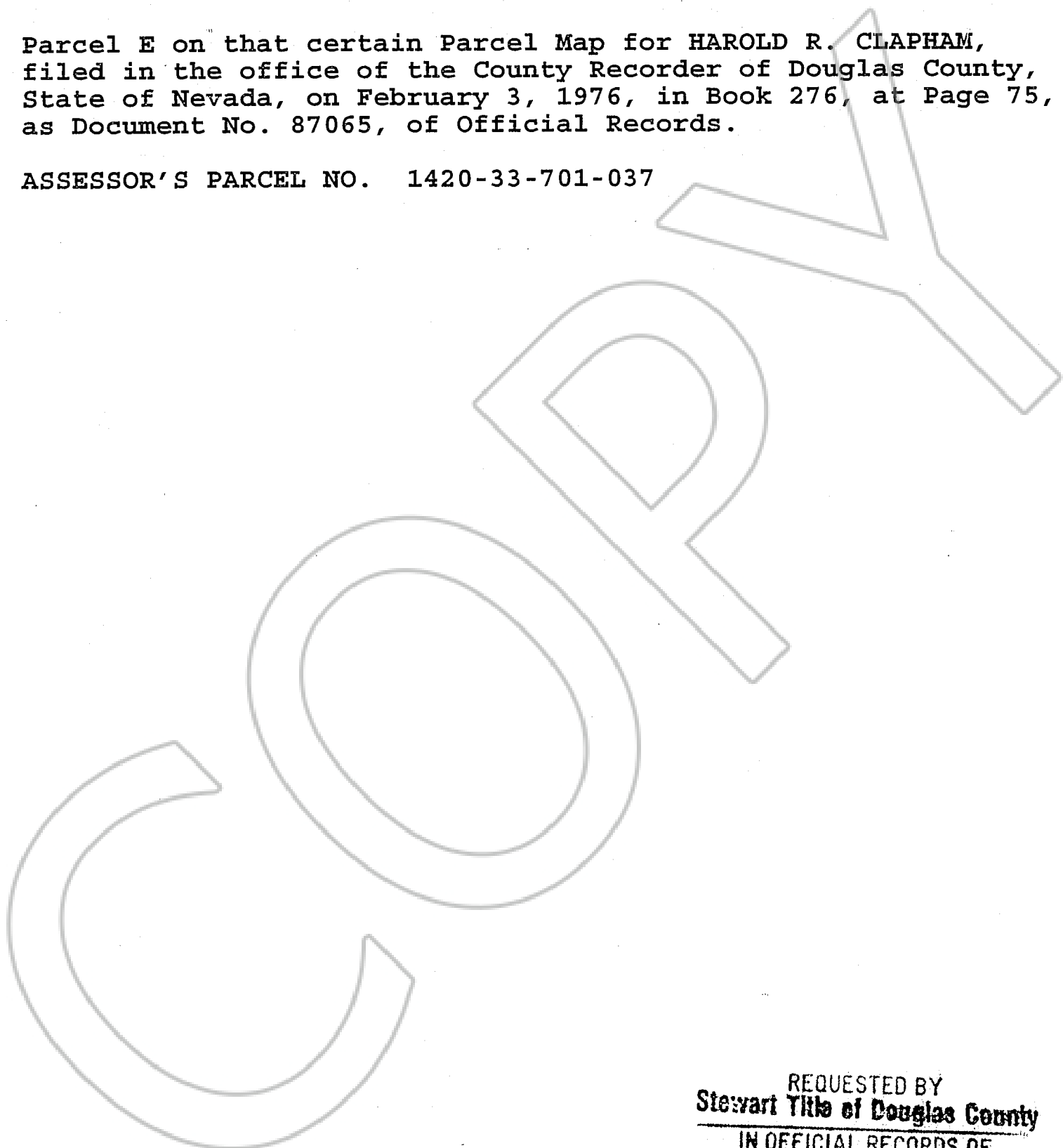

REQUESTED BY  
**Stewart Title of Douglas County**  
IN OFFICIAL RECORDS OF  
DOUGLAS CO., NEVADA

2002 AUG 30 PM 12: 52

LINDA SLATER  
RECORDER

0551118

\$ 15<sup>00</sup> PAID *AS* DEPUTY

BK 0802 PG 11291