

A.P.N. # 1220-24-501-043

RECORDING REQUESTED BY:  
**STEWART TITLE COMPANY**

WHEN RECORDED MAIL TO:

MAIL TAX STATEMENTS TO:

R.P.T.T. \$ EX #3  
ESCROW NO. 02051503  
Full Value

✓ **JEFF DINSMORE**  
**1964 HACKAMORE**  
**GARDNERVILLE, NV 89410**

*Lot Line* **ADJUSTMENT**

**GRANT, BARGAIN, SALE DEED**

THIS INDENTURE WITNESSETH: That **JEFF DINSMORE**

*A single Man*

in consideration of \$10.00, the receipt of which is hereby acknowledged, does hereby Grant, Bargain Sell and Convey to **JEFF DINSMORE \* \* \* \*** *A Single Man*

and to the heirs and assigns of such Grantee forever, all that real property situated in the **City of**  
**County of DOUGLAS COUNTY** State of Nevada, bounded and described as follows:  
**SEE EXHIBIT "A" ATTACHED HERETO AND MADE A PART HEREOF**

Together with all and singular the tenements, hereditaments and appurtenances thereunto belonging or in anywise appertaining, and any reversions, remainders, rents, issues or profits thereof.

DATE: **June 20, 2002**

*Jeff Dinsmore*  
\_\_\_\_\_  
**JEFF DINSMORE**

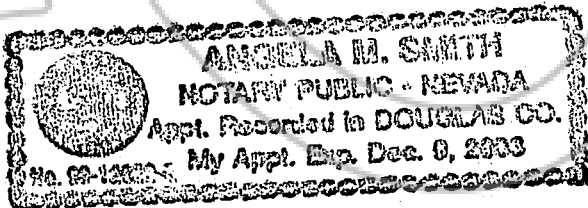

STATE OF NV }  
COUNTY OF Douglas } ss.

This instrument was acknowledged before me on 7-1-02,  
by, **JEFF DINSMORE**

\_\_\_\_\_  
Signature *Angela M. Smith*  
Notary Public

**0551475**  
**BK0902PG1070**

**LEGAL DESCRIPTION  
(New Parcel 2B)**

That portion of the Northeast ¼ of the Northeast ¼ of Section 24, Township 12 North, Range 20 East, M.D.B. & M. in the County of Douglas, State of Nevada, being more particularly described as follows:

Beginning at the Northeasterly corner of Parcel 2 as said parcel is described in Grant, Bargain and Sale Deed, recorded in Book 787 at Pages 787 through 793 as Document No. 158058 of the Official Records of said Douglas County, said corner being on the Southerly right-of-way line of Pinto Circle; thence Westerly along said right-of-way line S. 89° 59' 09" W., 159.88 feet; thence S. 0° 00' 52" E., 305.19 feet to a point on the Southerly line of said Parcel 2; thence Easterly along said Southerly line N. 89° 58' 22" E., 159.88 feet to the Southeasterly corner of said Parcel 2; thence Northerly along the Easterly line of said Parcel 2, N. 0° 00' 52" W., 305.16 feet to the Point of Beginning.

Said Parcel Contains 1.120 Acres, more or less.

Per NRS 111.312, this legal description was prepared by Western Engineering & Surveying Services, whose mailing address is 3032 Silver Sage Drive, Carson City, Nevada 89701.

By: David D. Winchell  
David D. Winchell, PLS 3209

Dated: 5/29/2002

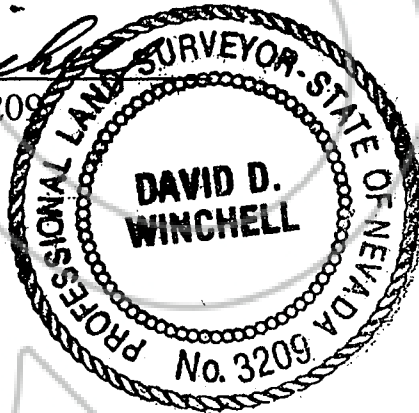

REQUESTED BY  
Western Engineering  
IN OFFICIAL RECORDS OF  
DOUGLAS CO., NEVADA

2002 SEP -5 PM 2: 25

LINDA SLATER  
RECORDER

\$15<sup>00</sup> PAID Ph DEPUTY

0551475

BK0902PG1071