

16-
APN: 1120-06-000-006

RPTT \$ # 3

GRANT, BARGAIN AND SALE DEED

THIS INDENTURE WITNESSETH: That

FOR A VALUABLE CONSIDERATION, receipt of which is hereby acknowledged,
KENT R. NEDDENRIEP AND MARIE C. JOHNSON-NEDDENRIEP, HUSBAND AND WIFE AS JOINT TENANTS

do(es) hereby GRANT(s) BARGAIN SELL and CONVEY to

KENT R. NEDDENRIEP AND MARIE C. JOHNSON-NEDDENRIEP, HUSBAND AND WIFE AS JOINT TENANTS

and to the heirs and assigns of such Grantee forever, all the following real property situated in the county of Douglas,
state of Nevada bounded and described as follows:

FOR A COMPLETE LEGAL DESCRIPTION, SEE ATTACHED LEGAL DESCRIPTION

TOGETHER with all tenements, hereditaments and appurtenances, if any, thereto belonging or appertaining, and any
reversions, remainders, rents, issues or profits thereof.

Dated: SEPTEMBER 5, 2002

STATE OF NEVADA

COUNTY OF Douglas

} ss. *Kent R. Neddenriep*
KENT R. NEDDENRIEP

This instrument was acknowledged before me on

September 6th 2002

Marie C. Johnson-Neddenriep
MARIE C. JOHNSON-NEDDENRIEP

by Kent R. Neddenriep and Marie C. Johnson-Neddenriep

Kristy Nuzum
Notary Public

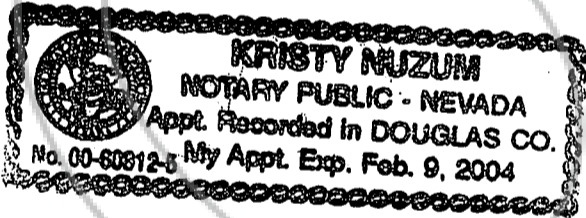

(This area for official notarial seal)

SPACE BELOW THIS LINE FOR RECORDER'S USE

Name
Street
Address
**WHEN RECORDED MAIL TO:
KENT R. NEDDENRIEP AND
MARIE C. JOHNSON-NEDDENRIEP**

City, State
Zip

MAIL TAX STATEMENTS TO:

Name
Street
Address

City, State
Zip

Order No. 86811-KRT

0551574

BK0902PG1619

**DESCRIPTION
ADJUSTED PARCEL 1
(A.P.N. 1120-06-000-006)**

All that real property situate in the County of Douglas, State of Nevada described as follows:

A parcel of land located within a portion of the Northeast one-quarter (NE $\frac{1}{4}$) of Section 6, Township 11 North, Range 20 East and a portion of the Southeast one-quarter (SE $\frac{1}{4}$) of Section 31, Township 12 North, Range 20 East, Mount Diablo Meridian, more particularly described as follows:

Commencing at the northeast corner of said Section 6, a U.S.G.L.O. brass cap, stamped 1939, as shown on the Record of Survey for Wilton H. Neddenriep recorded December 20, 1988 in the office of Recorder, Douglas County, Nevada in Book 1288, at Page 2695, as Document No. 192958, the POINT OF BEGINNING;

thence along the easterly line of said Northeast one-quarter of Section 6, South 00°02'30" East, 2606.25 feet to the east one-quarter corner of said Section 6, a U.S.G.L.O. brass cap, stamped AP1 AP2;

thence along the southerly line of Parcel 4 as shown on the Map of Division into Large Parcels for Kent R. Neddenriep and Marie C. Johnson-Neddenriep recorded June 18, 1996 in said office of Recorder, in Book 696, at Page 2033, as Document No. 389886, North 54°28'04" West, 597.06 feet;

thence North 12°28'23" East, 1020.70 feet;

thence North 08°34'45" West, 421.72 feet;

thence South 84°11'01" West, 594.07 feet;

thence South 46°54'11" West, 591.65 feet;

thence South 00°23'41" West, 279.47 feet;

thence North 89°00'51" West, 1139.61 feet;

thence North 00°59'09" East, 50.00 feet;

thence North 89°00'51" West, 100.00 feet to a point on the easterly line of State Route 88;

thence along said easterly line of State Route 88 as shown on the Record of Survey to Support a Boundary Line Adjustment for Kent R. Neddenriep and Marie C. Johnson-Neddenriep recorded December 22, 1995 in said office of Recorder in Book 1295, at Page 3464, as Document No. 377377 and said Map of Division into Large Parcels, Document No. 389886, North 00°03'21" West, 291.00 feet;

thence South 89°00'51" East, 962.48 feet;

thence North 33°18'50" East, 513.18 feet;

thence North 00°23'41" East, 305.93 feet;

thence North 89°56'39" East, 525.90 feet;

thence North 00°03'21" West, 509.02 feet;

thence North 89°57'53" West, 716.11 feet;

thence North 00°04'00" East, 799.22 feet;

thence along the southerly line of Adjusted A.P.N. 31-020-15 as shown on said Record of Survey, Document No. 377377, South 89°56'00" East, 875.81 feet;

0551574

thence along the easterly boundary of said Adjusted A.P.N. 31-020-15, North 00°15'50" East, 200.00 feet;
thence continuing along said easterly boundary, North 89°56'00" West, 52.37 feet;
thence continuing along said easterly boundary, North 21°04'44" West, 257.33 feet;
thence South 89°56'00" East, 804.35 feet;
thence along the easterly line of said Southeast one-quarter of Section 31, South 00°06'44" West, 1238.39 feet to the POINT OF BEGINNING, containing 82.64 acres, more or less.

The Basis of Bearing of this description is South 89°56'00" East, the south line of Parcel 11-C2 as shown on Parcel Map LDA 01-060 for Mark W. Neddenriep recorded November 27, 2001 in Book 1101, at Page 7992, as Document No. 528513.

Note: Refer this description to your title company before incorporating into any legal document.

Prepared By: R.O. ANDERSON ENGINEERING, INC.
P.O. Box 2229
Minden, Nevada 89423

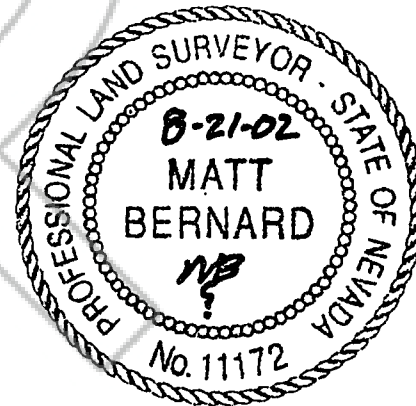

REQUESTED BY
Kent R. Neddenriep
IN OFFICIAL RECORDS OF
DOUGLAS CO., NEVADA

2002 SEP -6 PM 1:58

LINDA SLATER
RECORDER

\$ 16.00 PAID *AL* DEPUTY

0551574

BK0902PG1621