

A.P.N. # apn 1219-22-001-0087

R.P.T.T. \$ 0 FB
ESCROW NO. 020707756
Full Value

RECORDING REQUESTED BY:
STEWART TITLE COMPANY
WHEN RECORDED MAIL TO:
MAIL TAX STATEMENTS TO:

GRANTEE
212 CALLE PORTRANCA
SAN CLEMENTE, CA. 92672

EASEMENT DEED

THIS INDENTURE WITNESSETH: That
FIVE CREEK LIMITED LIABILITY COMPANY, a Nevada Limited Liability Company

in consideration of \$10.00, the receipt of which is hereby acknowledged, does hereby Grant, Bargain Sell and Convey to
PHILIP B. POTTER, TRUSTEE and LORRAINE S. POTTER, TRUSTEE OF THE POTTER FAMILY TRUST DATED JANUARY 20, 2000

and to the heirs and assigns of such Grantee forever, all that real property situated in the **unincorporated area**
County of **DOUGLAS** State of Nevada, bounded and described as follows:
SEE EXHIBIT "A" ATTACHED HERETO AND MADE A PART HEREOF
SEE EXHIBIT "B" ATTACHED GRAPHIC SCALE AND MADE A PART HEREOF

Together with all and singular the tenements, hereditaments and appurtenances thereunto belonging or in anywise appertaining, and any reversions, remainders, rents, issues or profits thereof.

DATE: **September 13, 2002** **FIVE CREEK LIMITED LIABILITY COMPANY, a Nevada limited liability company**

BY: *Cole S. Smith*
COLE S. SMITH
MANAGER

BY: _____

STATE OF Nevada }
COUNTY OF DOUGLAS } ss.



This instrument was acknowledged before me on Sept. 13, 2002,
by, COLE S. SMITH

Signature *Laurel S. Ballou*
Notary Public

0552642

BK0902PG06738

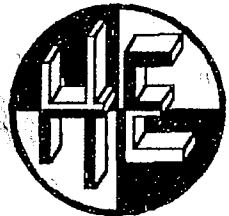

HADDAN ENGINEERING, INC.

CIVIL ENGINEERING, SURVEYING & CONSULTING

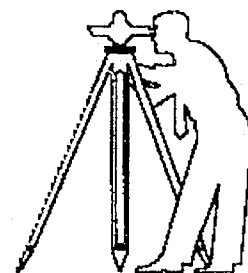

EASEMENT ACROSS LOT 303 FOR THE BENEFIT OF LOT 304, JOB'S PEAK RANCH, DOUGLAS COUNTY, NEVADA

DESCRIPTION OF AN ACCESS EASEMENT ACROSS LOT 303 OF JOB'S PEAK RANCH UNIT NO. 3, A PLANNED UNIT DEVELOPMENT, WITHIN PORTIONS OF SECTIONS 15, 21, 23 AND 23, T.12N., R.19E., M.D.B.& M., DOUGLAS COUNTY, NEVADA, MORE PARTICULARLY DESCRIBED AS FOLLOWS:

COMMENCING AT THE SOUTHEAST CORNER OF SAID LOT 303, SAID POINT BEING THE **TRUE POINT OF BEGINNING**; THENCE S. 71° 40' 58" W., 33.74 FEET; THENCE N. 08° 55' 46" E., 113.23 FEET; THENCE ON A CURVE TO THE LEFT WITH RADIUS OF 495.00 FEET, CENTRAL ANGLE OF 08° 45' 04" AND ARC LENGTH OF 75.60 FEET; THENCE S. 89° 49' 18" E., 30.00 FEET; THENCE ON A CURVE TO THE RIGHT WITH RADIUS OF 525.00 FEET, CENTRAL ANGLE OF 08° 45' 04" AND ARC LENGTH OF 80.19 FEET; THENCE S. 08° 55' 46" W., 97.78 FEET TO THE **TRUE POINT OF BEGINNING**, AS SHOWN ON THE ATTACHED EXHIBIT "A", WHICH IS MADE A PART HEREOF.

B

CONTAINING 5,501 SQUARE FEET MORE OR LESS.

BASIS OF BEARINGS: CENTERLINE OF FIVE CREEK ROAD, PER OFFICIAL PLAT OF JOB'S PEAK RANCH - UNIT 3, A PLANNED UNIT DEVELOPMENT FINAL SUBDIVISION MAP #2014-3, LOCATED WITHIN PORTIONS OF SECTIONS 15, 21, 22 AND 23, T.12N., R.19E., M.D.B.& M., DOUGLAS COUNTY, NEVADA. (S. 02° 45' 31" E.)

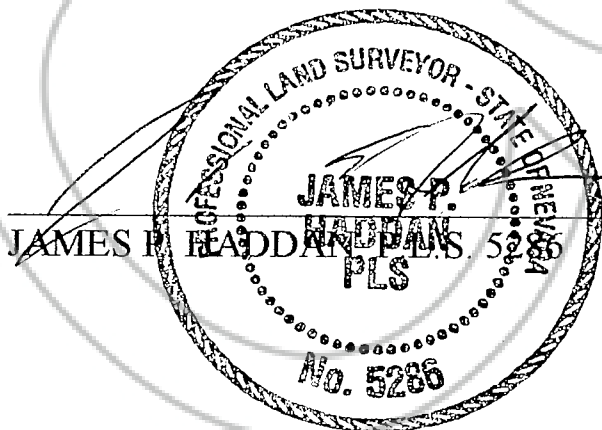

DATE

LEGEND:

● - FOUND AS INDICATED

— CENTERLINE

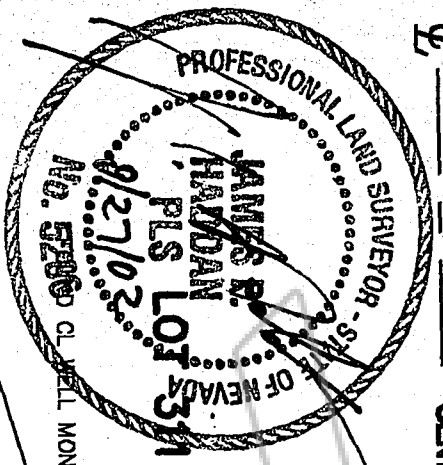

GRAPHIC SCALE



FOREST HILL WAY

FIVE CREEK ROAD

BASIS OF BEARINGS:

S02°45'31"E 311.38

⤴

FOUND CL WELL MONUMENT

FOUND 5/8 REBAR AND CAP PLS 3318

LOT 302

LOT 303

LOT 304

EXHIBIT "B"

EXHIBIT "A"

BASIS OF BEARINGS:

CENTER LINE OF FIVE CREEK ROAD PER OFFICIAL PLAT OF JOB'S PEAK RANCH - UNIT 3 A PLANNED UNIT DEVELOPMENT FINAL SUBDIVISION MAP #2014-3 LOCATED WITHIN PROVISIONS OF SECTIONS 15, 21, 22, AND 23, T12N, R19E, MDB, 4M DOUGLAS COUNTY, NEVADA (9024531E)

REFERENCE DOCUMENT

1 OFFICIAL PLAT OF JOB'S PEAK RANCH - UNIT 3 A PLANNED UNIT DEVELOPMENT FINAL SUBDIVISION MAP #2014-3 LOCATED WITHIN PROVISIONS OF SECTIONS 15, 21, 22, AND 23, T12N, R19E, MDB, 4M DOUGLAS COUNTY, NEVADA

MAP TO SUPPORT A LEGAL DESCRIPTION OF A 30' ACCESS EASEMENT ACROSS LOT 303 FOR THE BENEFIT OF LOT 304 JOB'S PEAK RANCH PHASE 3 FOR

FIVE CREEK LLC

DOUGLAS COUNTY NEVADA

HADDAN ENGINEERING, INC.

CIVIL ENGINEERING, SURVEYING & CONSULTING
206 S Minnesota Street
Carson City, Nevada 89703

DRAWN BY: PDB DATE: 08/26/02 DRAWING NO.: 2097BS1

0552642
BK 0902 PG 06740

COPY

Stewart Title of Douglas County

OFFICIAL RECORDS OF
DOUGLAS CO., NEVADA

2002 SEP 20 PM 3: 21

LINDA SLATER, RECORDER

BY BC M⁰⁰pl

0552642

BK0902PG06741