

WHEN RECORDED RETURN TO:

FIDELITY NATIONAL LPS

P.O. BOX 19523

IRVINE, CA 92623-9523

CLIENT: CALMCO LPS: 706813

LN: 1601262010 BIN: a-a-orig

INVESTOR: 443

VICES, LLC

This Instrument Prepared by: LESLEY HACKETT  
FIRST NLC FINANCIAL SERVICES, LLC  
700 W HILLSBORO BLVD, B1 #204  
DEERFIELD BEACH, FL 33441

Property Appraisers Parcel I.D.(Folio) Number(s):  
--- Space Above And Next To This Line For Recording Data ---

**ASSIGNMENT OF DEED OF TRUST FROM CORPORATION**

KNOW ALL MEN BY THESE PRESENTS:

That FIRST NLC FINANCIAL SERVICES, LLC AND/OR ITS ASSIGNS  
700 W HILLSBORO BLVD, B1 #204 DEERFIELD BEACH, FL 33441

a corporation existing under the laws of the State of Florida.

party of the first part, in consideration of the sum of \*\*\*\*\* TEN AND NO/CENTS \*\*\*\*\*

\*\*\*\*\* \$10.00 \*\*\*\*\* Dollars,

and other valuable consideration, received from or on behalf of

U.S. Bank N.A., not in its individual capacity, but as  
Trustee for the Certificate Holders of the CSFB  
Mortgage-Backed Pass-Through Certificates, Series 2002-HE11 2220 Chemsearch, Suite 150, Irving, TX 75062

party of the second part at or before the ensembling and delivery of these presents, the receipt whereof is hereby acknowledged,  
does hereby grant, bargain, sell, assign, transfer and set over unto the said part of the second part a certain Deed of Trust bearing  
date the 7 day of December A.D., 2001 made by

JOHN M. MERINO AND LE ANN MERINO, HUSBAND AND WIFE, AS JOINT TENANTS

in favor of the beneficiary named FIRST NLC FINANCIAL SERVICES, LLC  
and recorded in Official Records Liber \_\_\_\_\_, public records of DOUGLAS County, NEVADA upon the  
following described piece or parcel of land, situate and being in said County and State, to-wit:

SEE ATTACHED SCHEDULE "A"

RECORDED ON: 11.30.2001 INST. 529001 BK: 1101 PG: 10084

A.P.N. 1320-32-114-011

Together with the note or obligation described in said Deed of Trust, and the monies due and to become due thereon, with interest  
from the \_\_\_\_\_ day of \_\_\_\_\_ A.D., \_\_\_\_\_

To Have and To Hold the same unto the said party of the second part, heirs,  
legal representatives, successors and assigns forever.

SEAL

In Witness Whereof the party of the first part has caused these presents to be  
executed in its name, and its corporate seal to be hereunto affixed, by its proper  
officers thereunto duly authorized, the 7 day of December A.D. 01

ATTEST: \_\_\_\_\_  
EMILIA ARILLO, ASSISTANT SECRETARY

\_\_\_\_\_  
FIRST NLC FINANCIAL SERVICES, LLC

Signed, sealed and delivered in presence of:

by: \_\_\_\_\_  
LESLEY HACKETT, SR VICE PRESIDENT

STATE OF FLORIDA,  
COUNTY OF BROWARD

I HEREBY CERTIFY that on this day, before me, an officer duly authorized in the State aforesaid and in the County aforesaid, to take  
acknowledgments, personally appeared LESLEY HACKETT and EMILIA ARILLO personally known to me to be the SR VICE  
PRESIDENT and ASSISTANT SECRETARY respectively of the corporation named as party of the first part in the foregoing instrument  
that they severally acknowledge executing the same freely and voluntarily under authority duly vested in them by said corporation and th  
the seal affixed thereto is the true corporate seal of said corporation.

WITNESS my hand and official seal in the County and State last aforesaid this 7 day of December A.D., 01

\_\_\_\_\_  
JOYCE E. MANCINI (Notary Public)

NV nv885 15003921 MERINO

0553040

JOYCE E. MANCINI  
My Commission CC844833  
Expires June 9, 2003

BK0902PG08883

Legal Description

All that real property situate in the County of Douglas, State of Nevada, described as follows:

PARCEL 1

Lot 7, in Block B of the South Addition to the Town of Minden, Douglas County, State of Nevada, according to the Official Map thereof, filed in the Office of the Douglas County, Nevada, on April 9, 1957, as Document No. 12130.

PARCEL 2

All that portion of Lot 6, in Block B, as shown on the map of South Addition to the Town of Minden, filed for record in the office of the County Recorder of Douglas County, State of Nevada, on April 9, 1957, as Document No. 12130, more particularly described as follows:

COMMENCING at the most Easterly corner of said Lot 6, above referenced thence from the point of commencement, along the Southeasterly line thereof, South 26°35' West a distance of 110.00 feet to the most Southerly corner of said lot, thence along the Southwesterly line of said lot, North 63°25' West a distance of 15.00 feet; thence leaving said Southwesterly line of said lot North 26°35' East, 110.00 feet to a point on the Northeasterly line of said lot; thence along said Northeasterly line South 63°25' East, a distance of 15.00 feet to the True Point of Beginning.

A.P.N.: 1320-32-114-011

NOTE (NRS 111.312): The above metes and bounds description appeared previously in that certain Grant Deed, recorded in the office of the County Recorder of Douglas County, Nevada on June 7, 2000, in Book 0600, Page 1447, as Document No. 0493593, of Official Records.

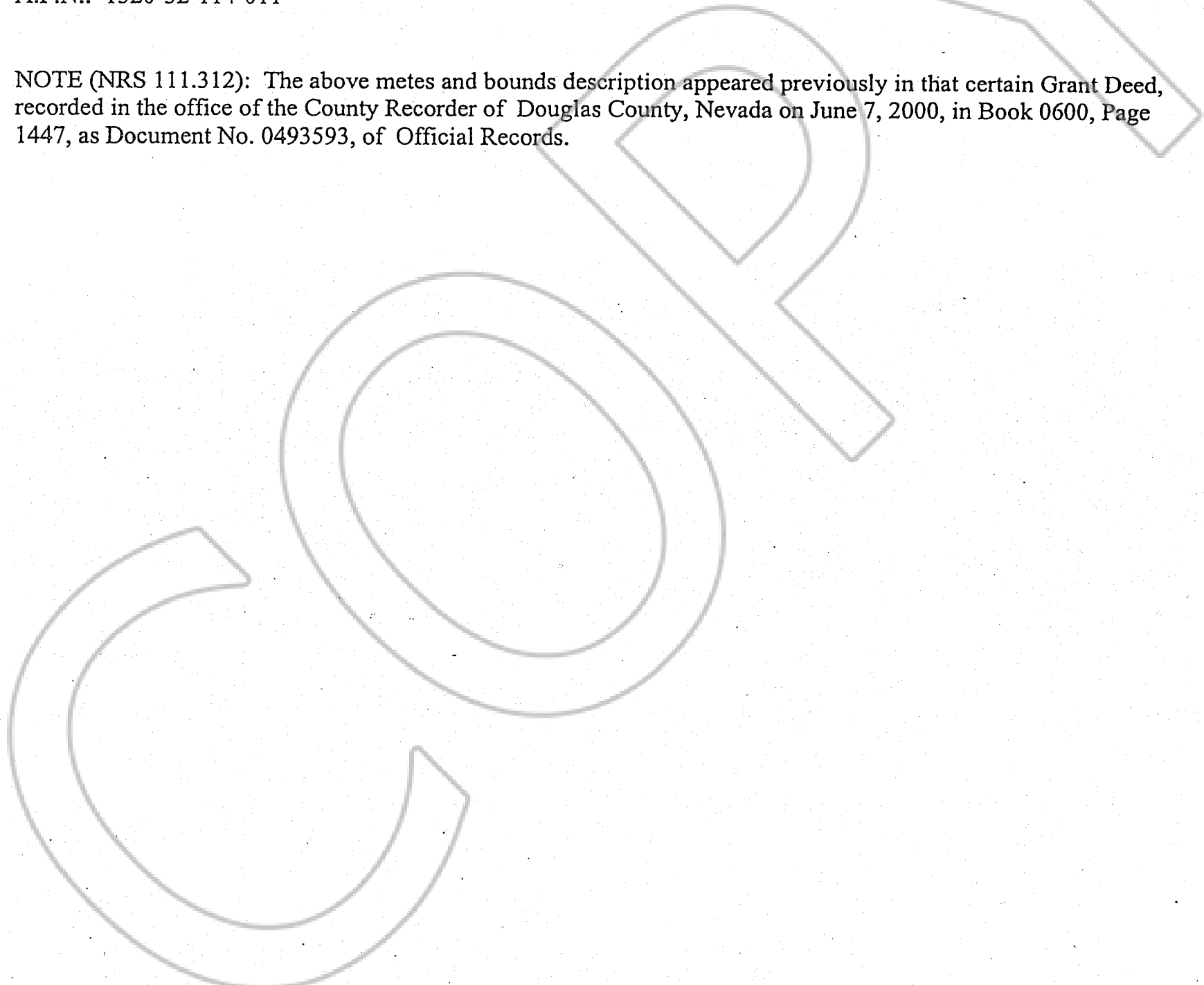

REQUESTED BY  
*Fidelity National*  
IN OFFICIAL RECORDS OF  
DOUGLAS CO., NEVADA

2002 SEP 26 AM 10:11

LINDA SLATER  
RECORDER

\$15<sup>00</sup> PAID *[Signature]* DEPUTY

0553040

BK 0902 PG 08884