

SCALE: 1"=60'

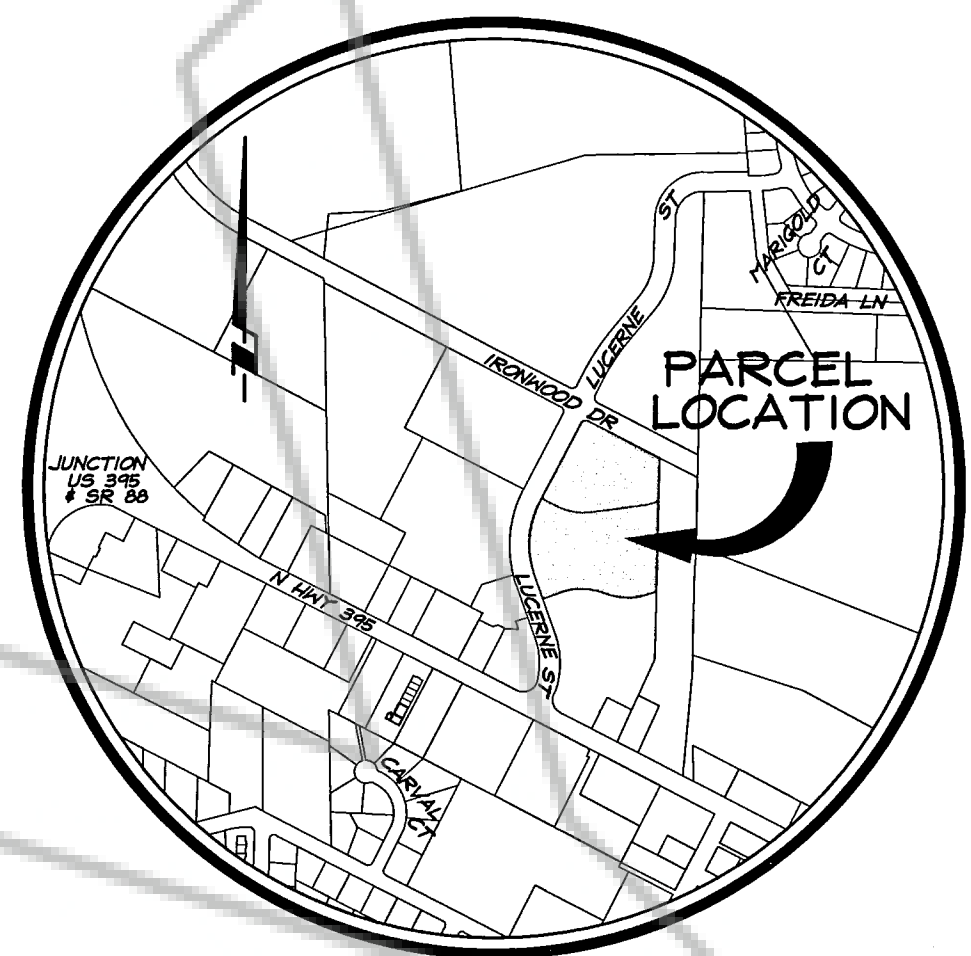

LEGEND

- ▲ SET 5/8" REBAR W/ CAP PLS 6899
- FOUND 5/8" REBAR & CAP, PLS 3209, OR AS NOTED, PER (R1)
- FOUND 5/8" REBAR & CAP, PLS 3579, OR AS NOTED, PER (R1)
- ⊙ FOUND CENTERLINE MONUMENT IN WELL
- FOUND AS NOTED
- ⊥ NOTHING FOUND OR SET
- RAD. BRG. RADIAL BEARING
- (R1) RECORD OF SURVEY IN SUPPORT OF A BOUNDARY LINE ADJUSTMENT, FILED FOR RECORD APRIL 22, 1997, IN BOOK 497, AT PAGE 3362, DOCUMENT NO. 411078, OFFICIAL RECORDS OF DOUGLAS COUNTY, NEVADA.
- (R2) CERTIFICATE OF AMENDMENT, FILED FOR RECORD OCTOBER 24, 1997, IN BOOK 1097, AT PAGE 4501, DOCUMENT NO. 424658 OFFICIAL RECORDS OF DOUGLAS COUNTY, NEVADA.
- (R3) DEED OF PUBLIC EASEMENT, FILED FOR RECORD JULY 9, 1986, IN BOOK 786, AT PAGES 684, DOCUMENT NO. 137311, OFFICIAL RECORDS OF DOUGLAS COUNTY, NEVADA.
- (R4) PARCEL MAP FOR WESTERN NEVADA PROPERTIES INC., FILED FOR RECORD JUNE 5, 1990, IN BOOK 690, AT PAGE 524, DOCUMENT NO. 227471, OFFICIAL RECORDS OF DOUGLAS COUNTY, NEVADA.

BASIS OF BEARING

N26°35'00"E. THE BEARING OF THE EASTERLY RIGHT-OF-WAY LINE OF LUCERNE STREET, AS SHOWN ON (R1) AND AS MEASURED BETWEEN FOUND MONUMENTS.

COMMUNITY DEVELOPMENT DEPARTMENT CERTIFICATE

IT IS HEREBY CERTIFIED THAT THIS BOUNDARY LINE ADJUSTMENT WAS PRESENTED TO THE DOUGLAS COUNTY COMMUNITY DEVELOPMENT DEPARTMENT AND WAS DULY APPROVED.

Sammy J. Valer 10/01/02
DATE
COMMUNITY DEVELOPMENT DEPARTMENT

CLERK TREASURER'S CERTIFICATE

ALL PROPERTY TAXES FOR THE PARCELS SHOWN ON THIS MAP HAVE BEEN PAID IN FULL FOR THE FISCAL TAX YEAR. (A.P.N.'s 1320-30-703-001 AND 1320-30-703-002)

Barbara Q. Reed 10/12/02
TREASURER
By: *Jerry Anderson*, Chief Deputy Treasurer

NOTES

TOTAL AREA: 6.32 ACRES

THIS RECORD OF SURVEY IS TO SUPPORT THAT CERTAIN DEED RECORDED IN OFFICIAL RECORDS OF DOUGLAS COUNTY, NEVADA IN BOOK 1002, AT PAGE 739, AS DOCUMENT NO. 553427 AND IN BOOK _____, AT PAGE _____, AS DOCUMENT NO. _____

OWNER'S CERTIFICATE

WE, THE UNDERSIGNED OWNERS OF THE AFFECTED PARCELS AS SHOWN ON THIS MAP, DO HEREBY STATE THAT:

- 1) WE HAVE EXAMINED THIS PLAT AND APPROVE AND AUTHORIZE ITS RECORDING;
- 2) WE AGREE TO EXECUTE THE REQUIRED DOCUMENTS CREATING ANY EASEMENT WHICH IS SHOWN HEREON;
- 3) WE AGREE TO EXECUTE THE REQUIRED DOCUMENTS ABANDONING ANY EXISTING EASEMENTS PURSUANT TO THE PROVISIONS OF NRS 278.010 TO 278.630;
- 4) ALL PROPERTY TAXES ON THE LAND FOR THE FISCAL YEAR HAVE BEEN PAID;
- 5) ANY LENDER WITH AN IMPOUND ACCOUNT FOR THE PAYMENT OF TAXES HAS BEEN NOTIFIED OF THE ADJUSTMENT OF THE BOUNDARY LINE FOR THE TRANSFER OF LAND.

Leo A. Hanly
LEO A. HANLY, PRESIDENT
WESTERN NEVADA PROPERTIES, INC.,
a Nevada corporation
REVISED A.P.N.'s 1320-30-703-001 AND 1320-30-703-002

STATE OF NEVADA ss:
COUNTY OF DOUGLAS

ON THIS 26th DAY OF September, IN THE YEAR 2002
BEFORE ME, A NOTARY PUBLIC, PERSONALLY APPEARED LEO A. HANLY, PERSONALLY KNOWN BY ME TO BE THE PERSON WHOSE NAME IS SUBSCRIBED TO THE ABOVE INSTRUMENT WHO ACKNOWLEDGED THAT HE EXECUTED THE SAME IN HIS AUTHORIZED CAPACITY AND THAT BY HIS SIGNATURE ON THE INSTRUMENT, THE PERSONS, OR THE ENTITY ON BEHALF OF WHICH THE PERSONS ACTED, EXECUTED THE INSTRUMENT.

WITNESS MY HAND AND OFFICIAL SEAL
NOTARY'S SIGNATURE *Donna Sue Hawkins*

MY COMMISSION EXPIRES: 6/1/05



SURVEYOR'S CERTIFICATE

I, THOMAS I. McMANUS, A PROFESSIONAL LAND SURVEYOR LICENSED IN THE STATE OF NEVADA, CERTIFY THAT:

- 1) A FIELD SURVEY OF THE BOUNDARIES OF THE AFFECTED PARCELS HAS BEEN PERFORMED BY ME OR UNDER MY SUPERVISION AT THE INSTANCE OF WESTERN NEVADA PROPERTIES, INC.
- 2) THIS PLAT IS A TRUE AND ACCURATE REPRESENTATION OF THE LANDS SURVEYED.
- 3) ALL CORNERS AND ANGLE POINTS OF THE ADJUSTED BOUNDARY LINE HAVE BEEN SET AND THE MONUMENTS ARE OF THE CHARACTER SHOWN AND OCCUPY THE POSITIONS INDICATED AND ARE OF SUFFICIENT NUMBER AND DURABILITY TO ENABLE THIS SURVEY TO BE RETRACED.
- 4) THE LANDS SURVEYED LIE WITHIN PORTIONS OF THE SOUTHEAST 1/4 OF SECTION 30, T.13N., R.20E., M.D.M. AND THE SURVEY WAS COMPLETED ON 9-1-02.
- 5) THIS PLAT IS NOT IN CONFLICT WITH THE PROVISIONS OF NRS 278.010 THROUGH NRS 278.630 AND COMPLIES WITH ALL APPLICABLE STATE STATUTES AND ANY LOCAL ORDINANCES.

Thomas I. McManus 9-1-2002
THOMAS I. McMANUS, P.L.S. 6899 DATE

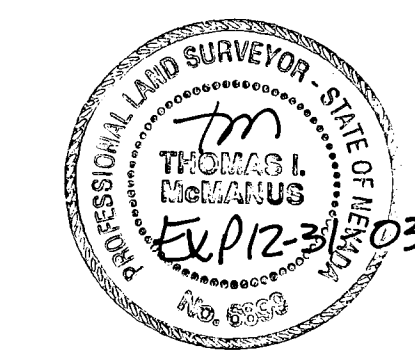

RECORDER'S CERTIFICATE

FILED FOR RECORD THIS 2nd DAY OF October, 2002, AT 12 MINUTES PAST 3 O'CLOCK P.M., IN BOOK 1002 OF OFFICIAL RECORDS, AT PAGE 742, DOCUMENT NO. 553427.

RECORDED AT THE REQUEST OF WESTERN NEVADA PROPERTIES, INC.
Barbara Clark, Deputy
DOUGLAS COUNTY RECORDER

SCALE: 1" = 60' SHEET 1 OF 1

RECORD OF SURVEY
TO SUPPORT A BOUNDARY LINE ADJUSTMENT
FOR
WESTERN NEVADA PROPERTIES, INC.

LOCATED WITHIN A PORTION OF SECTION 30,
T.13N., R.20E., M.D.M.
DOUGLAS COUNTY, NEVADA

574-15
57415BLA.dwg

9/15/02

30-13-20
Doc # 553427
Western Nevada

