

APN: 1220-31-001-012.
Escrow No. 2031343-MM
R.P.T.T. \$ 967.~~00~~ 20

WHEN RECORDED MAIL TO:

GBE, LLC
P.O. Box 756
Gardnerville, NV 89410

MAIL TAX STATEMENT TO:

Same as Above

GRANT, BARGAIN and SALE DEED

FOR A VALUABLE CONSIDERATION, receipt of which is hereby acknowledged,

GREAT BASIN EQUINE MEDICINE & SURGERY, INC., a Nevada corporation

Do(es) hereby GRANT, BARGAIN and SELL to

GBE, LLC, a Nevada limited liability company

The real property situate in the County of Douglas, State of Nevada, described as follows:

SEE LEGAL DESCRIPTION ATTACHED AS EXHIBIT 'A'

TOGETHER with all tenements, hereditaments and appurtenances, including easements and water rights, if any, thereto belonging or appertaining, and any reversions, remainders, rents, issues or profits thereof.

Date: 10/15/02

GREAT BASIN EQUINE MEDICINE & SURGERY, INC., a Nevada corporation

BY: Brian J. Peck
BRIAN J. PECK

BY: Martin L. Gardner
MARTIN L. GARDNER

State of Nevada
County of ~~Washoe~~
Douglas

This instrument was acknowledged before me on OCTOBER 15, 2002, by BRIAN PECK and MARTIN L. GARDNER

Erin Pellegrino
Notary Public

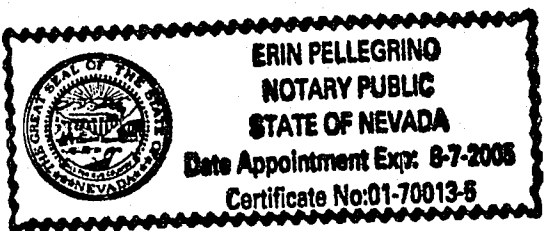

0555305

BK1002PG08339

EXHIBIT 'A'

All that real property situated in the County of Douglas , State of Nevada, bounded and described as follows:

Parcel 5A as set forth on that certain Parcel Map for CHRISTOPHER JOSEPH GARRETT, filed in the office of the County Recorder of Douglas County, State of Nevada, on December 19, 2001, in Book 1201, Page 6239, as Document No. 530404.

* * * * *

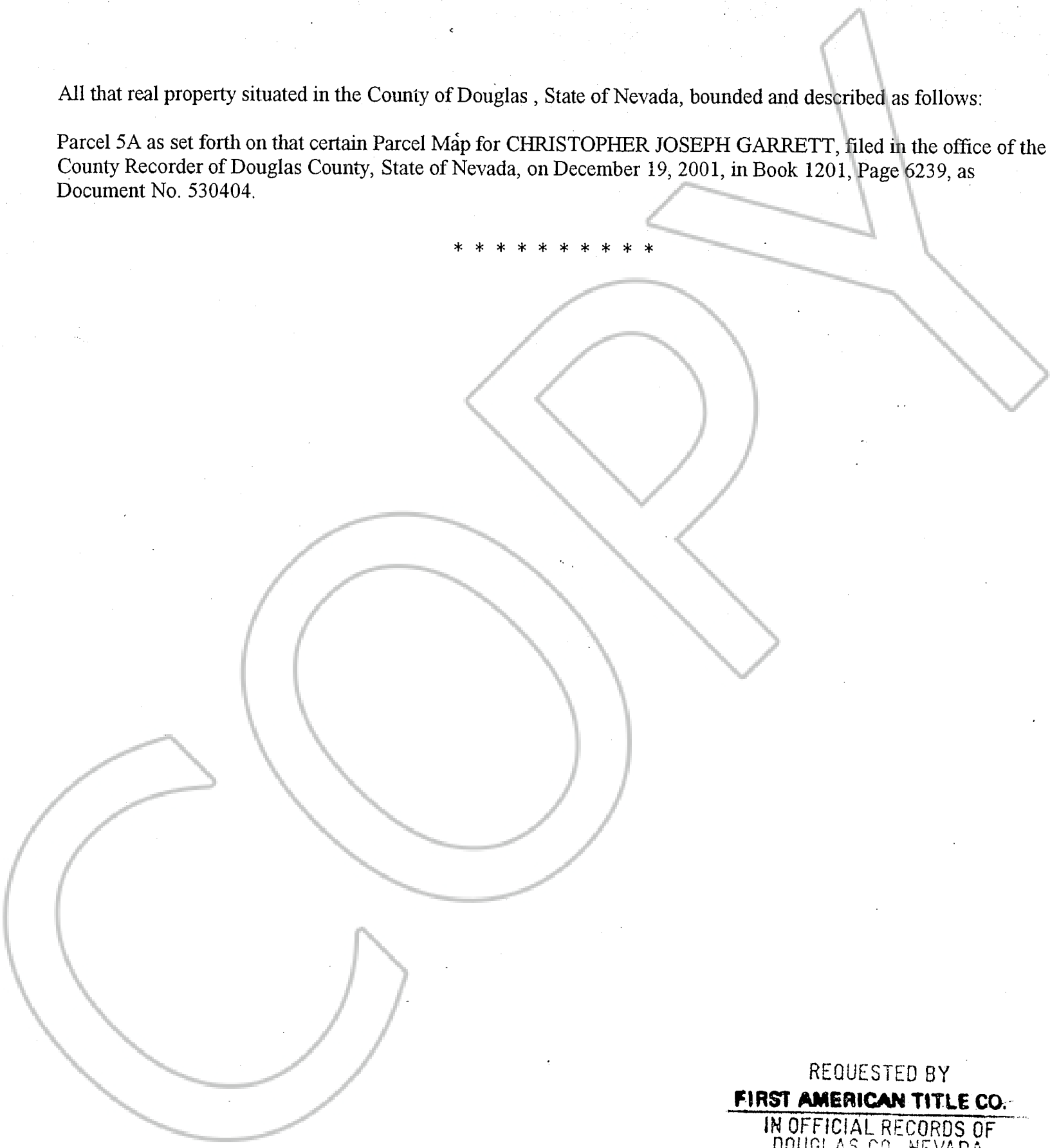

REQUESTED BY
FIRST AMERICAN TITLE CO.
IN OFFICIAL RECORDS OF
DOUGLAS CO., NEVADA

2002 OCT 18 PM 3: 35

LINDA SLATER
RECORDER

\$ 15⁰⁰ PAID *KJ* DEPUTY

0555305

BK 1002 PG 08340