

ESCROW NO. 2038817-MM
A.P.N. 1318-10-416-012
R.P.T.T. EXEMPT *#6*

WHEN RECORDED MAIL TO:

GARY K. ARMSTRONG
P.O. Box 365
Mill Valley, CA 94942

MAIL TAX STATEMENT TO:

Same as above

GRANT, BARGAIN and SALE DEED

FOR A VALUABLE CONSIDERATION, receipt of which is hereby acknowledged,

ANNIE S. ARMSTRONG, wife of grantee

do(es) hereby *GRANT, BARGAIN and SELL* to

GARY K. ARMSTRONG, a married man as his sole and separate property

the real property situate in the County of , State of NV, described as follows:

SEE ATTACHED EXHIBIT 'A' FOR LEGAL DESCRIPTION

THIS DEED IS GIVEN TO DIVEST ANY COMMUNITY PROPERTY INTEREST MAY HAVE IN THE ABOVE DESCRIBED REAL PROPERTY BY REASON OF HIS/HER MARRIAGE TO .

TOGETHER WITH all tenements, hereditaments and appurtenances, including easements and water rights, if any, thereto belonging or appertaining, and any reversions, remainders, rents, issues or profits thereof.

Dated: October 29, 2002

Annie Susan Armstrong
ANNIE S. ARMSTRONG

State of Nevada
County of Washoe

This instrument was acknowledged before me on October 29, 2002, by
ANNIE S. ARMSTRONG

M. Molnar
Notary Public

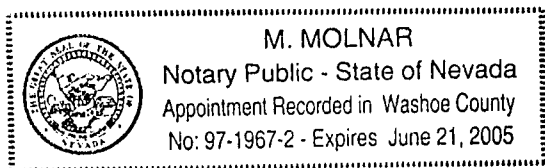

0556421

BK1002PG14547

EXHIBIT 'A'

Legal Description

All that real property situate in the County of Douglas, State of Nevada, described as follows:

Lot 8, Block 5, of the PLAT OF SECOND ADDITION TO ZEPHYR HEIGHTS SUBDIVISION, according to the map thereof, filed in the office of the County Recorder of Douglas County, State of Nevada, on July 6, 1948, as Document No. 6530.

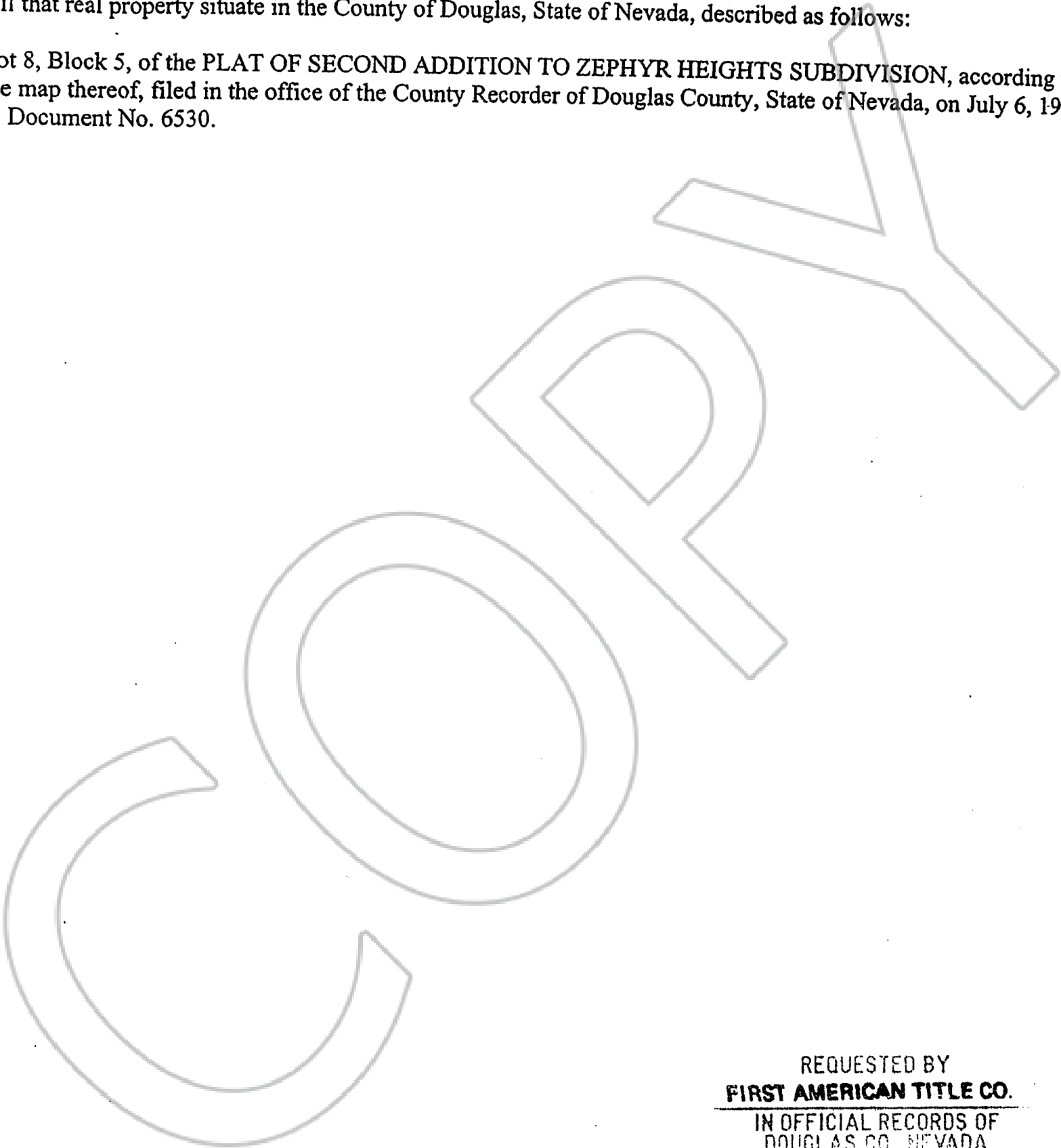

REQUESTED BY
FIRST AMERICAN TITLE CO.
IN OFFICIAL RECORDS OF
DOUGLAS CO. NEVADA

2002 OCT 31 PM 12:17

LINDA SLATER
RECORDER

\$15⁰⁰ PAID *Kg* DEPUTY

0556421

BK1002PG14548