

OWNER'S CERTIFICATE:
 WE, THE UNDERSIGNED OWNERS OF THE AFFECTED PARCELS AS SHOWN ON THIS MAP DO HEREBY STATE:

1. WE HAVE EXAMINED THIS PLAT AND APPROVE AND AUTHORIZE ITS RECORDING,
2. WE AGREE TO EXECUTE THE REQUIRED DOCUMENTS CREATING ANY EASEMENT WHICH IS SHOWN HEREON,
3. WE AGREE TO EXECUTE THE REQUIRED DOCUMENTS ABANDONING ANY EXISTING EASEMENT PURSUANT TO THE PROVISIONS OF NRS 278.010 TO 278.630, INCLUSIVE, AND SECTIONS 2 AND 3 OF CHAPTER 479 OF THE SIXTY-SIXTH LEGISLATIVE SESSION,
4. ALL PROPERTY TAXES ON THE LAND FOR THE FISCAL YEAR HAVE BEEN PAID,
5. ANY LENDER WITH AN IMPOUND ACCOUNT FOR THE PAYMENT OF TAXES HAS BEEN NOTIFIED OF THE ADJUSTMENT OF THE BOUNDARY LINE OR THE TRANSFER OF THE LAND.

APN 1319-33-002-005 & -006
Daniel R. Hickey 10-18-02
 DANIEL R. HICKEY DATE
Laurel C. Hickey 10-18-02
 LAUREL C. HICKEY DATE

NOTARY CERTIFICATES:
 STATE OF Nevada } S.S.
 Douglas County }
 ON THIS 18th DAY OF October, 2002
 PERSONALLY APPEARED BEFORE ME, A NOTARY PUBLIC IN AND FOR SAID COUNTY AND STATE, DANIEL R. HICKEY, WHO ACKNOWLEDGED THAT HE EXECUTED THE ABOVE INSTRUMENT.

Mary E. Baldecchi
 NOTARY PUBLIC
 MY COMMISSION EXPIRES ON 1/10/05



STATE OF Nevada } S.S.
 Douglas County }
 ON THIS 18th DAY OF October, 2002
 PERSONALLY APPEARED BEFORE ME, A NOTARY PUBLIC IN AND FOR SAID COUNTY AND STATE, LAUREL C. HICKEY, WHO ACKNOWLEDGED THAT SHE EXECUTED THE ABOVE INSTRUMENT.

Mary E. Baldecchi
 NOTARY PUBLIC
 MY COMMISSION EXPIRES ON 1/10/05

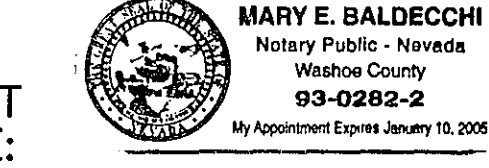

COMMUNITY DEVELOPMENT DEPARTMENT CERTIFICATE:
 IT IS HEREBY CERTIFIED THAT THIS PLAT WAS PRESENTED BEFORE THE DOUGLAS COUNTY COMMUNITY DEVELOPMENT ON THE 28th DAY OF October, 2002, AND WAS DULY APPROVED. FURTHERMORE THIS MAP IS IN SUBSTANTIAL CONFORMANCE WITH ALL APPLICABLE PROVISIONS OF STATE STATUTES AND COUNTY CODE.

James J. Volk
 BY: TAMMOT V. VOLT
 PLANNING, BUILDING AND ECONOMIC DEVELOPMENT DIRECTOR
 DEPARTMENT

COUNTY RECORDER'S CERTIFICATE:
 FILED THIS 14th DAY OF November, 2002 AT 00 MINUTES
 PAST 11 O'CLOCK A.M. IN BOOK 1102 AT PAGE 921
 DOCUMENT NUMBER 556669
 RECORDED AT THE REQUEST OF Stewart Title
 OF Douglas County
Carole Krossberg, Deputy
 DOUGLAS COUNTY RECORDER

SURVEYOR'S CERTIFICATE:
 I, DAVID D. WINCHELL, A PROFESSIONAL LAND SURVEYOR REGISTERED IN THE STATE OF NEVADA, CERTIFY THAT:

1. THIS PLAT REPRESENTS THE RESULTS OF A SURVEY CONDUCTED UNDER MY SUPERVISION AT THE INSTANCE OF DANIEL R. HICKEY.
2. THE LANDS SURVEYED LIE WITHIN A PORTION OF THE SOUTHEAST 1/4 OF SECTION 33 AND THE SOUTHWEST 1/4 OF SECTION 34, TOWNSHIP 13 NORTH, RANGE 19 EAST, AND THE SURVEY WAS COMPLETED ON FEBRUARY 22, 2001.
3. THIS PLAT COMPLIES WITH APPLICABLE STATUTES OF THIS STATE AND ANY LOCAL ORDINANCES IN EFFECT ON THE DATE THAT THE SURVEY WAS CONDUCTED IN ACCORDANCE WITH CHAPTER 625 OF THE NEVADA ADMINISTRATIVE CODE.
4. THE MONUMENTS DEPICTED ON THE PLAT ARE OF THE CHARACTER SHOWN, OCCUPY THE POSITIONS INDICATED, AND ARE OF SUFFICIENT DURABILITY.

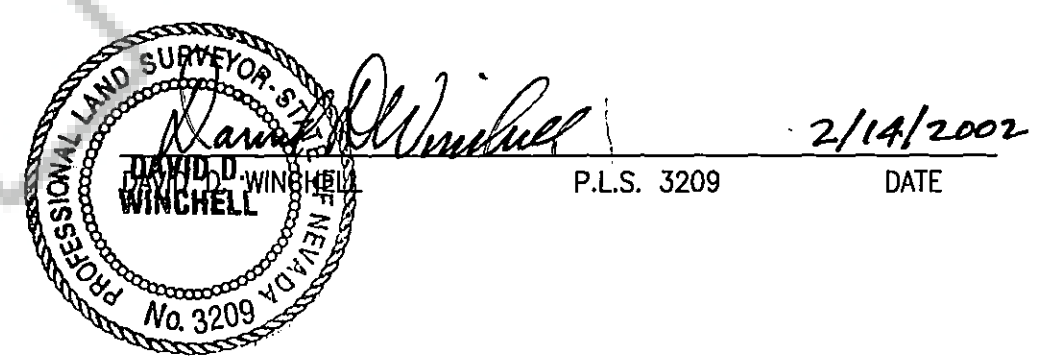

COUNTY TAX COLLECTOR'S CERTIFICATE:
 I, BARBARA J. REED, DOUGLAS COUNTY CLERK-TREASURER AND EX-OFFICIO TAX COLLECTOR DO HEREBY CERTIFY THAT ALL PROPERTY TAXES ON THIS LAND FOR THE FISCAL YEAR HAVE BEEN PAID.
 (APN 1319-33-002-005 & -006)
Barbara J. Reed 10/31/02
 BARBARA J. REED
 DOUGLAS COUNTY CLERK-TREASURER
 by: *Sunny Lundquist*
 Chief Deputy Treasurer
 NOTE: THIS RECORD OF SURVEY IS NOT IN CONFLICT WITH THE REQUIREMENTS OF NRS 278.010 TO 278.630, INCLUSIVE.

REFERENCE DOCUMENT:
 (R1) PARCEL MAP No. 2 FOR FLOYD D. ALLERMAN, LUCILLE ALLERMAN & CHRISTINE L. ALLERMAN DAWSON, RECORDED IN Bk. 684, PAGE 1787, DOCUMENT No. 102427.

- LEGEND**
- - INDICATES SET 5/8" REBAR AND CAP P.L.S. 3209
 - - INDICATES Fd. 6"x6" CONCRETE MONUMENT
 - 33 34 / 4 3 - INDICATES Fd. SECTION CORNER AS NOTED
 - - INDICATES Fd. 5/8" REBAR AS NOTED

BASIS OF BEARINGS
 THE BEARING N. 00°24'44" E., BEING THE WESTERLY RIGHT OF WAY LINE OF FOOTHILL ROAD, PER PARCEL MAP No. 2 FOR FLOYD D. ALLERMAN, LUCILLE ALLERMAN & CHRISTINE L. ALLERMAN DAWSON, RECORDED IN BOOK 684, PAGE 1787, AS DOCUMENT No. 102427 OF DOUGLAS COUNTY, NEVADA, WAS USED AS THE BASIS OF BEARINGS FOR THIS MAP.

EASEMENTS:
 A 5.00 FOOT EASEMENT ALONG ALL SIDE AND REAR PROPERTY LINES AND A 7.50 FOOT WIDE EASEMENT ALONG ALL STREET RIGHT-OF-WAY WITHIN THIS RECORD OF SURVEY ARE HEREBY GRANTED FOR PUBLIC UTILITY PURPOSES.

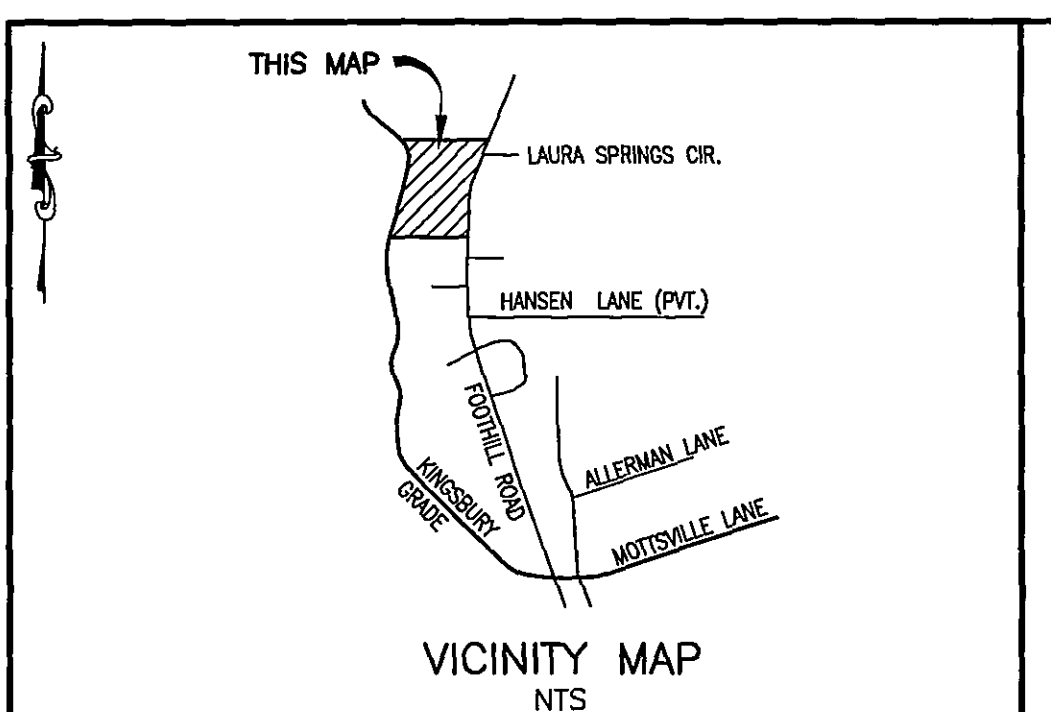

RECORD OF SURVEY
 IN SUPPORT OF A BOUNDARY LINE ADJUSTMENT FOR
DANIEL R. & LAUREL C. HICKEY
 LOCATED WITHIN PORTIONS OF SECTIONS 33 & 34,
 TOWNSHIP 13 NORTH, RANGE 19 EAST, M.D.B. & M.
 (BEING PARCELS 1 & 2 AS SHOWN PER PARCEL MAP No. 2 FOR
 FLOYD D. ALLERMAN, LUCILLE ALLERMAN & CHRISTINE L. ALLERMAN DAWSON
 RECORDED IN Bk. 684, PAGE 1787, AS DOCUMENT No. 102427)
 DOUGLAS COUNTY NEVADA
 SHEET 1 OF 1 SHEET

