

WHEN RECORDED MAIL TO:

WAYNE BROWN

P.O. BOX 1705

GARDNERVILLE, NV 89410

Order No.

Escrow No. M70224CH

R.P.T.T. Exemption #8

Based on full value

Based on full value

less liens

APN: 1320-35-001-017

INDIVIDUAL GRANT DEED

THIS INDENTURE WITNESSETH:

That for a valuable consideration, receipt of which is hereby acknowledged

WAYNE E. BROWN and MARTHA R. BROWN, Husband and Wife as

(GRANTOR), does hereby grant, bargain, sell, and convey to WAYNE E. BROWN, TRUSTEE AND MARTHA R. BROWN, TRUSTEE OF THE WAYNE E. BROWN AND MARTHA R. BROWN FAMILY TRUST DATED OCTOBER 28, 1994

(GRANTEE), all that real property in the County of DOUGLAS, State of Nevada, being Assessor's Parcel Number 23-295-15, specifically described as:

SEE EXHIBIT "A" ATTACHED HERETO AND MADE A PART HEREOF FOR LEGAL DESCRIPTION (Continued)

THIS INDIVIDUAL GRANT DEED IS BEING RE-RECORDED TO REFLECT THE CORRECT DESCRIPTION OF SUBJECT PROPERTY AS SET FORTH ON PAGE THREE-DESCRIPTION SHEET.

Together with all and singular the tenements, hereditaments and appurtenances thereunto belonging or in anywise appertaining, and any reversions, remainders, rents, issues or profits thereof.

Dated October 30, 1995

STATE OF NEVADA ) ) SS. County of Douglas )

WAYNE E. BROWN

MARTHA R. BROWN

This instrument was acknowledged before me on November 15, 1995 by WAYNE E. BROWN AND MARTHA R. BROWN

MAIL TAX STATEMENT TO: SAME AS ABOVE

Notary Public JANET LEE HARDY



FOR RECORDER'S USE

0557130

374855

BK 1102 PG 02627

BK 1195 PG 2407

EXHIBIT "A"

PARCEL NO. 1.:

A Parcel of land situated in and being a portion of the Northwest 1/4 of Section 35, in Township 13 North, Range 20 East, M.D.B.&M., described as follows:

Parcel 8C-1 as shown on that certain Jarrett Parcel Map filed for record in the Office of the County Recorder of Douglas County, Nevada on November 14, 1984 as Document No. 110020.

TOGETHER with an exclusive access easement for Parcel 8-C-1 as set forth on the hereinabove map.

Said parcel also being a division of Parcel 8-C as set forth on that certain Wagner Parcel Map filed for record in the Office of the County Recorder of Douglas County, Nevada on January 21, 1982, as Document No. 64239.

PARCEL NO. 2:

TOGETHER with all those certain access and utility easements for ingress and egress as set forth on that certain Record of Survey for Nevis Industries, Inc., filed for record in the office of the County Recorder of Douglas County, Nevada, on December 23, 1980, as Document No. 51917.

A.P.N. 23-295-15

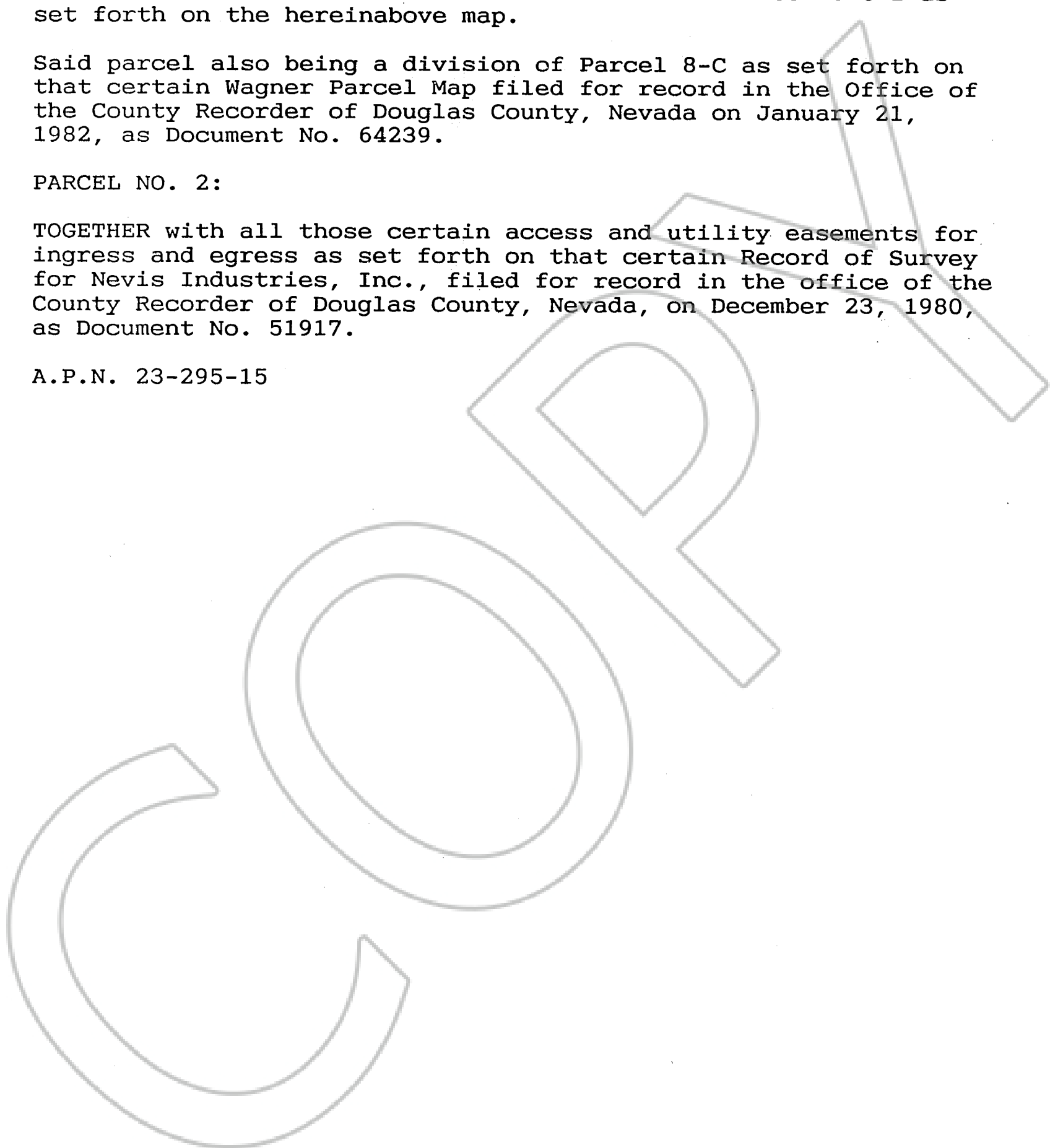

BK 1102 PG 02628  
0557130

REQUESTED BY  
Wayne Brown  
IN OFFICIAL RECORDS OF  
DOUGLAS CO. NEVADA

'95 NOV 15 P2:55

374855

LINDA SLATER  
RECORDER  
\$8.00 PAID KR DEPUTY

BK 1195 PG 2408

## DESCRIPTION SHEET

ALL THAT REAL PROPERTY SITUATE IN THE COUNTY OF DOUGLAS, STATE OF NEVADA, DESCRIBED AS FOLLOWS:

### PARCEL ONE:

A parcel of land located within a portion of the Northwest one-quarter (NW1/4) of Section 35, Township 13 North, Range 20 East, Mount Diablo Baseline and Meridian, Douglas County, Nevada, described as follows:

COMMENCING at the Northwest corner of Section 35, Township 13 North, Range 20 East M.D. B & M., as shown on the Parcel Map for Michael E. and Mary M. Jarrett as recorded in Book 1184, Page 1089 as Document No. 110020; thence South 26°48'02" East, 546.10 feet to the Point of Beginning; thence North 76°29'48" East, 559.28 feet; thence South 13°30'12" East, 432.93 feet; thence South 76°29'48" West, 456.96 feet; thence South 26°48'02" East, 496.24 feet to the Point of Beginning.

EXCEPTING therefrom a 50.00 foot exclusive access easement for Parcel 8C-2 described as follows:

COMMENCEING AT THE northwest corner of said Parcel 8C-1, described hereinabove, the Point of Beginning; thence North 76°29'48" East, 559.28 feet; thence South 13°30'12" East, 50.00 feet; thence South 76°29'48" West, 547.45 feet; thence North 26°48'02" West, 51.38 feet to the Point of Beginning.

### PARCEL TWO:

Together with all those certain access and utility easements for ingress and egress as set forth on that certain Record of Survey for Nevis Industries, Inc., filed for record in the Office of the County Recorder of Douglas County, Nevada, on December 23, 1980, Document 51917.

Assessor's Parcel No. 1320-35-001-017

NOTE: The above metes and bounds description appeared in that certain Boundary Line Adjustment Grant Bargain and Sale Deed recorded December 19, 1984, as Document No. 111438.

REQUESTED BY  
**WESTERN TITLE COMPANY, INC.**  
IN OFFICIAL RECORDS OF  
DOUGLAS CO., NEVADA

2002 NOV -6 PM 3:49

LINDA SLATER  
RECORDER

\$1600 PAID *Bl* DEPUTY

0557130

BK 1102 PG 02629