



**LEGAL DESCRIPTION**

The land referred to herein is situated in the State of Nevada, County of Douglas, described as follows:

Lot 119, as shown on the map of TOPAZ RANCH ESTATES UNIT NO. 2, filed in the Office of the County Recorder of Douglas County, Nevada, on February 20, 1967, as Document No. 35464.

Assessor's Parcel No. 1022-10-002-031

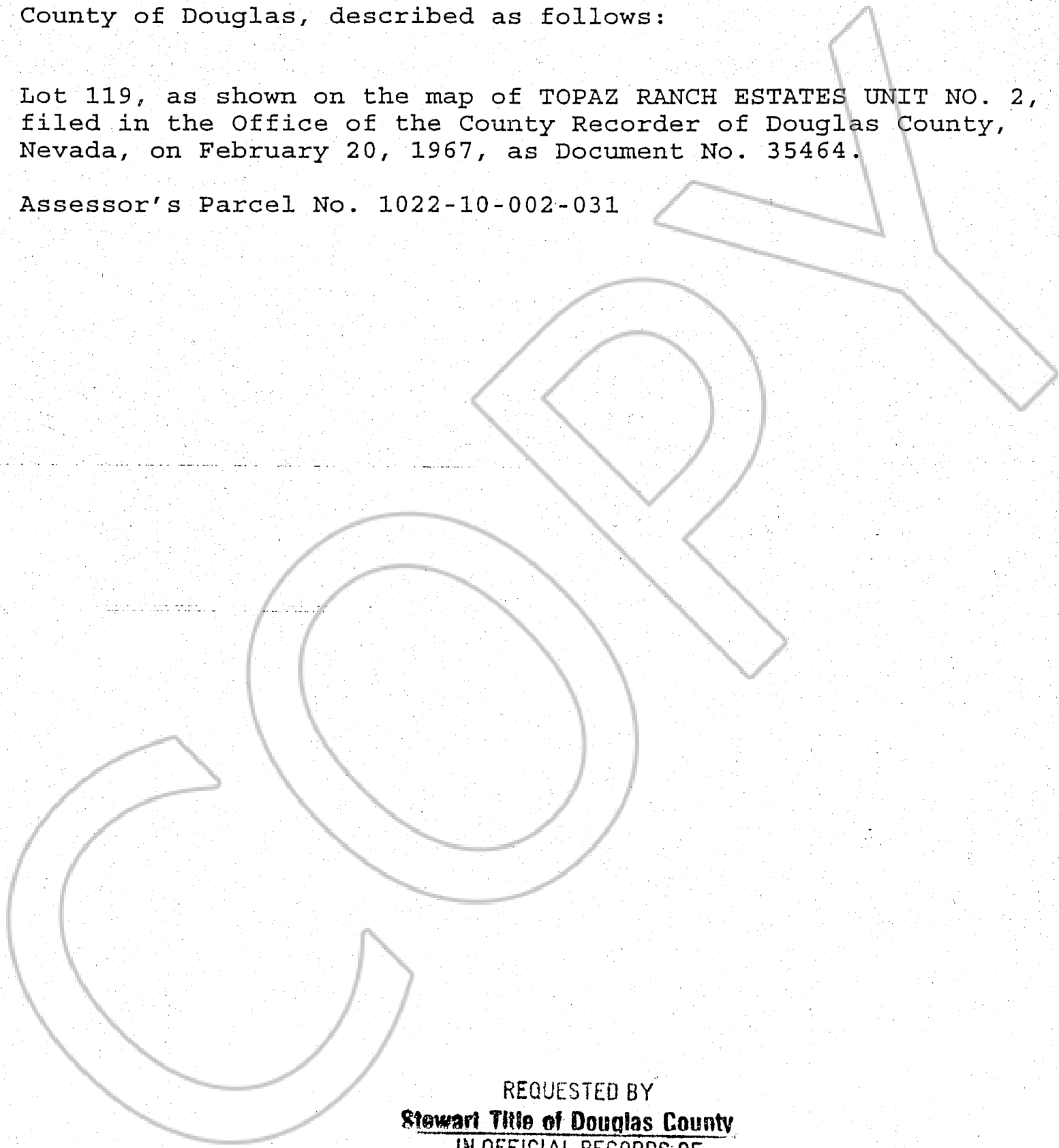

REQUESTED BY  
**Stewart Title of Douglas County**  
IN OFFICIAL RECORDS OF  
DOUGLAS CO., NEVADA

2002 NOV 19 PM 3:47

LINDA SLATER  
RECORDER

\$15<sup>00</sup> PAID *fl* DEPUTY

0558240

BK1102PG07908