

Control Section: DO-04  
Project: SUR-04007 ABN  
Route: US-395 Former Route SR-3, SR-19  
Parcel 1

✓ AFTER RECORDING RETURN TO:  
NEVADA DEPT. OF TRANSPORTATION  
RIGHT-OF-WAY DIVISION  
ATTN: PATRICIA ANDERSON  
1263 S. STEWART ST.  
CARSON CITY, NV 89712

RESOLUTION OF ABANDONMENT  
OF A PORTION OF STATE HIGHWAY RIGHT-OF-WAY

WHEREAS, the State of Nevada, Department of Transportation, hereinafter called the Department, presently holds an easement interest for all of that certain right-of-way for US-395 from approximate Highway Engineer's Station "B3" 328+70.00 P.O.C. northwesterly to approximate Highway Engineer's Station "B3" 331+70.00 P.O.C.; and

WHEREAS, the said right-of-way is delineated by shading and identified as Parcel 1 on Exhibit "A", attached hereto and made a part hereof; and

WHEREAS, pursuant to the provisions contained in NRS 408.523, the Nevada Department of Transportation Board of Directors may vacate or abandon by resolution, any portion of a state highway which has been superseded by relocation or has been determined to be in excess of the needs of the Department; and

WHEREAS, a portion of said right-of-way is of no further contemplated use by the State of Nevada, Department of Transportation, due to that certain portion of US-395 being in excess of the needs of the Department.

THEREFORE, it is hereby determined by the Board of Directors of the Department of Transportation of the State of Nevada, that the following described right-of-way and incidents thereto, being all that land delineated by shading and identified as Parcel 1, on Exhibit "A", is hereby abandoned. Said right-of-way is more particularly described as follows:

0558501

Being all that portion of land described as Parcel No. 1 within that certain DEED recorded in Book V of Deeds, Page 544, recorded October 8, 1940, in Douglas County, Nevada, lying northeasterly of a line sixty (60) feet right of the "B3" Centerline of US-395, from approximate Highway Engineer's Station "B3" 328+70.00 P.O.C., to approximate Highway Engineer's Station "B3" 331+70.00 P.O.C. Said parcel contains approximately 0.39 of an acre.

It is the intent of the Department of Transportation to abandon that portion of US-395, delineated by shading and identified as Parcel 1, on Exhibit "A", attached hereto and made a part hereof for reference.

DATED this 14<sup>th</sup> day of November, 2002.

ON BEHALF OF  
STATE OF NEVADA,  
DEPARTMENT OF TRANSPORTATION  
BOARD OF DIRECTORS

APPROVED AS TO LEGALITY AND FORM:

Brian Hutchins

Brian Hutchins  
Deputy Attorney General  
Chief Counsel

Kenny Guinn  
Kenny Guinn, Chairman

ATTEST:

Jeffrey Fontaine

Jeffrey Fontaine, Secretary to the Board



Certified a true and correct copy of the original which is on file at the Headquarters office of the State of Nevada, Department of Transportation, Carson City, Nevada. Patricia R. Manno  
STAFF SPECIALIST

# EXHIBIT "A"



SECTION 3  
SECTION 4

APPROX. 1/4 SECTION LINE

**PARCEL 1**  
17,068 S.F. ±

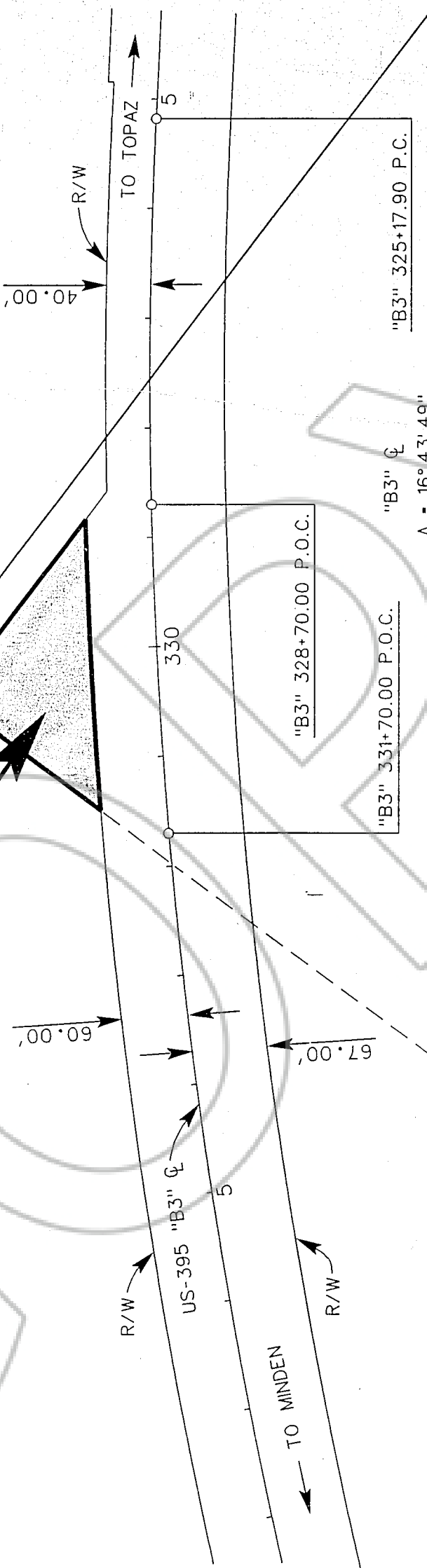

DO-04

STATE OF NEVADA

Dept. of Transportation R/W Division

Date: OCTOBER 2002

Sketch Map

Approved: *[Signature]*  
Manager, R/W Engineering

NOT TO SCALE

Sheet 1 of 1 Sheets

# COUNTY OF DOUGLAS

Date of last revision: \_\_\_\_\_

0558501  
BK 1102 PG 08532

TRACED: SLD  
CHECKED: RLC

COPY

REQUESTED BY  
*State of Nevada*  
IN OFFICIAL RECORDS OF  
DOUGLAS CO., NEVADA

2002 NOV 20 PM 3: 17

LINDA SLATER  
RECORDER

\$ 6 PAID KY DEPUTY

0558501

BK 1102 PG 08533