

#78899

GRANT, BARGAIN, SALE DEED

THIS INDENTURE WITNESSETH: That LAWRENCE FRANCES LAMBERT and KATHLEEN S. LAMBERT, HUSBAND AND WIFE in consideration of \$10.00, the receipt of which is hereby acknowledged, do hereby Grant, Bargain, Sell and Convey to COLEEN L. GOMEZ AND ALDO I. GOMEZ, HUSBAND AND WIFE, EACH AS TO AN UNDIVIDED 25% INTEREST, AND NICHOL C. GOMEZ, A SINGLE WOMAN* and to the heirs and assigns of such Grantee forever, all that real property situated 174 PINE DRIVE, Stateline, NV 89449, County of Douglas, State of Nevada, bounded and described as follows:

*AS TO AN UNDIVIDED 50% INTEREST, AS TENANTS IN COMMON
SEE EXHIBIT "A" ATTACHED HERETO AND MADE A PART HEREOF

Together with all and singular the tenements, hereditaments and appurtenances thereunto belonging or in anywise appertaining, and any reversions, remainders, rents, issues or profits thereof.

Witness my hand this 3rd day of December, 2002.

Lawrence Frances Lambert
LAWRENCE FRANCES LAMBERT

Kathleen S Lambert
KATHLEEN S. LAMBERT

STATE OF NEVADA
COUNTY OF Douglas

ON 12/3/02, before me, R L McEwing
personally appeared Lawrence Frances Lambert & Kathleen S. Lambert

personally known to me (or proved to me on the basis of satisfactory evidence) to be the person(s) whose name(s) is/are subscribed to the within instrument and acknowledged to me that he/she/they executed the same in his/her/their authorized capacity(ies), and that by his/her/their signature(s) on the instrument the person(s), or the entity upon behalf of which the person(s) acted, executed the instrument.

Witness my hand and official seal.
Signature R L McEwing

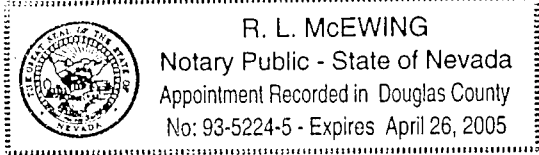

RECORDING REQUESTED BY AND MAIL TO:

NAME: TSI TITLE & ESCROW, INC.
ADDRESS: P.O. BOX 7197
CITY/ST/ZIP: STATELINE, NV. 89449

If applicable mail tax statements to:

NAME: MR. & MRS. GOMEZ, ET AL
ADDRESS: 658 GRIDER DRIVE
CITY/ST/ZIP: ROSEVILLE, CA. 95678

SPACE BELOW THIS LINE FOR RECORDERS USE ONLY

0560038
BK1202PG02980

LEGAL DESCRIPTION

ALL THAT CERTAIN LOT, PIECE OR PARCEL OF LAND SITUATE IN THE COUNTY OF DOUGLAS, STATE OF NEVADA DESCRIBED AS FOLLOWS:

Parcel 1

LOT 10, BLOCK G, AS SHOWN ON THE MAP OF FIRST ADDITION TO KINGSBURY MEADOWS, FILED FOR RECORD IN THE OFFICE OF THE COUNTY RECORDER OF DOUGLAS COUNTY, NEVADA ON JULY 17, 1957, AS DOCUMENT NO. 12441.

Parcel 2

TOGETHER WITH AN EASEMENT FOR INGRESS AND EGRESS, 10 FEET IN WIDTH, OVER, ACROSS AND UNDER THAT CERTAIN EXISTING RIGHT OF WAY ON THE FOLLOWING DESCRIBED PROPERTY; Lots 6, 7, 8 IN BLOCK F AS SHOWN ON THE OFFICIAL MAP OF KINGSBURY MEADOWS SUBDIVISION, FILED FOR RECORD IN THE OFFICE OF THE COUNTY RECORDER OF DOUGLAS COUNTY, NEVADA ON JULY 5, 1955, AS DOCUMENT NO. 10542.

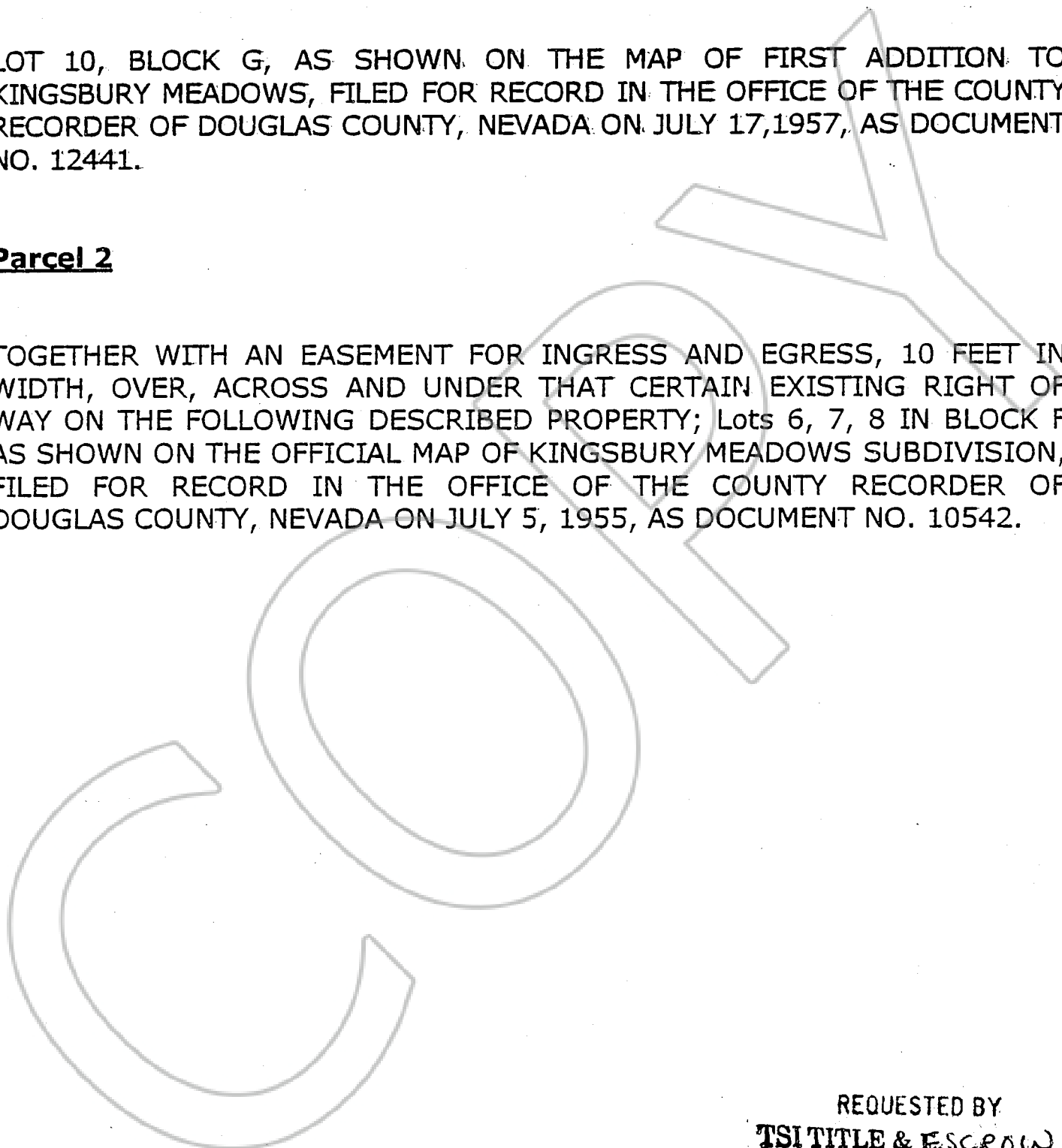

REQUESTED BY
TSI TITLE & ESCROW
IN OFFICIAL RECORDS OF
DOUGLAS CO., NEVADA

2002 DEC -6 PM 3: 03

LINDA SLATER
RECORDER

\$ 15⁰⁰ PAID KQ DEPUTY

0560038

BK 1202PG02981