

This instrument must be recorded in:
DOUGLAS County, NE

Recording Requested By:
WF472 WELLS FARGO HOME MORTGAGE, INC.

When Recorded Mail To:
BRIAN BRINK
9525 NORTH 156TH STREET
BENNINGTON, NE 68007

APPOINTMENT OF SUCCESSOR TRUSTEE

Loan #: 6572675 LPS #: 948177 Bin #: 12-13-02JD 

KNOW ALL MEN BY THESE PRESENTS, that...
BRIAN D BRINK, A SINGLE PERSON is the grantor, and STEWART TITLE GUARANTY COMPANY is the Trustee, and NORWEST MORTGAGE, INC. is the original beneficiary under that certain trust deed dated 1/16/98, and recorded on 1/29/98 as Instrument # -- in Book 5204 on Page 677 (If Re-Recorded on as # -- in Bk -- on Pg --), in Official Records of DOUGLAS County, NE.

Legal: SEE EXHIBIT A

The undersigned, who is the present beneficiary under said trust deed desires to appoint a new trustee in the place and stead of the original trustee named above;

NOW THEREFORE, in view of the premises, the undersigned hereby appoints Wells Fargo Financial National Bank, a National Banking Association, whose address is 5024 Parkway Plaza, NC 28273, as successor trustee under said trust deed, to have all the powers of said original trustee, effective immediately.

IN WITNESS WHEREOF, the undersigned beneficiary has executed this document. If the undersigned is a corporation, it has caused its name to be signed and its seal affixed by an officer or other person duly authorized to do so by its board of directors.

Wells Fargo Home Mortgage, Inc. f/k/a Norwest Mortgage, Inc. , as Beneficiary

On December 17, 2002

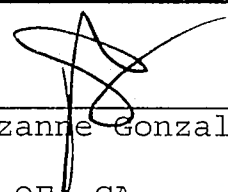
BY 
Suzanne Gonzalez, Vice President

STATE OF CA
COUNTY OF ORANGE

On December 17, 2002 before me, MICHELE REESE, a Notary Public in and for ORANGE County in the State of CA, personally appeared Suzanne Gonzalez, Vice President, personally known to me to be the person whose name is subscribed to the within instrument and acknowledged to me that he/she executed the same in his/her authorized capacity, and that by his/her signature on the instrument the person, or the entity upon behalf of which the person acted, executed the instrument.

WITNESS MY hand and official seal.

MICHELE REESE
Notary Public

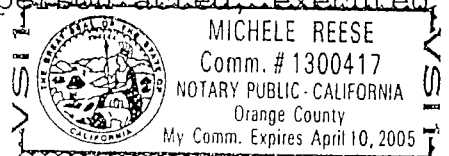

FNLPS, 15661 Redhill Ave, Suite 200, Tustin, CA 92780
(MIN#:) 855415
12/19/02

2/3/03
B

NE_042_948177_6572675_GRP3

0562058
BK1202PG11849

EXHIBIT A

Loan#: 6572675 LPS#: 948177 Bin #: 12-13-02JD



A TRACT OF LAND LYING WHOLLY IN THE SW 1/4 OF THE NW 1/4 OF SECTION 23, TOWNSHIP 16 NORTH, RANGE 11, EAST OF THE 6TH P.M., IN DOUGLAS COUNTY, NEBRASKA, MORE PARTICULARLY BOUNDED AND DESCRIBED AS FOLLOWS: COMMENCING AT THE NW CORNER OF SECTION 23, TOWNSHIP 16 NORTH 11 EAST, THENCE SOUTH ALONG THE SECTION LINE 1321.0 FEET; THENCE NORTH 89° 26 MINUTES EAST ALONG THE NORTH LINE OF THE SOUTH 1/2 OF THE NW 1/4 OF SAID SECTION 23 A DISTANCE OF 33 FEET TO THE POINT OF BEGINNING THENCE CONTINUING NORTH 89° 26 MINUTES EAST ALONG SAID NORTH LINE OF THE S 1/2 OF THE NW 1/4 OF SECTION 23 A DISTANCE OF 208.71 FEET; THENCE SOUTH AND PARALLEL TO THE WEST LINE OF SAID SECTION, A DISTANCE OF 208.71 FEET, THENCE SOUTH 89° 25 MINUTES WEST AND PARALLEL TO THE NORTH LINE OF THE S 1/2 OF THE NW 1/4 OF SAID SECTION 23, A DISTANCE OF 208.71 FEET; THENCE NORTH 33 FEET FROM AND PARALLEL TO THE WEST LINE OF SAID SECTION 23, A DISTANCE OF 208.71 FEET TO THE POINT OF BEGINNING.

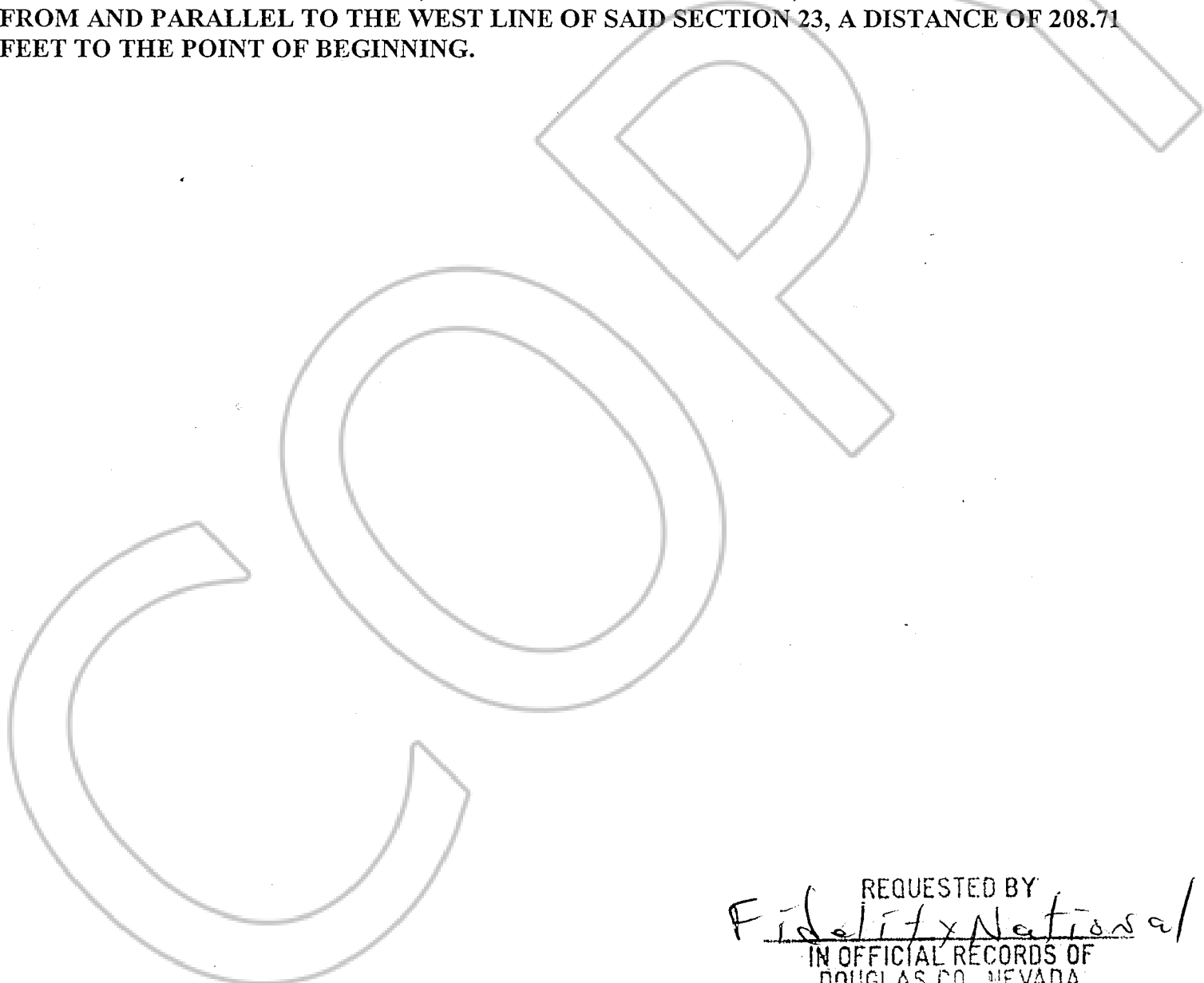

REQUESTED BY
Fidelity National
IN OFFICIAL RECORDS OF
DOUGLAS CO., NEVADA

2002 DEC 26 PM 2:47

LINDA SLATER
RECORDER

\$15.00 PAID *KJ* DEPUTY

0562058

BK 1202 PG 11850