

This instrument must be recorded in:
DOUGLAS County, NE

Recording Requested By:
WF472 WELLS FARGO HOME MORTGAGE, INC.

When Recorded Mail To:
BRIAN BRINK
9525 NORTH 156TH STREET
BENNINGTON, NE 68007

Loan #: 6572675 LPS #: 948177 Bin #: 12-13-02JD



DEED OF RECONVEYANCE

KNOW ALL MEN BY THESE PRESENTS,
THAT Wells Fargo Home Mortgage, Inc. f/k/a Norwest Mortgage, Inc., hereinafter referred to as the Beneficiary, HAS CERTIFIED that a certain Deed of Trust dated 1/16/98, made and executed by BRIAN D BRINK, A SINGLE PERSON, Trustor, to secure payment of the principal sum of \$100000.00 Dollars and interest, and NORWEST MORTGAGE, INC., Beneficiary, in the County of DOUGLAS and State of NE, and Recorded on 1/29/98 as Instrument # -- in Book 5204 on Page 677 (Re-Recorded: Inst#: -- in Book -- on Page --) is PAID AND SATISFIED; and does hereby consent that the same may be DISCHARGED OF RECORD.

Legal Description: SEE EXHIBIT A

IN WITNESS WHEREOF, Wells Fargo Financial National Bank, a National Banking Association, as trustee, in accordance with provisions of said Deed of Trust, the note having been fully satisfied, does hereby reconvey, without warranty, to the person or persons legally entitled thereto, the estate now held by it thereunder.

Wells Fargo Financial National Bank, a National Banking Association as
Trustee, Corporate Seal
ON December 17, 2002

BY 
Suzanne Gonzalez, Vice President

STATE OF CALIFORNIA
COUNTY OF ORANGE

On December 17, 2002 before me, MICHELE REESE, a Notary Public in and for Orange County in the State of California, personally appeared Suzanne Gonzalez, Vice President, personally known to me to be the person whose name is subscribed to the within instrument and acknowledged to me that he/she executed the same in his/her authorized capacity, and that by his/her signature on the instrument the person, or the entity upon behalf of which the person acted, executed the instrument.

WITNESS MY hand and official seal.

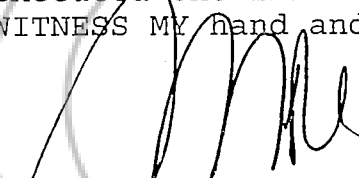
MICHELE REESE
Notary Public

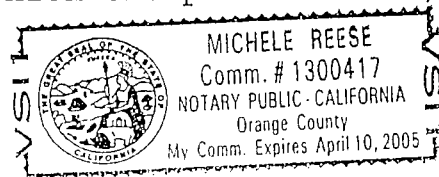

FNLPS, 15661 Redhill Ave, Suite 200, Tustin, CA 92780
(MIN#:) 855415
12/19/02

2/3/03
A

NE_042_948177_6572675_GRP3

0562059

BK 1202 PG 11851

EXHIBIT A

Loan#: 6572675 LPS#: 948177 Bin #: 12-13-02JD



A TRACT OF LAND LYING WHOLLY IN THE SW 1/4 OF THE NW 1/4 OF SECTION 23, TOWNSHIP 16 NORTH, RANGE 11, EAST OF THE 6TH P.M., IN DOUGLAS COUNTY, NEBRASKA, MORE PARTICULARLY BOUNDED AND DESCRIBED AS FOLLOWS: COMMENCING AT THE NW CORNER OF SECTION 23, TOWNSHIP 16 NORTH 11 EAST, THENCE SOUTH ALONG THE SECTION LINE 1321.0 FEET; THENCE NORTH 89° 26 MINUTES EAST ALONG THE NORTH LINE OF THE SOUTH 1/2 OF THE NW 1/4 OF SAID SECTION 23 A DISTANCE OF 33 FEET TO THE POINT OF BEGINNING THENCE CONTINUING NORTH 89° 26 MINUTES EAST ALONG SAID NORTH LINE OF THE S 1/2 OF THE NW 1/4 OF SECTION 23 A DISTANCE OF 208.71 FEET; THENCE SOUTH AND PARALLEL TO THE WEST LINE OF SAID SECTION, A DISTANCE OF 208.71 FEET, THENCE SOUTH 89° 25 MINUTES WEST AND PARALLEL TO THE NORTH LINE OF THE S 1/2 OF THE NW 1/4 OF SAID SECTION 23, A DISTANCE OF 208.71 FEET; THENCE NORTH 33 FEET FROM AND PARALLEL TO THE WEST LINE OF SAID SECTION 23, A DISTANCE OF 208.71 FEET TO THE POINT OF BEGINNING.

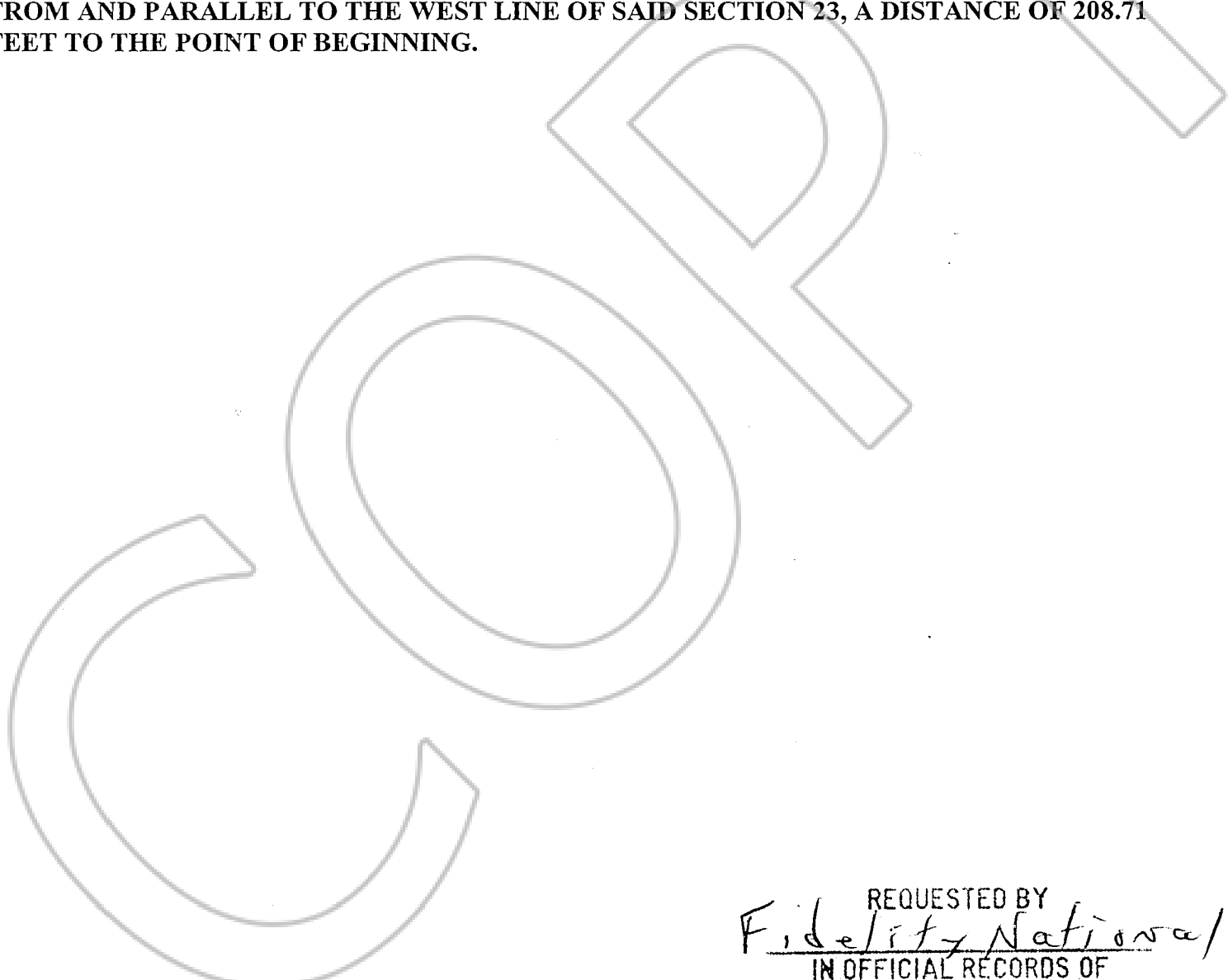

REQUESTED BY
Fidelity National
IN OFFICIAL RECORDS OF
DOUGLAS CO., NEVADA

2002 DEC 26 PM 2:48

LINDA SLATER
RECORDER

\$15⁰⁰ PAID *R2* DEPUTY

0562059

BK 1202 PG 11852