

EXHIBIT "A"

LEGAL DESCRIPTION

ESCROW NO.: 030100814

Lot 18, Block B, as set forth on FINAL SUBDIVISION MAP No. 1006-9 for CHICHESTER ESTATES, PHASE 9, filed in the office of the County Recorder of Douglas County, Nevada on November 27, 2001 in Book 1101 of Official Records, Page 7916, as Document No. 528504, and by Certificate of Amendment recorded February 15, 2002, in Book 0202, at Page 5301, as Document No. 534878.

Assessor's Parcel No. 1320-33-717-001

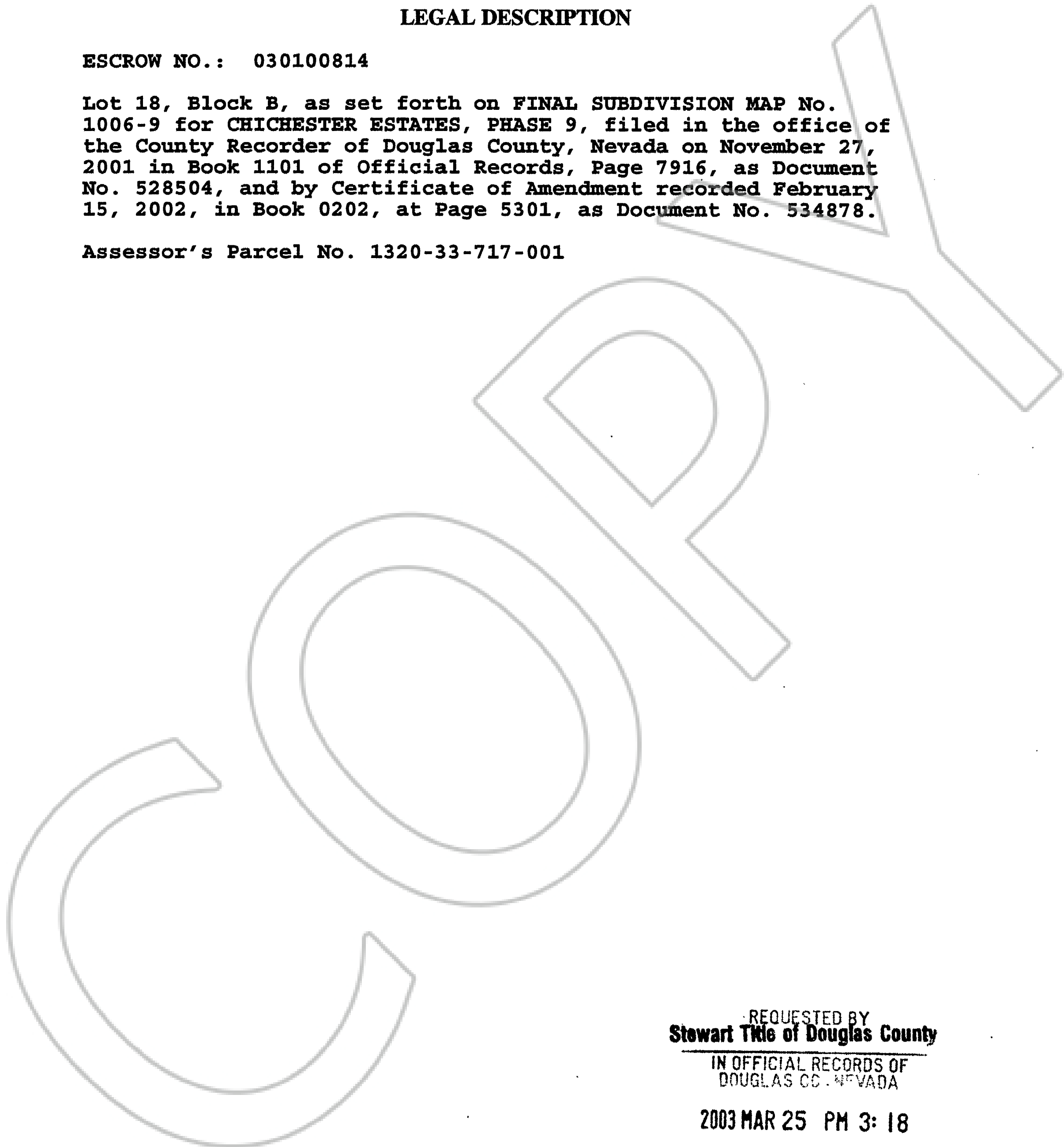

REQUESTED BY
Stewart Title of Douglas County

IN OFFICIAL RECORDS OF
DOUGLAS CO. NEVADA

2003 MAR 25 PM 3: 18

WERNER CHRISTEN
RECORDER

\$ 15⁰⁰ PAID *Kg* DEPUTY

0571226

BK 0303 PG 12002