

NF  
Comm Dev  
Lynda T Ogline

APN: 1318-23-401-005

RECORDED AT THE REQUEST OF  
✓ AND RETURN TO: *ATTN: JEFF FOLTZ*  
Douglas County Department of Community Development  
PO Box 218  
Minden, Nevada 89423

**GRANT DEED  
FOR LINEAR PUBLIC FACILITY**

R.P.T.T. \$ ~~\_\_\_\_\_~~ *#2*

THIS INDENTURE MADE THIS 27<sup>th</sup> day of FEBRUARY, 2003, between the Douglas County Parks Department in its capacity as operator of the Kahle Community Park, Party of the First Part, hereinafter called GRANTOR, and the County of Douglas, a political subdivision of the State of Nevada, Party of the Second Part, hereinafter called GRANTEE,

WITNESS:

That the GRANTOR, for and in consideration of the sum of ONE DOLLAR (\$ 1.00), lawful money of the United States of America, and other good valuable considerations, the receipt whereof is hereby acknowledged, does by these presents, grant, bargain, and sell unto the GRANTEE and to his assigns forever, a perpetual easement for a linear public facility, upon, over, across and through all that certain tract, piece or parcel of land situate, lying and being in the Southwest 1/4 of Section 23, Township 13 North, Range 18 East, M.D.B.&M., County of Douglas, State of Nevada, being a part of Assessor's Parcel Number 1318-23-401-005, more particularly described as follows:

**SEE ATTACHED LEGAL DESCRIPTION**

IN WITNESS WHEREOF said GRANTOR has hereunto signed on the day and year first above written.

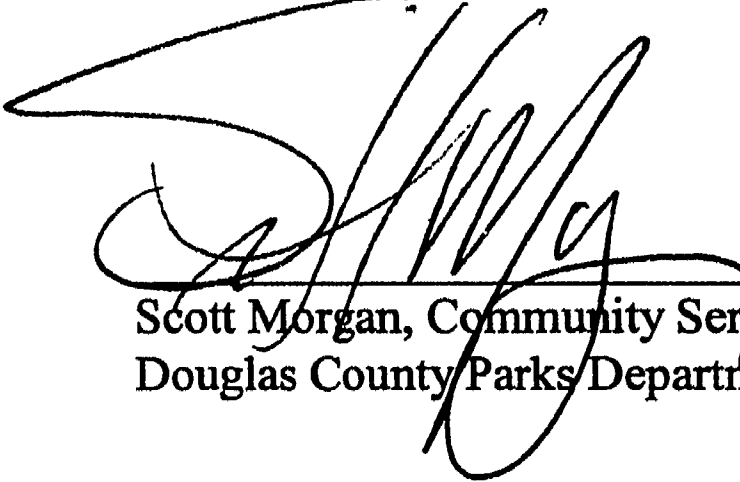
  
\_\_\_\_\_  
Scott Morgan, Community Services Director  
Douglas County Parks Department

STATE OF NEVADA        )  
                                  ) SS:  
COUNTY OF DOUGLAS    )

On this 11<sup>th</sup> day of March, in the year 2003 before me,  
Ellen L. Nelson / Notary Public, personally appeared  
Scott Morgan, personally known to me (or proved to me on  
the basis of satisfactory evidence) to be the person(s) whose name(s) is/are subscribed to this  
instrument, and acknowledge that he/she/they executed it.

WITNESS my hand and official seal.

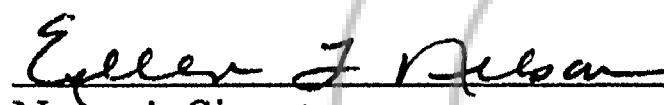
  
\_\_\_\_\_  
Notary's Signature  
My Commission Expires: 2/28/06

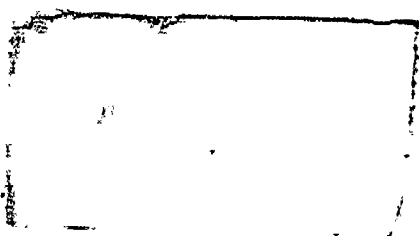
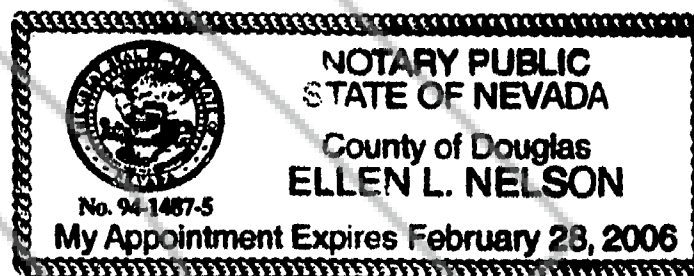

July, 2002  
02024

DESCRIPTION  
Linear Public Facility  
Centerline Description for an 8' Bike Path

All that real property situate in the County of Douglas, State of Nevada, described as follows:

All that portion of the Southwest ¼ of the Southwest ¼ of Section 23, Township 13 North, Range 18 East, M.D.M., more particularly described as follows;

Beginning at a point which bears South 62°33'18" East 265.66 feet from the Northwest corner of Parcel No. 2, as shown on that certain Record of Survey, filed for on September 27, 1999, as Document No. 477533;

thence along a curve concave to the South with a radius of 219.96 feet, a central angle of 21°04'45", and an arc length of 80.92 feet, the chord of said curve bears South 71°02'53" East 80.47 feet;

thence South 60°30'31" East 12.90 feet;

thence along a curve concave to the North with a radius of 170.18 feet, a central angle of 44°36'12", and an arc length of 132.49 feet, the chord of said curve bears South 82°48'42" East 129.17 feet;

thence North 74°53'07" East 44.28 feet;

thence along a curve concave to the South with a radius of 144.50 feet, a central angle of 30°38'47", and an arc length of 77.29 feet, the chord of said curve bears South 89°47'30" East 76.37 feet;

thence South 74°28'06" East 70.40 feet;

thence along a curve concave to the North with a radius of 104.00 feet, a central angle of 30°31'48", and an arc length of 55.42 feet, the chord of said curve bears South 89°44'00" East 54.76 feet;

thence North 75°00'06" East 6.41 feet;

thence along a curve concave to the South with a radius of 12.00 feet, a central angle of 82°50'04", and an arc length of 17.35 feet, the chord of said curve bears South 63°34'52" East 15.88 feet;

thence along a curve concave to the Northeast with a radius of 50.65 feet, a central angle of 7°15'30", and an arc length of 6.42 feet, the chord of said curve bears South 25°47'35" East 6.41 feet to a point on the northerly Right-of-Way of Kingsbury Grade.

The Basis of Bearing for this description is the above referenced Record of Survey.

Note: Refer this description to your title company before incorporating into any legal document.

Prepared by:

Turner & Associates, Inc.  
Land Surveying  
P.O. Box 5067  
Stateline, NV 89449

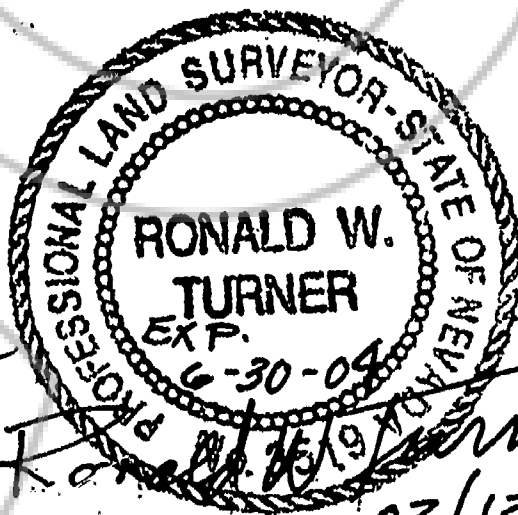
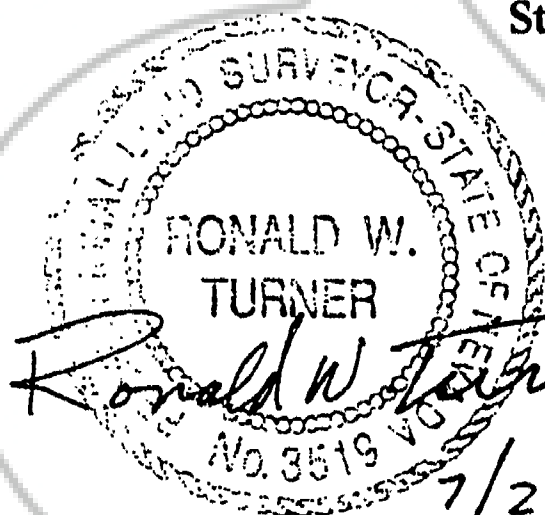

7/22/02  
02/12/03

0571411

BK0303PG12995

REQUESTED BY  
**DOUGLAS COUNTY**  
IN OFFICIAL RECORDS OF  
DOUGLAS COUNTY NEVADA

2003 MAR 27 AM 9:06

WERNER CHRISTEN  
RECORDER

PAID *Kr* DEPUTY

**CERTIFIED COPY**

The document to which this certificate is attached is a full, true and correct copy of the original on file and on record in my office.

DATE: March 24, 2003

B. Reed Clerk of the 9th Judicial District Court  
of the State of Nevada, in and for the County of Douglas.

By *Carl M. Huber* Deputy

0571411

BK0303PG12996

SEAL