

RECORDING REQUESTED BY
Santa Barbara Bank & Trust
Attn: Loan Support
P O Box 60734
Santa Barbara, Ca 93160-0734

AND WHEN RECORDED MAIL TO:
SYNCON HOMES A NEVADA CORPORA
2221 MERIDIAN BLVD SUITE A
MINDEN NV 89423

SPACE ABOVE THIS LINE FOR RECORDER'S USE

PARTIAL RECONVEYANCE

Recon #03-0306-06

PACIFIC CAPITAL COMMERCIAL MORTGAGE, INC, a California corporation, trustee under Deed of Trust executed by Romulus Development, LLC, a Nevada Corporation Limited Liability Company, as to Lots 1-12, inclusive, Block A; Lots 13-24, inclusive, in Block B; and Lots 56-65, inclusive, in Block E and Syncon Homes, a Nevada Corporation, as to Lots 19 and 20, in Block B; Lots 25-35, inclusive, in Block C; Lots 36-52, inclusive, in Block D; and Lots 53-56, inclusive, in Block E., Trustor, dated July 1, 2001 and recorded as Instrument No. 519849, on August 2, 2001 in Book 801, Page 0612-0623 and modified July 1, 2002, recorded as instrument No. 0552506 on September 19, 2002 having been requested in writing, by the holder of the obligation secured by said Deed of Trust, to reconvey the estate granted to Trustee under said Deed of Trust, in and to herein described property, and said Deed of Trust and note or notes secured thereby having been presented for endorsement, hereby reconveys, without warranty, to the person or persons legally entitled thereof, all estate now held by it thereunder in and to that property situated in Douglas County, State of Nevada described as follows:

See legal description attached hereto and made part hereof marked Exhibit "A"

March 19, 2003

PCB SERVICE CORPORATION,
a California corporation
(formerly Pacific Capital Commercial Mortgage, Inc.)

By: *Deborah A. Reynolds*
Deborah A. Reynolds

By: *Robin Whatley*
Robin Whatley

Title/Escrow Company: Stewart Title of Douglas Co., Attn: Jeanne Cooley, 1650 N. Lucerne, Minden, NV 89423
Order No.: 20306773 Lot 29 Blk C, 1617 Shirley St.
Loan No.: 24621-26181

0571815

BK0303PG14921

AA

CALIFORNIA ALL-PURPOSE ACKNOWLEDGMENT

State of California
 County of Santa Barbara

On March 25th, 2003 before me, Gary Geise Notary Public,
DATE NAME, TITLE OF OFFICER-E.G., "JANE DOE, NOTARY PUBLIC"

personally appeared Deborrah A. Reynolds and Robin Whatley
NAME(S) OF SIGNER(S)

personally known to me -OR- proved to me on the basis of satisfactory evidence to be the person(s) whose name(s) is/are subscribed to the within instrument and acknowledged to me that he/she/they executed the same in his/her/their authorized capacity(ies), and that by his/her/their signatures on the instrument the persons(s), or the entity upon behalf of which the person(s) acted, executed the instrument.

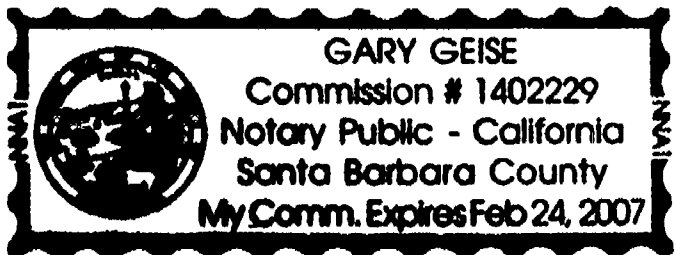

WITNESS my hand and official seal.

Gary Geise
SIGNATURE OF NOTARY

OPTIONAL

Though the data below is not required by law, it may prove valuable to persons relying on the document and could prevent fraudulent reattachment of this form.

CAPACITY CLAIMED BY SIGNER

INDIVIDUAL
 CORPORATE OFFICER

TITLE(S)

PARTNERS LIMITED
 GENERAL

ATTORNEY-IN-FACT
 TRUSTEE(S)
 GUARDIAN/CONSERVATOR
 OTHER: _____

SIGNER IS REPRESENTING:
NAME OF PERSON(S) OR ENTITY(IES)
PCB SERVICE CORPORATION,
a California corporation

DESCRIPTION OF ATTACHED DOCUMENT

PARTIAL RECONVEYANCE
TITLE OR TYPE OF DOCUMENT

3
NUMBER OF PAGES

March 19, 2003
DATE OF DOCUMENT

Syncon / Romulus (Skyline)
REFERENCE

0571815

BK0303PG14922

ATTACHED TO PARTIAL RECONVEYANCE
Syncon Homes, a Nevada Corporation
Loan No. 24621-26181

EXHIBIT "A"

Lot 29 in Block C as set forth on the Final Subdivision Map FSM #94-04-01 for SKYLINE RANCH
PHASE I filed for record with the Douglas County Recorder on May 11, 2001 in Book 0501, of Official
Records, Page 3298 as Document No. 514006.

APR No. 1420-35-410-005

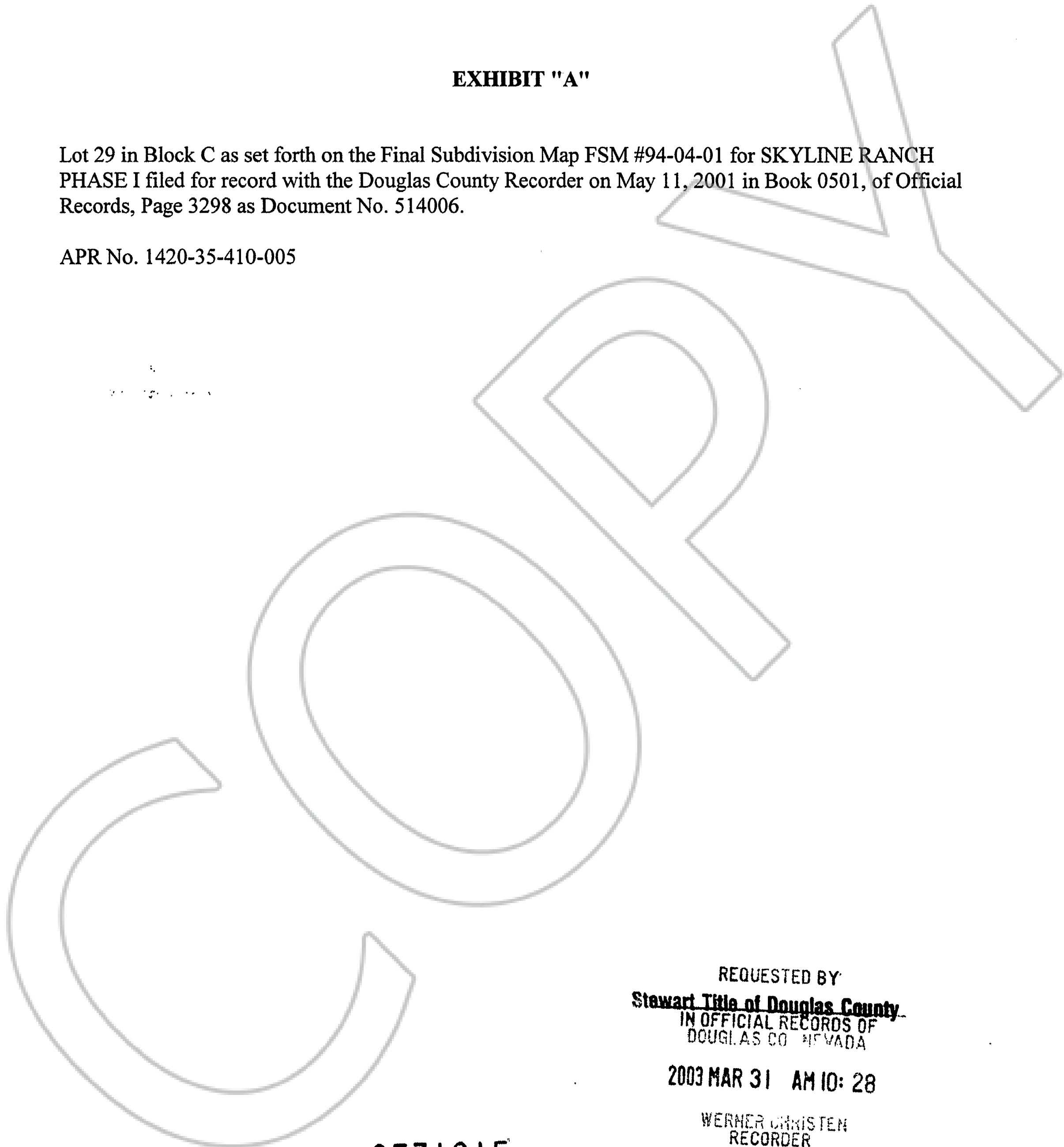

REQUESTED BY
Stewart Title of Douglas County
IN OFFICIAL RECORDS OF
DOUGLAS CO. NEVADA

2003 MAR 31 AM 10: 28

WERNER CHRISTEN
RECORDER

s/16 ^{SD} PAID KJ DEPUTY

0571815

BK0303PG14923