

A.P.N. # 1320-08-410-001

R.P.T.T. \$ \$498.55
ESCROW NO. 020108922
Full Value

RECORDING REQUESTED BY:
STEWART TITLE COMPANY
WHEN RECORDED MAIL TO:
MAIL TAX STATEMENTS TO:

GRANTEE
20 SO. SANTA CRUZ AVE., #300
LOS GATOS, CA 95030

CORPORATION
GRANT, BARGAIN, SALE DEED

THIS INDENTURE WITNESSETH: That
ALLEGRETTI & COMPANY, a California Corporation

in consideration of \$10.00, the receipt of which is hereby acknowledged, does hereby Grant, Bargain Sell and Convey to
LSPI EXCHANGE CORP., A NEVADA CORPORATION

and to the heirs and assigns of such Grantee forever, all that real property situated in the
County of **Douglas** State of Nevada, bounded and described as follows:
SEE EXHIBIT "A" ATTACHED HERETO AND MADE A PART HEREOF

Together with all and singular the tenements, hereditaments and appurtenances thereunto belonging or in anywise
appertaining, and any reversions, remainders, rents, issues or profits thereof.

DATE: **March 31, 2003**

ALLEGRETTI & COMPANY,
a California Corporation

BY: *Joseph Allegretti*
JOSEPH ALLEGRETTI
PRESIDENT

BY: _____

STATE OF CALIFORNIA }
COUNTY OF LOS ANGELES } SS.

This instrument was acknowledged before me on 04-01-03,
by, **JOSEPH ALLEGRETTI**

Signature _____
Notary Public

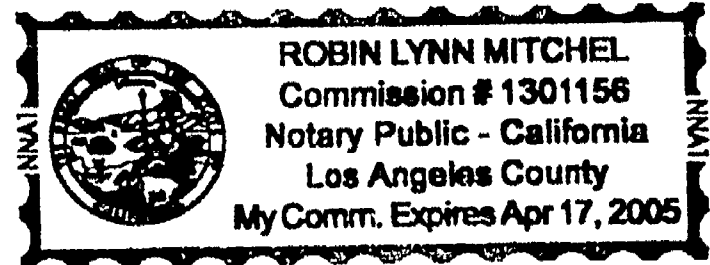

0572462
BK0403PG02179

LEGAL DESCRIPTION
FOR
PARCEL 3A

All that portion of land situated in the SW ¼ of Section 8, Township 13 North, Range 20 East, M.D. M., in the County of Douglas, State of Nevada, more particularly described as follows:

Beginning at a point North 00°03'04" East, 126.14 feet from the Southwest corner of Parcel 3B as shown on Record of Survey, document No. 565770, recorded January 31, 2003 in the Office of the Douglas County Recorder; thence through the following courses;

1. North 00°03'04" East, 591.36 feet;
2. North 89°46'14" East, 448.04 feet to the Westerly Right-of-Way of Meridian Blvd. Said point also being a point on a curve having a radial bearing of N 65°55'21" W and a radius of 705.00 feet;
3. Southerly along said curve through a central angle of 22°18'24" and an arc length of 274.48 feet;
4. South 00°13'45" East, 208.43 feet to the beginning of a tangent curve to the left having a radius of 750.81 feet;
5. Southerly along said curve through a central angle of 8°50'09" and an arc length of 115.79 feet;
6. Leaving said Right-of-Way South 89°46'14" West, 407.08 feet to the POINT OF BEGINNING.

Area = 5.50 acres +/- or 239,580 Sq. Ft.

The Bearing of N 00°03'04" E along the West line of Tract 3, Block "A" as shown on Document No. 426476 was used as the Basis of Bearings for this description.

Prepared by:
Donald A. Dick
1005 Eagle Ct.
Gardnerville, Nv. 89460

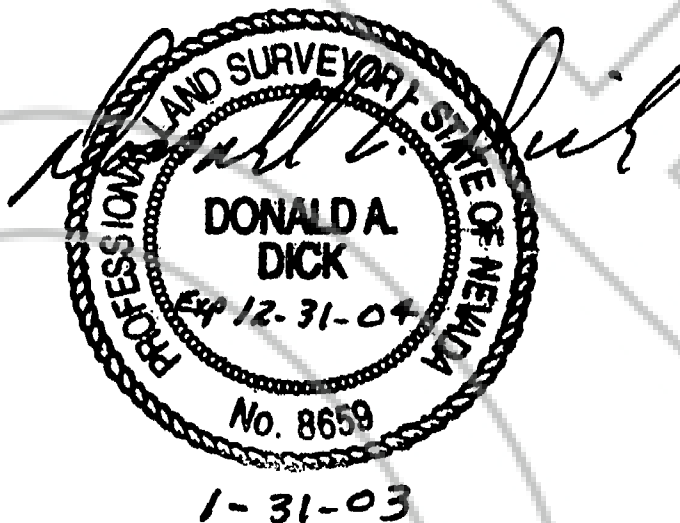

REQUESTED BY
Stewart Title of Douglas County
IN OFFICIAL RECORDS OF
DOUGLAS CO. NEVADA

2003 APR -4 AM 11: 05

WERNER CHRISTEN
RECORDER

\$15⁰⁰ PAID Bl DEPUTY

0572462

BK0403PG02180