

EXHIBIT "A"

LEGAL DESCRIPTION

ESCROW NO.: 030300708

Parcel 4 as set forth on Parcel Map LDA #00-063 for WEST RIDGE HOMES, INC., filed for record in the office of the county Recorder of Douglas County, State of Nevada on June 28, 2001, Book 0601, Page 7777, as Document No. 517344.

ASSESSOR'S PARCEL NO. 1420-28-801-012

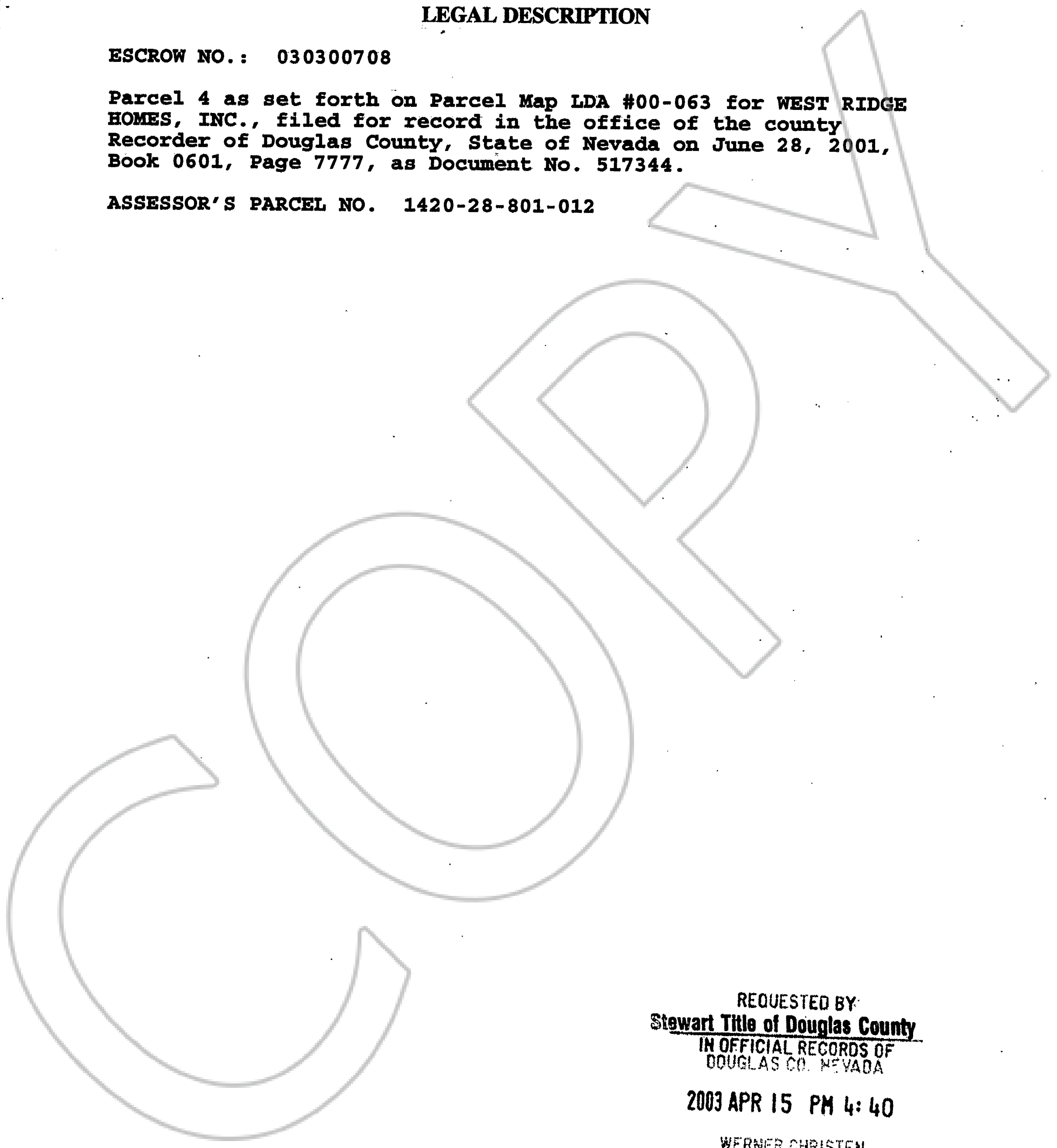

REQUESTED BY:
Stewart Title of Douglas County
IN OFFICIAL RECORDS OF
DOUGLAS CO. NEVADA

2003 APR 15 PM 4:40

WERNER CHRISTEN
RECORDER

\$15⁰⁰ PAID *KJ* DEPUTY

0573641

BK0403PG07364