

**OWNER'S CERTIFICATE:**

WE, THE UNDERSIGNED OWNERS OF THE AFFECTED PARCELS AS SHOWN ON THIS MAP DO HEREBY STATE:

1. WE HAVE EXAMINED THIS PLAT AND APPROVE AND AUTHORIZE ITS RECORDING,
2. WE AGREE TO EXECUTE THE REQUIRED DOCUMENTS CREATING ANY EASEMENT WHICH IS SHOWN HEREON,
3. WE AGREE TO EXECUTE THE REQUIRED DOCUMENTS ABANDONING ANY EXISTING EASEMENT PURSUANT TO THE PROVISIONS OF NRS 278.010 TO 278.630, INCLUSIVE, AND SECTIONS 2 AND 3 OF CHAPTER 479 OF THE SIXTY-SIXTH LEGISLATIVE SESSION,
4. ALL PROPERTY TAXES ON THE LAND FOR THE FISCAL YEAR HAVE BEEN PAID,
5. ANY LENDER WITH AN IMPOUND ACCOUNT FOR THE PAYMENT OF TAXES HAS BEEN NOTIFIED OF THE ADJUSTMENT OF THE BOUNDARY LINE OR THE TRANSFER OF THE LAND.

*Steve Brown*  
STEVE BROWN  
9-17-03  
DATE

*Suzanne C. Brown*  
SUZANNE C. BROWN  
4-17-03  
DATE

**NOTARY CERTIFICATES:**

STATE OF Nevada }  
Douglas COUNTY } S.S.  
ON THIS 17<sup>th</sup> DAY OF April, 2003,  
PERSONALLY APPEARED BEFORE ME, A NOTARY PUBLIC IN AND FOR SAID COUNTY AND STATE, STEVE BROWN AND SUZANNE C. BROWN, WHO ACKNOWLEDGED THAT THEY EXECUTED THE ABOVE INSTRUMENT.

*Linda M. O'Neill*  
NOTARY PUBLIC  
MY COMMISSION EXPIRES ON July 20, 2005



**SURVEYOR'S CERTIFICATE:**

I, DAVID D. WINCHELL, A PROFESSIONAL LAND SURVEYOR REGISTERED IN THE STATE OF NEVADA, CERTIFY THAT:

1. THIS PLAT REPRESENTS THE RESULTS OF A SURVEY CONDUCTED UNDER MY SUPERVISION AT THE INSTANCE OF STEVE BROWN.
2. THE LANDS SURVEYED LIE WITHIN A PORTION OF SECTIONS 2 AND 11, TOWNSHIP 12 NORTH, RANGE 19 EAST, M.D.B.&M., AND THE SURVEY THE SURVEY WAS COMPLETED ON SEPTEMBER 9, 2002.
3. THIS PLAT COMPLIES WITH APPLICABLE STATUTES OF THIS STATE AND ANY LOCAL ORDINANCES IN EFFECT ON THE DATE THAT THE SURVEY WAS CONDUCTED IN ACCORDANCE WITH CHAPTER 625 OF THE NEVADA ADMINISTRATIVE CODE.
4. THE MONUMENTS DEPICTED ON THE PLAT ARE OF THE CHARACTER SHOWN, OCCUPY THE POSITIONS INDICATED, AND ARE OF SUFFICIENT DURABILITY.

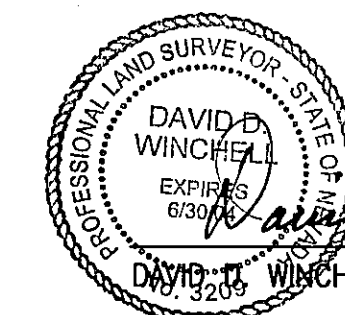

*David D. Winchell*  
DAVID D. WINCHELL  
P.L.S. 3209  
4/17/03  
DATE

**COUNTY TAX COLLECTOR'S CERTIFICATE:**

I, BARBARA J. REED, DOUGLAS COUNTY CLERK-TREASURER AND EX-OFFICIO TAX COLLECTOR DO HEREBY CERTIFY THAT ALL PROPERTY TAXES ON THIS LAND FOR THE FISCAL YEAR HAVE BEEN PAID.  
(APN APN 1219-02-000-011, 1219-02-000-015)

*Barbara J. Reed*  
BARBARA J. REED  
DOUGLAS COUNTY CLERK-TREASURER  
By: *Jenny Hunsicker*, Chief Deputy Treasurer

**COMMUNITY DEVELOPMENT DEPARTMENT CERTIFICATE:**

IT IS HEREBY CERTIFIED THAT THIS PLAT WAS PRESENTED BEFORE THE DOUGLAS COUNTY COMMUNITY DEVELOPMENT ON THE 18<sup>th</sup> DAY OF April, 2003, AND WAS DULY APPROVED. FURTHERMORE THIS MAP IS IN SUBSTANTIAL CONFORMANCE WITH ALL APPLICABLE PROVISIONS OF STATE STATUTES AND COUNTY CODE.

*Adam Gilbert*  
BY: ADAM GILBERT  
PLANNING, BUILDING AND ECONOMIC DEVELOPMENT DIRECTOR

**COUNTY RECORDER'S CERTIFICATE:**

FILED THIS 25<sup>th</sup> DAY OF APRIL, 2003 AT 46 MINUTES  
PAST 10 O'CLOCK A.M. IN BOOK 0403, AT PAGE 12074.  
DOCUMENT NUMBER 574619  
RECORDED AT THE REQUEST OF Stewart Title.

*Betty Hinson*, Deputy  
DOUGLAS COUNTY RECORDER

NOTE: THIS RECORD OF SURVEY IS NOT IN CONFLICT WITH THE REQUIREMENTS OF NRS 278.010 TO 278.630, INCLUSIVE.

**EASEMENTS:**

A 5.00 FOOT EASEMENT ALONG ALL SIDE AND REAR PROPERTY LINES AND A 7.50 FOOT WIDE EASEMENT ALONG ALL STREET RIGHT-OF-WAY WITHIN THIS RECORD OF SURVEY ARE HEREBY GRANTED FOR PUBLIC UTILITY PURPOSES.

**REFERENCE DOCUMENTS**

- (R) RECORD OF SURVEY IN SUPPORT OF A BOUNDARY LINE ADJUSTMENT FOR LEE W. & SHARON BERGEVIN, RUSSELL FAMILY TRUST AND DRESSLER FAMILY TRUST, RECORDED IN BOOK 600, PAGE 6236, AS DOCUMENT No. 495047, OFFICIAL RECORDS OF DOUGLAS COUNTY.

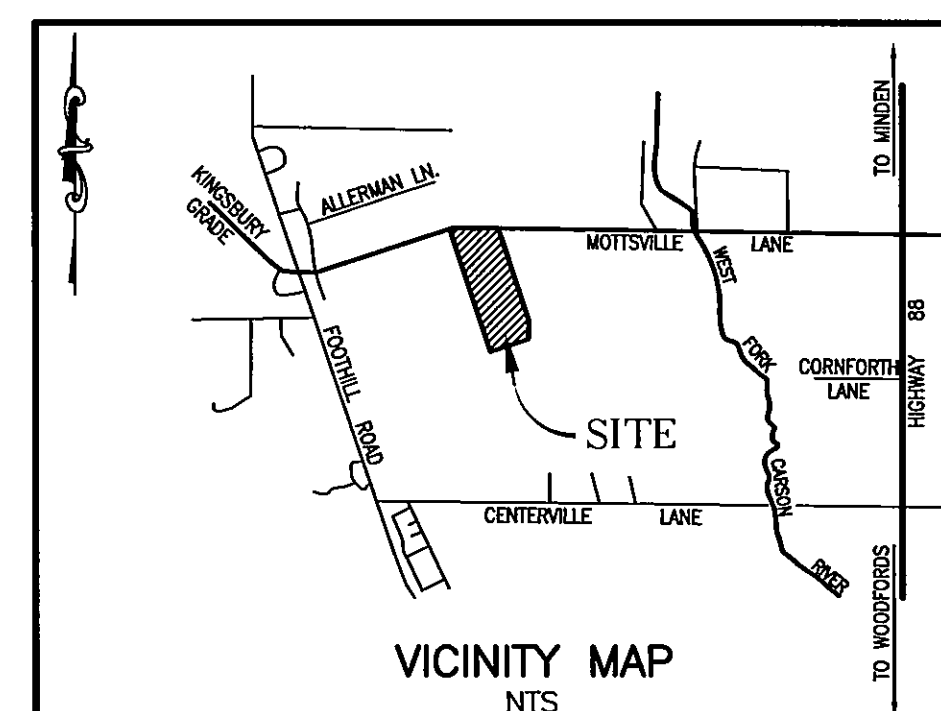

**RECORD OF SURVEY**  
IN SUPPORT OF A BOUNDARY LINE ADJUSTMENT FOR  
**STEVE & SUZANNE C. BROWN**

LOCATED WITHIN PORTIONS OF SECTIONS 2 & 11, T. 12 N., R. 19 E., M.D.B. & M. (BEING ADJUSTED PARCEL 1 AND ADJUSTED PARCEL 2 PER RECORD OF SURVEY TO SUPPORT A BOUNDARY LINE ADJUSTMENT FOR LEE W. & SHARON BERGEVIN, RUSSELL FAMILY TRUST AND DRESSLER FAMILY TRUST, RECORDED IN BOOK 600, PAGE 6236, AS DOCUMENT No. 495047)

DOUGLAS COUNTY NEVADA  
SHEET 1 OF 1 SHEET

2,11-12-19

