

APN 1318-10-416-027
RPTT Exempt #3
ESCROW NO: 116574-JH

Grant, Bargain, Sale Deed

THIS INDENTURE WITNESSETH: That **David Allen Evans and Marvelle Starre Evans**

In consideration of \$10.00, the receipt of which is hereby acknowledged, do hereby Grant, Bargain, Sell and Convey to

David Allen Evans and Marvelle Starre Evans, husband and wife as joint tenants

all that real property situated in the City of Zephyr Cove, County of Douglas,

State of Nevada, described as follows:

Lot 19, in Block A, as shown on the Plat of the SECOND ADDITION TO ZEPHYR HEIGHTS SUBDIVISION, according to the filed map recorded in the Office of the County Recorder of Douglas County, Nevada, on July 6, 1948, in Book 1 of Maps, as File No. 6530.

Together with all and singular the tenements, hereditaments and appurtenances thereunto belonging or in anywise appertaining.

Witness his/hers/theirs hand(s) this _____ day of April 16, 2003.

David Allen Evans
David Allen Evans

Marvelle Starre Evans
Marvelle Starre Evans

STATE OF NEVADA } SS:
COUNTY OF WASHOE

This instrument was acknowledged before me on April 16, 2003
by David Allen Evans and Marvelle Starre Evans.

Jami Herndon
NOTARY PUBLIC

JAMI HERNDON
Notary Public - State of Nevada
Appointed Recorder of Washoe County
No. 96-577-1-1 August 1, 2001

Escrow No. 116574-JH

SPACE BELOW FOR RECORDER'S USE

AND WHEN RECORDED MAIL TO:

David Allen Evans
Marvelle Starre Evans
PO Box 12297
Zephyr Cove, NV 89448

MAIL TAX STATEMENTS TO:

Same as Above

Loan Number: 062868783-2

EXHIBIT "A"
Legal Description

Lot 19, in Block A, as shown on the Plat of the SECOND ADDITION TO ZEPHYR HEIGHTS SUBDIVISION, according to the filed map recorded in the Office of the County Recorder of Douglas County, Nevada, on July 6, 1948, in Book 1 of Maps, as File No. 6530.

APN: 1318-10-416-027

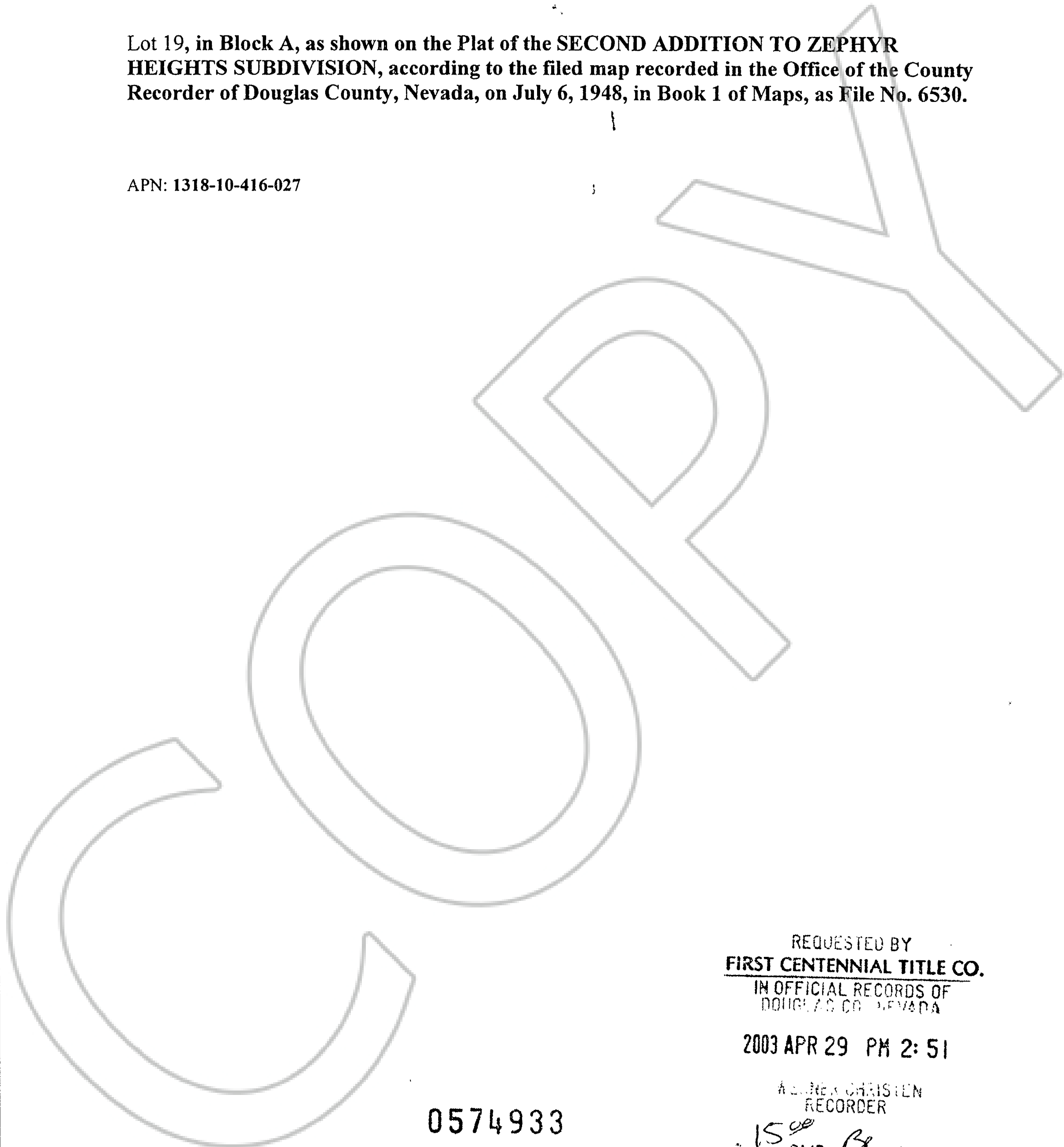

REQUESTED BY
FIRST CENTENNIAL TITLE CO.
IN OFFICIAL RECORDS OF
DOUGLAS COUNTY, NEVADA

2003 APR 29 PM 2: 51

ALEXANDER CHRISTEN
RECORDER

\$ 15.00 PAID *Bx* DEPUTY

0574933

BK 0403 PG 14140