

A.P.N. # 1219-04-001-025

R.P.T.T. \$ 0 #3
ESCROW NO. 030101272

RECORDING REQUESTED BY:
STEWART TITLE COMPANY
WHEN RECORDED MAIL TO:
MAIL TAX STATEMENTS TO:

CHURCHILL
P.O. BOX 11086
ZEPHYR COVE, NV 89448

GRANT, BARGAIN, SALE DEED

THIS INDENTURE WITNESSETH: That **WILLIAM ARTHUR CHURCHILL AND CAROLYNN NELSON CHURCHILL, TRUSTEES OF THE WILLIAM ARTHUR CHURCHILL AND CAROLYNN NELSON CHURCHILL REVOCABLE LIVING TRUST DATED MARCH 8, 1983**

in consideration of \$10.00, the receipt of which is hereby acknowledged, does hereby Grant, Bargain Sell and Convey to **WILLIAM ARTHUR CHURCHILL AND CAROLYNN NELSON CHURCHILL, TRUSTEES OF THE WILLIAM ARTHUR CHURCHILL AND CAROLYNN NELSON CHURCHILL REVOCABLE LIVING TRUST DATED MARCH 8,, 1983.**

and to the heirs and assigns of such Grantee forever, all that real property situated in the County of **Douglas** State of Nevada, bounded and described as follows:

SEE ATTACHED EXHIBIT "A" FOR FULL LEGAL DESCRIPTION

Together with all and singular the tenements, hereditaments and appurtenances thereunto belonging or in anywise appertaining, and any reversions, remainders, rents, issues or profits thereof.

DATE: **April 25, 2003**



William Arthur Churchill, Trustee
WILLIAM ARTHUR CHURCHILL, TRUSTEE

Carolynn Nelson Churchill, Trustee
CAROLYN NELSON CHURCHILL, TRUSTEE

STATE OF NV }
COUNTY OF Douglas } ss.

This instrument was acknowledged before me on 4/28/03
by William Arthur Churchill and Carolynn Nelson Churchill

Signature Suzanne Cheechov
Notary Public

0574941

BK0403PG14226

EXHIBIT "A"

LEGAL DESCRIPTION

ESCROW NO.: 030101272

Lot 12 as set forth on Final Subdivision Map PD #01-017 for TAYLOR CREEK ESTATES, filed for record in the Office of the County Recorder of Douglas County, State of Nevada on April 26, 2002, in Book 0402, at Page 8620, as Document No. 540786.

ASSESSOR'S PARCEL NO. 1219-04-001-025

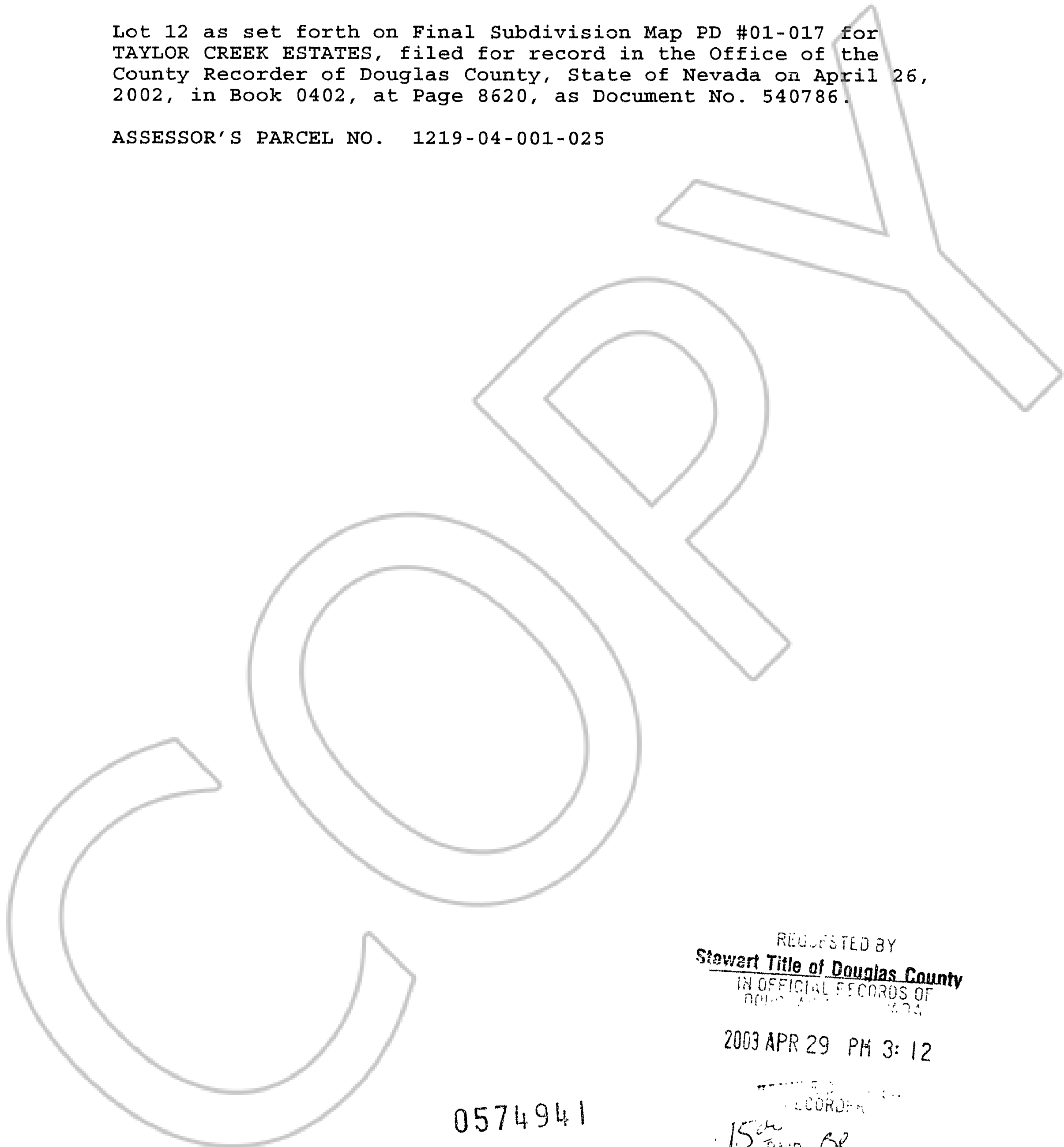

REQUESTED BY
Stewart Title of Douglas County
IN OFFICIAL RECORDS OF
DOUGLAS COUNTY, NEVADA

2003 APR 29 PM 3:12

RECORDED

PAID BY DEPUTY

0574941

BK 0403 PG 14227