

Escrow No. 21100468
A.P.N. 1319-10-211-006

GRANT, BARGAIN AND SALE DEED

THIS INDENTURE WITNESSETH: That for a valuable consideration, receipt of which is hereby acknowledged,

BRALY G. ZUMWALT, a single man

do(es) hereby **GRANT, BARGAIN, SELL and CONVEY** to

SAMUEL TORRES AND SHARON G. TORRES, husband and wife as Joint Tenants with right of survivorship

all that real property situated in the County of Douglas, State of Nevada, being Assessor's Parcel Number **1319-10-211-006**, specifically described as follows:

Lot 15, as shown on the Official Map of PIONEER TRAIL RANCH SUBDIVISION, UNIT NO. 1, filed in the office of the County Recorder of Douglas County, State of Nevada, on November 21, 1966, as Document No. 34628.

THIS DEED IS BEING RE-RECORDED TO CORRECT THE LEGAL DESCRIPTION WHICH IS MARKED AS EXHIBIT "A" ATTACHED HERETO AND MADE A PART HEREOF, AS IT WAS ORIGINALLY INTENDED.

TOGETHER with all and singular the tenements, hereditaments and appurtenances, including easements and water rights, if any, thereto belonging or in anywise appertaining, and any reversions, remainders, rents, issues of profits thereof.

WITNESS my hand this 6 day of July, 2001



BRALY G. ZUMWALT

STATE OF NEVADA
COUNTY OF _____

On _____ personally appeared before me, a Notary Public, _____

who acknowledged that he executed the above instrument.

Notary Public

WHEN RECORDED MAIL TO:

Mr. & Mrs. Samuel Torres
734 Via Del Sol
Livermore, CA 94550

The grantor (s) declare:
Documentary transfer tax is \$ 240.50
 computed on full value of property conveyed, or
computed on full value less value of liens and
encumbrances remaining at time of sale

MAIL TAX STATEMENTS TO:
SAME AS ABOVE:

0574951 0519351
BK0403PG14287 BK0701PG7122

STATE OF CALIFORNIA }
COUNTY OF Glenn } ss

On July 24, 2001 before me, **the undersigned, a notary public** in and for said County and State, personally appeared *****Brady G. Zumwalt*****, personally known to me (or proved to me on the basis of satisfactory evidence) to be the person(s) whose names(s) is/are subscribed to the within instrument and acknowledged to me that he/she/they executed the same in his/her/their capacity(ies), and that by his/her/their signature(s) on the instrument the person(s), or the entity upon behalf of which the person(s) acted, executed the instrument.

WITNESSETH by my hand and official seal.

Heather A. Duncan

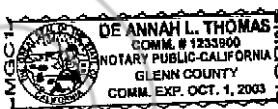

REQUESTED BY
MARCUS TITLE & ESCROW, L.A.C.
IN OFFICIAL RECORDS OF
DOUGLAS CO., NEVADA

2001 JUL 27 PM 12:47

LINDA SLATER
RECORDER

\$ 8.00 PAID RL DEPUTY

0574951

0519351

BK0403PG14288

BK0701PG7123

EXHIBIT "A"

LEGAL DESCRIPTION

ESCROW NO.: 030700967

Lot 15, as shown on the official map of PIONEER TRAIL RANCH
SUBDIVISION UNIT NO. 2, recorded in the office of the County
Recorder on January 27, 1972, in Book 1 of Maps, as Document No.
57534.

Assessor's Parcel No. 1319-10-211-006

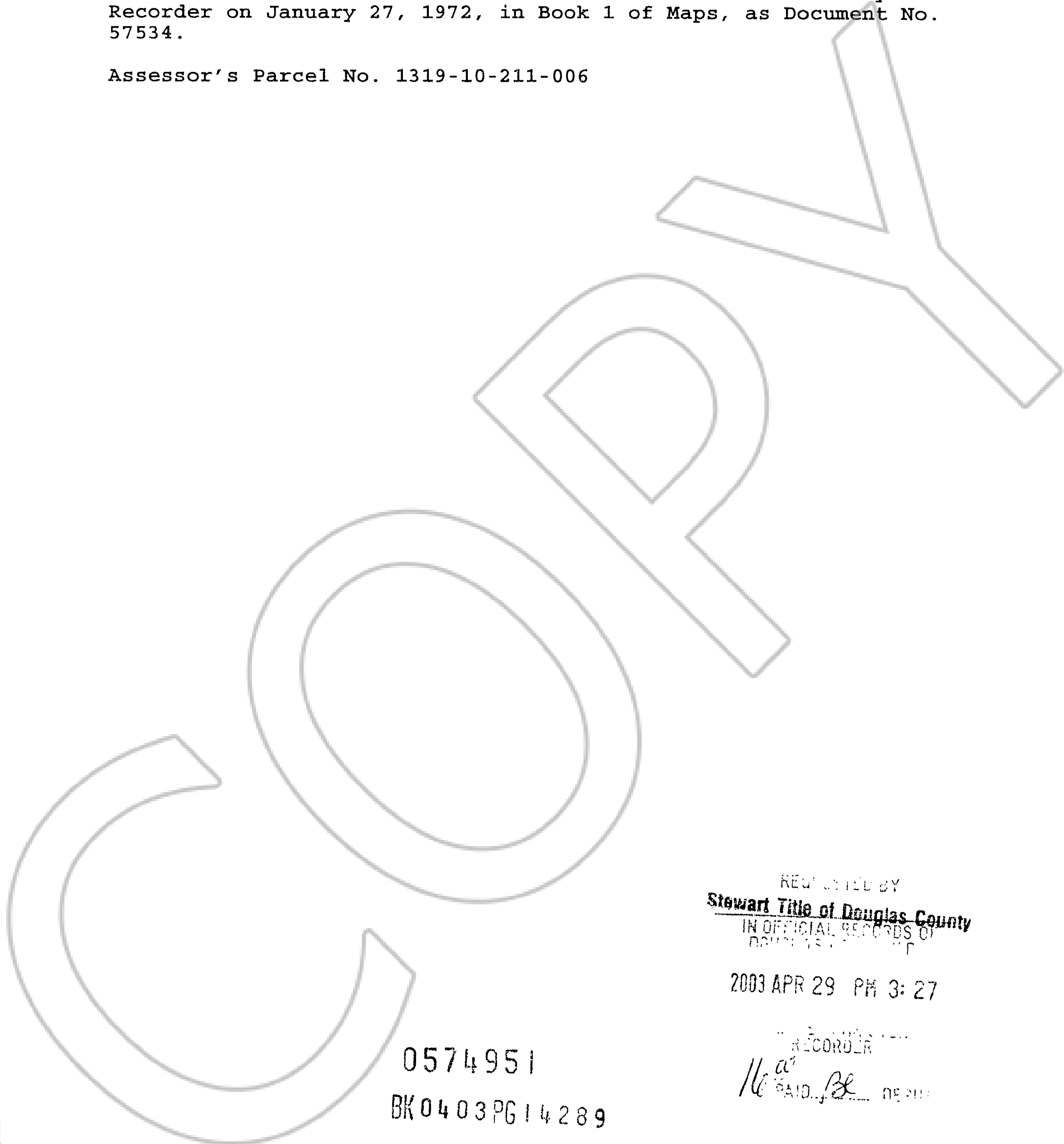

RECORDED BY
Stewart Title of Douglas County
IN OFFICIAL RECORDS OF
DOUGLAS COUNTY

2003 APR 29 PM 3: 27

RECORDED
He PAID *Be* DEPUTY

0574951
BK 0403 PG 14289