

RETURN TO:
Town of Minden
Post Office Box 205
Minden, Nevada 89423

GRANT OF EASEMENT

APN 1320-32-111-066

This indenture, made and entered into this 27th day of March, 2003, by and between Verl Gene Shoell, hereinafter referred to as Grantor, and the TOWN OF MINDEN, hereinafter referred to as Grantee, whose address is P.O. Box 205, Minden, Nevada 89423;

WITNESSETH

That for and in consideration of the sum of One Dollar (\$1.00), lawful money of the United States of America, (and other good and valuable consideration), the Grantor hereby grants to the Grantee, his successors and assigns, a permanent easement 10 feet wide for the purposes of access, drainage, landscaping and underground utilities, together with other necessary or convenient appurtenances connected therewith, across, over, and upon the following described lands and premises, situate in the County of Douglas, State of Nevada:

See Attached Legal Description

Grantor agrees that no buildings or structures shall be placed upon, over, or under said easement, now or hereafter without the express approval of the Grantee, except that said parcel may be improved and used by the Grantor or his successors or assigns for landscape or driveway purposes, and fences may be built insofar as such use does not interfere with its use by Grantee for the purposes for which this easement is granted.

It is further agreed that the Grantee shall mitigate or repair any damage to landscape, driveway, or fencing improvements of Grantor by reason of Grantee's operation, maintenance, repair or improvements within the easement area.

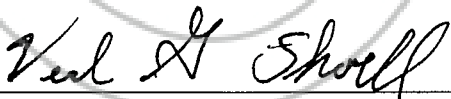

Verl Gene Shoell

0576328
BK0503PG04786

PROVINCE OF
~~STATE~~ OF ALBERTA.)
CITY) SS
~~COUNTY~~ OF RED DEER.)

On the 27th day of March, 2003, personally appeared before me, a Notary Public,
VERN GENE SHOUL, who acknowledged that he executed the above instrument.

Kevin A Beattie
Notary Public

KEVIN A. BEATTIE
Barrister and Solicitor

0576328

BK0503PG04787

MONO STREET

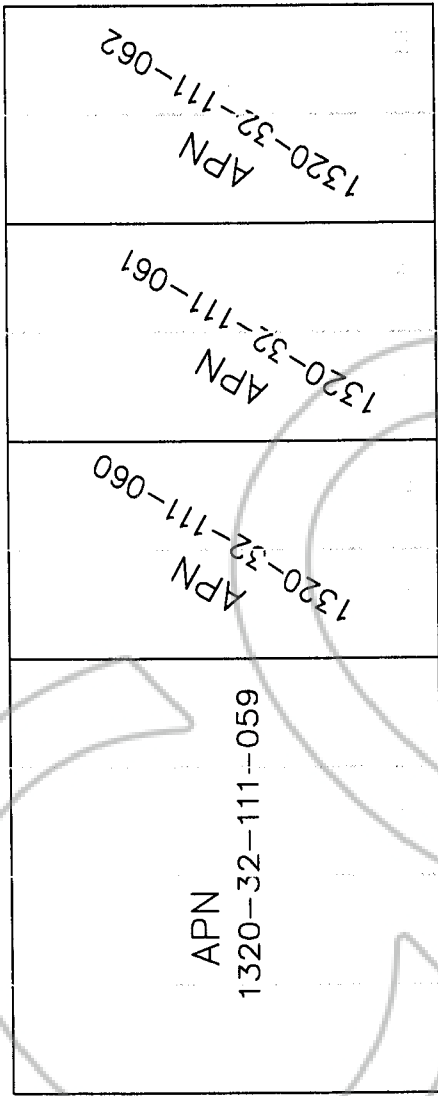

FOURTH STREET

THIRD STREET

BLOCK "K"

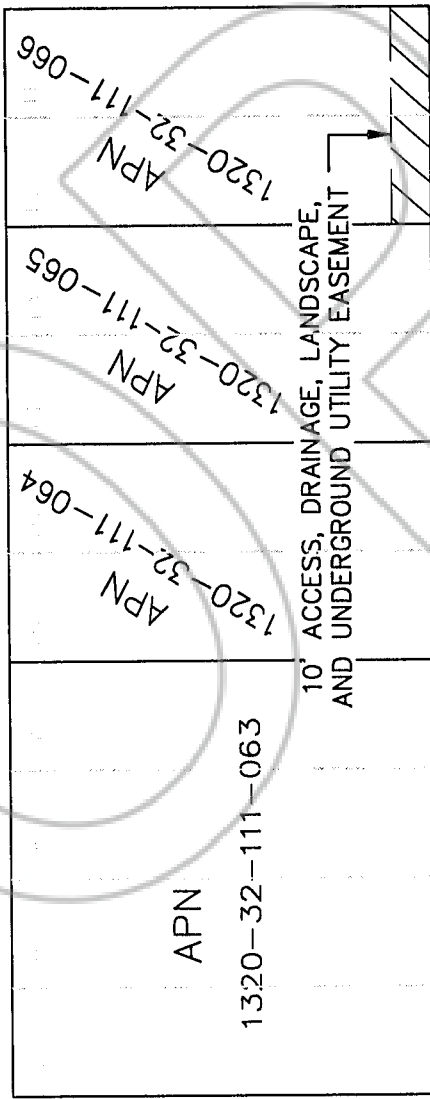

COUNTY ROAD

SHOELL
ACCESS, DRAINAGE, LANDSCAPE, AND
UNDERGROUND UTILITY EASEMENT

TOWN OF MINDEN
COUNTY ROAD IMPROVEMENT PROGRAM

RESOURCE CONCEPTS, INC.

SCALE: 1"=50'

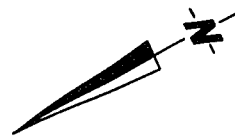

0576328

BK0503PG04788

SHOELL
APN 1320-32-111-066
ACCESS, DRAINAGE, LANDSCAPE AND UNDERGROUND UTILITY EASEMENT
LEGAL DESCRIPTION

March 23, 2003

A strip of land adjacent to the County Road right-of-way, located within a portion of Section 32, Township 13 North, Range 20 East, MDM, Douglas County, Nevada, for access, drainage, landscape, and underground utility purposes being more particularly described as follows:

A 10-foot wide strip of land whose Southwesterly line is contiguous with the Southwesterly line of Lots 11 and 12 of Block "K" as shown on the Map of Minden, accepted July 2, 1906 by the Douglas County Board of County Commissioners, and whose Northeasterly line is at right angles and parallel to said Southwesterly line of said Lots 11 and 12. Said 10-foot wide easement is also bounded by the Northwesterly right-of-way line of Third Street and the Northwesterly line of said Lot 12, as shown in the attached sketch.

Containing 500 square feet more or less.

Basis of Bearing:

Block "K" as shown on the Map of Minden, accepted July 2, 1906 by the Douglas County Board of County Commissioners.

PREPARED BY:
Bruce Scott, P.L.S. # 3579
Resource Concepts, Inc.
340 N. Minnesota
Carson City, NV 89703
(775) 883-1600

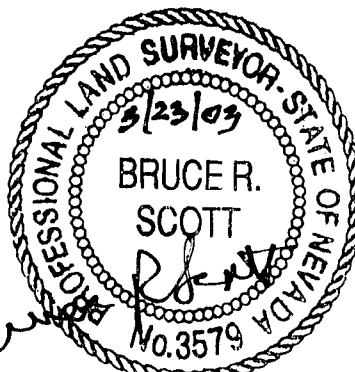

exp. 6/30/04

COPY

REQUESTED BY
Town of Minden
IN OFFICIAL RECORDS OF
DOUGLAS CO. NEVADA

2003 MAY -9 PM 2: 04

WERNER CHRISTEN
RECORDER

\$ A PAID OK DEPUTY

0576328
BK0503PG04790