

Line Table			Curve Table			
LINE #	BEARING	DISTANCE	DELTA	RADIUS	LENGTH	TANGENT
L1	N 56°04'58" E	69.60'	00°23'01"	3025.00	20.26	10.13
L2	N 89°48'06" W	9.12'	43°18'26"	60.00	23.82	45.35
L3	N 89°37'43" W	36.30'	39°42'50"	60.00	21.67	41.59
L4	N 07°02'24" E	231.40'	86°55'29"	60.00	56.86	91.03

- Legend:**
- FND POINT AS INDICATED.
 - SET 5/8" REBAR W/CAP PLS 6497
 - CALCULATED POSITION (NOTHING SET)

- Notes:**
- THERE IS A 7.5' PUBLIC UTILITY EASEMENT ALONG ALL ROAD FRONTAGES AND A 5' PUBLIC UTILITY EASEMENT ALONG ALL OTHER LOT LINES.
 - ANY FURTHER DIVISION OF THESE PARCELS MAY BE SUBJECT TO SUBDIVISION IMPROVEMENTS AS PROVIDED UNDER NRS 278.462(3).
 - DOUGLAS COUNTY DOES NOT INSURE THE DEVELOPMENT OF ANY LOT WHERE WELLS AND SEPTIC SYSTEMS ARE REQUIRED FOR WATER AND SEWER SERVICE.
 - THE USE OF AN INDIVIDUAL SEWAGE DISPOSAL SYSTEM IS FOR TEMPORARY USE ONLY. THE PARCELS SHALL CONNECT TO A COMMUNITY SEWER SYSTEM WHEN SUCH SYSTEM IS WITHIN 330 FEET OF THE PARCELS.
 - MAINTENANCE OF ALL DRAINAGE FACILITIES AND EASEMENTS SHALL BE THE RESPONSIBILITY OF THE INDIVIDUAL PROPERTY OWNERS OR OTHER PRIVATE ENTITY, INCLUDING A HOMEOWNER'S ASSOCIATION. DOUGLAS COUNTY REJECTS ANY OFFER OF DEDICATION OF DRAINAGE FACILITIES OR DRAINAGE EASEMENTS.
 - OBSTRUCTING THE FLOW OR ALTERING THE COURSE OF A DRAINAGE CHANNEL IS PROHIBITED.
 - TOTAL AREA SURVEYED IS 10,200 ACRES.

Basis of Bearing:
 THE SOUTH LINE OF THE LAXAGUE PARCEL AS SHOWN ON THE RECORD OF SURVEY FOR JOHN AND JODY LAXAGUE, DOCUMENT #142028, OF THE DOUGLAS COUNTY RECORDER'S OFFICE (S 89°48'06" E)

Owner's Certificate
 WE, JOHN & ANDRAE JO (JODY) LAXAGUE, CERTIFY THAT WE ARE THE LEGAL OWNERS OF THIS PARCEL AND DO HEREBY GRANT PERMANENT EASEMENTS FOR UTILITY INSTALLATION AS DESIGNATED ON THIS MAP, AND CONSENT TO THE PREPARATION AND RECORDING OF THIS MAP.
 JOHN LAXAGUE ANDRAE JO (JODY) LAXAGUE

STATE OF Nevada COUNTY OF Douglas S.S.
 ON THIS 22nd DAY OF April, 2003, PERSONALLY APPEARED BEFORE ME, A NOTARY PUBLIC, JOHN LAXAGUE, PERSONALLY KNOWN (OR PROVED) TO ME TO BE THE PERSON WHOSE NAME IS SUBSCRIBED TO THE ABOVE INSTRUMENT WHO ACKNOWLEDGED HE EXECUTED IT.
 JANICE K. CONDON
 NOTARY PUBLIC JANICE K. CONDON
 STATE OF Nevada COUNTY OF Douglas S.S.
 ON THIS 22nd DAY OF April, 2003, PERSONALLY APPEARED BEFORE ME, A NOTARY PUBLIC, ANDRAE JO (JODY) LAXAGUE, PERSONALLY KNOWN (OR PROVED) TO ME TO BE THE PERSON WHOSE NAME IS SUBSCRIBED TO THE ABOVE INSTRUMENT WHO ACKNOWLEDGED HE EXECUTED IT.
 JANICE K. CONDON
 NOTARY PUBLIC JANICE K. CONDON

Surveyor's Certificate
 I, DARRYL M. HARRIS, A PROFESSIONAL LAND SURVEYOR LICENSED IN THE STATE OF NEVADA, CERTIFY THAT:
 1. THIS PLAT REPRESENTS THE RESULTS OF A SURVEY CONDUCTED UNDER MY DIRECT SUPERVISION AT THE INSTANCE OF JOHN & ANDRAE JO (JODY) LAXAGUE.
 2. THE LAND SURVEYED LIES WITHIN A PORTION OF SECTION 34, T.13 N., R.20 E., M.D.M., AND THE SURVEY WAS COMPLETED ON APRIL 4, 2003.
 3. THIS PLAT COMPLIES WITH THE APPLICABLE STATE STATUTES AND ANY LOCAL ORDINANCE IN EFFECT ON THE DATE THAT THE GOVERNING BODY GAVE ITS FINAL APPROVAL.
 4. THE MONUMENTS DEPICTED ON THE PLAT ARE OF THE CHARACTER SHOWN, OCCUPY THE POSITIONS INDICATED AND ARE OF SUFFICIENT NUMBER AND DURABILITY.

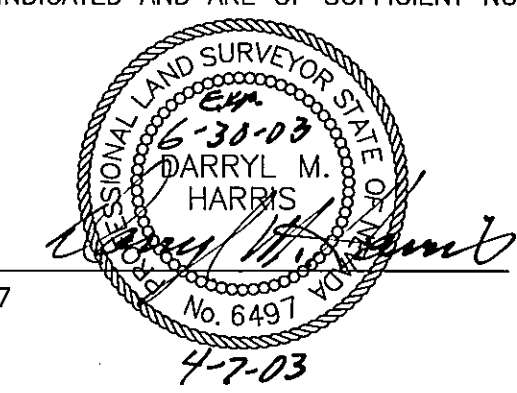

County Tax Collector's Certificate
 I, BARBARA J. REED, DOUGLAS COUNTY CLERK-TREASURER AND EX-OFFICIO TAX COLLECTOR, DO HEREBY CERTIFY THAT ALL PROPERTY TAXES ON THIS LAND FOR THE FISCAL YEAR HAVE BEEN PAID.
 BARBARA J. REED 5/12/03
 DOUGLAS COUNTY CLERK-TREASURER

County Clerk's Certificate
 IT IS HEREBY CERTIFIED THAT THIS PLAT WAS PRESENTED TO THE DEPARTMENT OF COMMUNITY DEVELOPMENT ON THE 12th DAY OF MAY, 2003, AND WAS DULY APPROVED. THERE ARE NO PUBLIC ROADS OFFERED FOR DEDICATION AS PART OF THIS MAP.

Community Development Department Certificate
 IT IS HEREBY CERTIFIED THAT THIS PLAT WAS REVIEWED AND APPROVED BY THE DOUGLAS COUNTY DEPARTMENT OF COMMUNITY DEVELOPMENT ON THE 12th DAY OF MAY, 2003. THIS PLAT IS IN SUBSTANTIAL CONFORMANCE WITH THE TENTATIVE MAP AND ALL CONDITIONS OF APPROVAL HAVE BEEN SATISFIED. THERE ARE NO PUBLIC ROADS OFFERED FOR DEDICATION AS PART OF THIS MAP.
 Barbara J. Reed 5/12/03
 BARBARA J. REED
 DOUGLAS COUNTY CLERK-TREASURER

Title Certificate
 THIS IS TO CERTIFY THAT THE PARTIES AS LISTED WITHIN THE OWNERS CERTIFICATE ARE THE ONLY PARTIES OF RECORD HAVING INTEREST IN THE TRACTS OF LAND EMBRACED WITHIN THE GRAPHIC BORDER SHOWN ON THIS PLAT. THE FOLLOWING IS A COMPLETE LIST OF LIEN AND/OR HOLDERS OF RECORD. None
 Janice K. Condon 3-25-03
 STEWART TITLE JANICE K. CONDON DATE
 020507582

County Engineer's Certificate
 I, CARL RUSCHMEYER, DOUGLAS COUNTY ENGINEER, DO HEREBY CERTIFY THAT I HAVE EXAMINED THIS MAP; AND ALL PHYSICAL IMPROVEMENTS AS REQUIRED BY THE PARCEL MAP REGULATIONS HAVE BEEN COMPLETED; AND I AM SATISFIED THAT THIS MAP IS TECHNICALLY CORRECT.
 Carl Ruschmeyer 5/12/03
 CARL RUSCHMEYER, P.E. DATE
 DOUGLAS COUNTY ENGINEER

Utility Companies' Certificate
 WE, THE UNDERSIGNED PUBLIC UTILITIES, ACCEPT AND APPROVE THE PUBLIC UTILITY EASEMENT AS SHOWN ON THIS PLAT. THIS APPROVAL DOES NOT GUARANTEE ACCESSIBILITY FOR SERVICE.
 Michael Price 4-21-03
 MICHAEL PRICE
 SIERRA PACIFIC POWER COMPANY DATE
 Debbie Payne 4-22-03
 DEBBIE PAYNE
 VERIZON DATE

Recorder's Certificate
 FILED FOR RECORD THIS 13th DAY OF MAY, 2003, AT 32 MINUTES PAST 2 O'CLOCK P.M., IN BOOK 0503 OF OFFICIAL RECORDS, AT PAGE 4305; DOCUMENT NO. 576607 RECORDED AT THE REQUEST OF JOHN LAXAGUE.
 Barbara Clark, Deputy
 DOUGLAS COUNTY RECORDER

FINAL PARCEL MAP (LDA 02-066)
 FOR
John & Andrae Jo (Jody) Laxague
 PORTION OF THE WEST 1/2 OF SECTION 34
 T. 13 N., R. 20 E., M.D.M.
 DOUGLAS COUNTY, NEVADA

ENGINEERING • PLANNING • RESOURCE MANAGEMENT
RESOURCE CONCEPTS, INC.
 340 N. MINNESOTA STREET • CARSON CITY, NEVADA 89703-4152 • OFFICE: 775-883-1600 • FAX: 775-883-1656 • WEB SITE: www.rci-ny.com

REVISION	DATE

JOB NO. 01-069-01
 DATE 04/07/03
 DRAWN DMH
 CHECKED DMH
 SHEET 1 OF 1