

A.P.N. # 1319-30-517-004

R.P.T.T. \$ #6
ESCROW NO. 030200625

RECORDING REQUESTED BY:
STEWART TITLE COMPANY
WHEN RECORDED MAIL TO:
MAIL TAX STATEMENTS TO:

Jeffrey K. Nakamura
P.O. Box 6093
Stateline, NV 89449

GRANT, BARGAIN, SALE DEED

THIS INDENTURE WITNESSETH: That **MICHELLE J. NAKAMURA**

in consideration of \$10.00, the receipt of which is hereby acknowledged, does hereby Grant, Bargain Sell and Convey to **JEFFREY K. NAKAMURA , A MARRIED MAN AS HIS SOLE AND SEPARATE PROPERTY**

and to the heirs and assigns of such Grantee forever, all that real property situated in the **unincorporated area** County of **DOUGLAS** State of Nevada, bounded and described as follows:

See Exhibit "A" attached hereto and by reference made a part hereof for complete legal description.

IT IS THE EXPRESS INTENT OF THE GRANTOR, BEING THE SPOUSE OF THE GRANTEE, TO CONVEY ALL RIGHT, TITLE AND INTEREST OF THE GRANTOR, COMMUNITY OR OTHERWISE, IN AND TO THE HEREIN DESCRIBED PROPERTY TO THE GRANTEE AS GRANTEE'S SOLE AND SEPARATE PROPERTY.

Together with all and singular the tenements, hereditaments and appurtenances thereunto belonging or in anywise appertaining, and any reversions, remainders, rents, issues or profits thereof.

DATE: **April 29, 2003**

Michelle J. Nakamura

MICHELLE J. NAKAMURA

STATE OF California }
COUNTY OF Los Angeles } ss.

This instrument was acknowledged before me on May 13, 2003,
by, MICHELLE J. NAKAMURA

Signature *[Signature]*
Notary Public

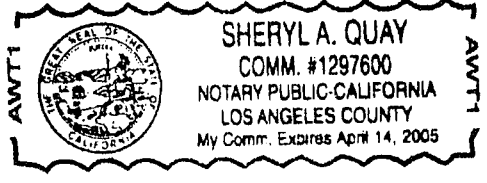

0578042
BK 0503 PG 13450

EXHIBIT "A"

LEGAL DESCRIPTION

ESCROW NO.: 030200625

Unit 4, as set forth on the Condominium map of Lot 8, Amended Map of TAHOE VILLAGE UNIT NO. 1, filed for record August 27, 1979, in Book 879, Page 1950, as Document No. 36006, Official Records of Douglas County, State of Nevada.

TOGETHER WITH and undivided 1/4th interest in and to those portions designated as Common Area as set forth on the Condominium Map of Lot 8, amended map of TAHOE VILLAGE NO. 1, filed for record August 27, 1979, in Book 879, Page 1950, Document No. 36006, Official Records of Douglas County, State of Nevada.

Assessment Parcel No. 1319-30-517-004

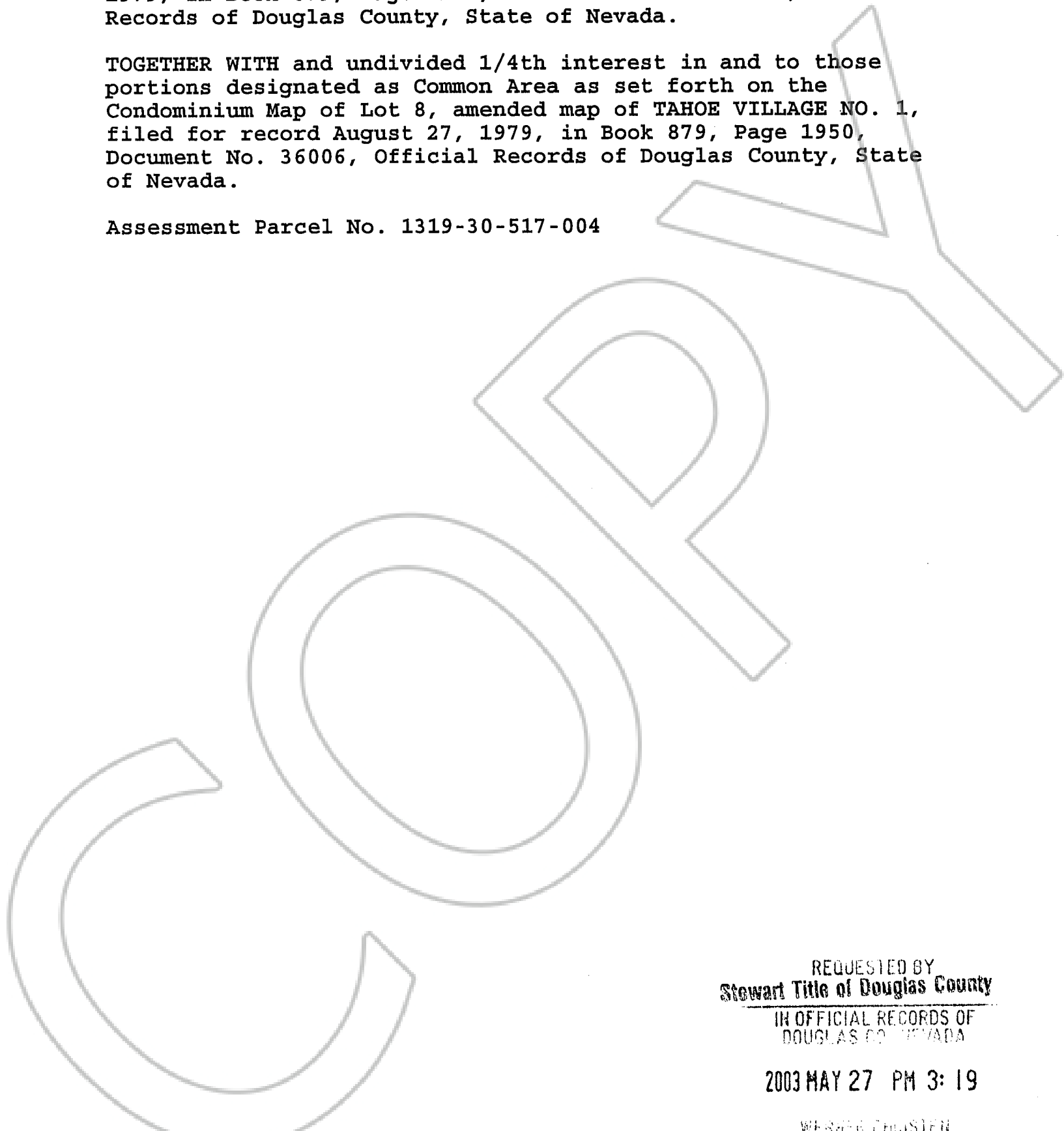

REQUESTED BY
Stewart Title of Douglas County

IN OFFICIAL RECORDS OF
DOUGLAS COUNTY, NEVADA

2003 MAY 27 PM 3: 19

WERNER CHRISTEN
RECORDER

\$15⁰⁰ PAID *KJ* DEPUTY

0578042

BK0503PG13451