

APN: 1220-15-511-007  
R.P.T.T. #3  
ORDER NO. 030501397  
WHEN RECORDED MAIL TO:  
George Gutierrez  
975 Birdie Court  
Gardnerville, NV 89460

**BOUNDARY LINE ADJUSTMENT  
GRANT, BARGAIN, SALE DEED**

**THIS INDENTURE WITNESSETH:** GARY S. DOVE AND DEBORAH S. DOVE, Trustees of the DOVE FAMILY REVOCABLE TRUST DATED SEPTEMBER 7, 2000, in consideration of \$10.00, the receipt of which is hereby acknowledged, does hereby Grant, Bargain Sell and Convey to GEORGE GUTIERREZ AND SALLY GUTIERREZ, husband and wife as joint tenants, AND TO THE HEIRS AND ASSIGNS OF SUCH Grantee forever, all that real property situated in the County of Douglas, State of Nevada, bounded and described as follows:

**SEE EXHIBIT "A" ATTACHED HERETO AND MADE A PART HEREOF**

Date: 4-11-03

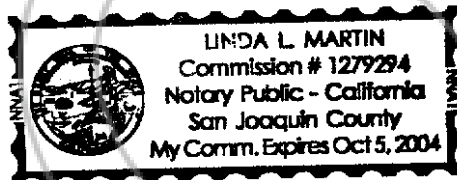

Gary S. Dove  
GARY S. DOVE, TRUSTEE

Deborah S. Dove  
DEBORAH S. DOVE, TRUSTEE

STATE OF NEVADA } ss.  
COUNTY OF DOUGLAS }

This instrument was acknowledged before me on 4-11-03,  
By, Gary S. Dove & Deborah S. Dove

Signature Linda L. Martin  
Notary Public

0579629  
BK0603PG04674

**EXHIBIT "A"**  
**LEGAL DESCRIPTION**  
**(Portion of Lot 10)**

That portion of Section 15, Township 12 North, Range 20 East, M.D.B. & M. in the County of Douglas, State of Nevada, being more particularly described as follows:

That portion of Lot 10 of that certain Record of Survey for Paul Little, recorded in Book 382 at Page 229 as Document No. 65531 in the Official Records of said Douglas County described as follows:

Beginning at the most Easterly corner of said Lot 10; thence Southwesterly along the Southeasterly line of said Lot 10, S. 17° 34' 43" W., 147.62 feet; thence N. 0° 21' 34" W., 243.61 feet to a point on the Northeasterly line of said Lot 10; thence Southeasterly along said Northeasterly line S. 24° 08' 30" E., 112.74 feet to the Point of Beginning.

Said Parcel Contains 5538 s.f., more or less.

Per NRS 111.312, this legal description was prepared by Western Engineering & Surveying Services, whose mailing address is 3032 Silver Sage Drive, Carson City, Nevada 89701.

By: David D. Winchell  
David D. Winchell, PLS 3709

Dated: 4/03/03

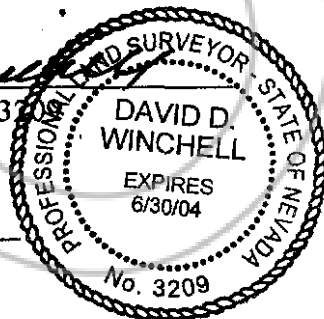

REQUESTED BY  
**STEWART TITLE of DOUGLAS COUNTY**  
IN OFFICIAL RECORDS OF  
DOUGLAS CO., NEVADA

2003 JUN 10 PM 3: 33

WERNER CHRISTEN  
RECORDER

\$ 15<sup>00</sup> PAID Kg DEPUTY

0579629

BK 0603 PG 04675

APN: 1220-15-511-007  
R.P.T.T. #3  
ORDER NO. 030501397  
WHEN RECORDED MAIL TO:  
George Gutierrez  
975 Birdie Court  
Gardnerville, NV 89460

**BOUNDARY LINE ADJUSTMENT  
GRANT, BARGAIN, SALE DEED**

**THIS INDENTURE WITNESSETH:** GARY S. DOVE AND DEBORAH S. DOVE, Trustees of the DOVE FAMILY REVOCABLE TRUST DATED SEPTEMBER 7, 2000, in consideration of \$10.00, the receipt of which is hereby acknowledged, does hereby Grant, Bargain Sell and Convey to GEORGE GUTIERREZ AND SALLY GUTIERREZ, husband and wife as joint tenants, AND TO THE HEIRS AND ASSIGNS OF SUCH Grantee forever, all that real property situated in the County of Douglas, State of Nevada, bounded and described as follows:

**SEE EXHIBIT "A" ATTACHED HERETO AND MADE A PART HEREOF**

Date: 4-11-03

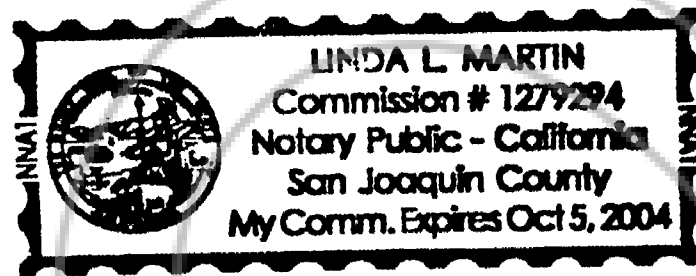

*Gary S. Dove*  
\_\_\_\_\_  
GARY S. DOVE, TRUSTEE  
*Deborah S. Dove*  
\_\_\_\_\_  
DEBORAH S. DOVE, TRUSTEE

STATE OF NEVADA } ss.  
COUNTY OF DOUGLAS }

This instrument was acknowledged before me on 4-11-03,  
By, Gary S. Dove & Deborah S. Dove

Signature Linda L. Martin  
Notary Public

0579629  
BK0603PG04674

**EXHIBIT "A"**

**LEGAL DESCRIPTION  
(Portion of Lot 10)**

That portion of Section 15, Township 12 North, Range 20 East, M.D.B. & M. in the County of Douglas, State of Nevada, being more particularly described as follows:

That portion of Lot 10 of that certain Record of Survey for Paul Little, recorded in Book 382 at Page 229 as Document No. 65531 in the Official Records of said Douglas County described as follows:

Beginning at the most Easterly corner of said Lot 10; thence Southwesterly along the Southeasterly line of said Lot 10, S. 17° 34' 43" W., 147.62 feet; thence N. 0° 21' 34" W., 243.61 feet to a point on the Northeasterly line of said Lot 10; thence Southeasterly along said Northeasterly line S. 24° 08' 30" E., 112.74 feet to the Point of Beginning.

Said Parcel Contains 5538 s.f., more or less.

Per NRS 111.312, this legal description was prepared by Western Engineering & Surveying Services, whose mailing address is 3032 Silver Sage Drive, Carson City, Nevada 89701.

By: David D. Winchell  
David D. Winchell, PLS 3209

Dated: 4/03/03

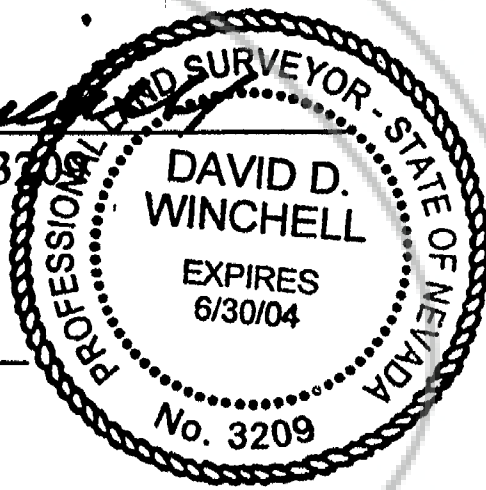

REQUESTED BY  
**STEWART TITLE of DOUGLAS COUNTY**  
IN OFFICIAL RECORDS OF  
DOUGLAS CO. NEVADA

2003 JUN 10 PM 3: 33

WERNER CHRISTEN  
RECORDER

\$ 15.00 PAID KJ DEPUTY

0579629

BK 0603 PG 04675

