



**EXHIBIT "A"**

**LEGAL DESCRIPTION**

ESCROW NO.: 030101255

Being a portion of the Southwest 1/4 of Section 1, Township 12 North, Range 20 East further described as follows:

Lot 23, in Block C, as set forth on the Final Map #PD01-19 for STERLING RANCH ESTATES, A PLANNED UNIT DEVELOPMENT, filed for record in the Office of the County Recorder of Douglas County, State of Nevada, September 17, 2002, Book 0902, Page 5372, as Document No. 552347, and by Certificate of Amendment recorded March 26, 2003, Book 0303, Page 12541, as Document No. 571358.

ASSESSORS PARCEL NUMBER: 1220-01-002-045

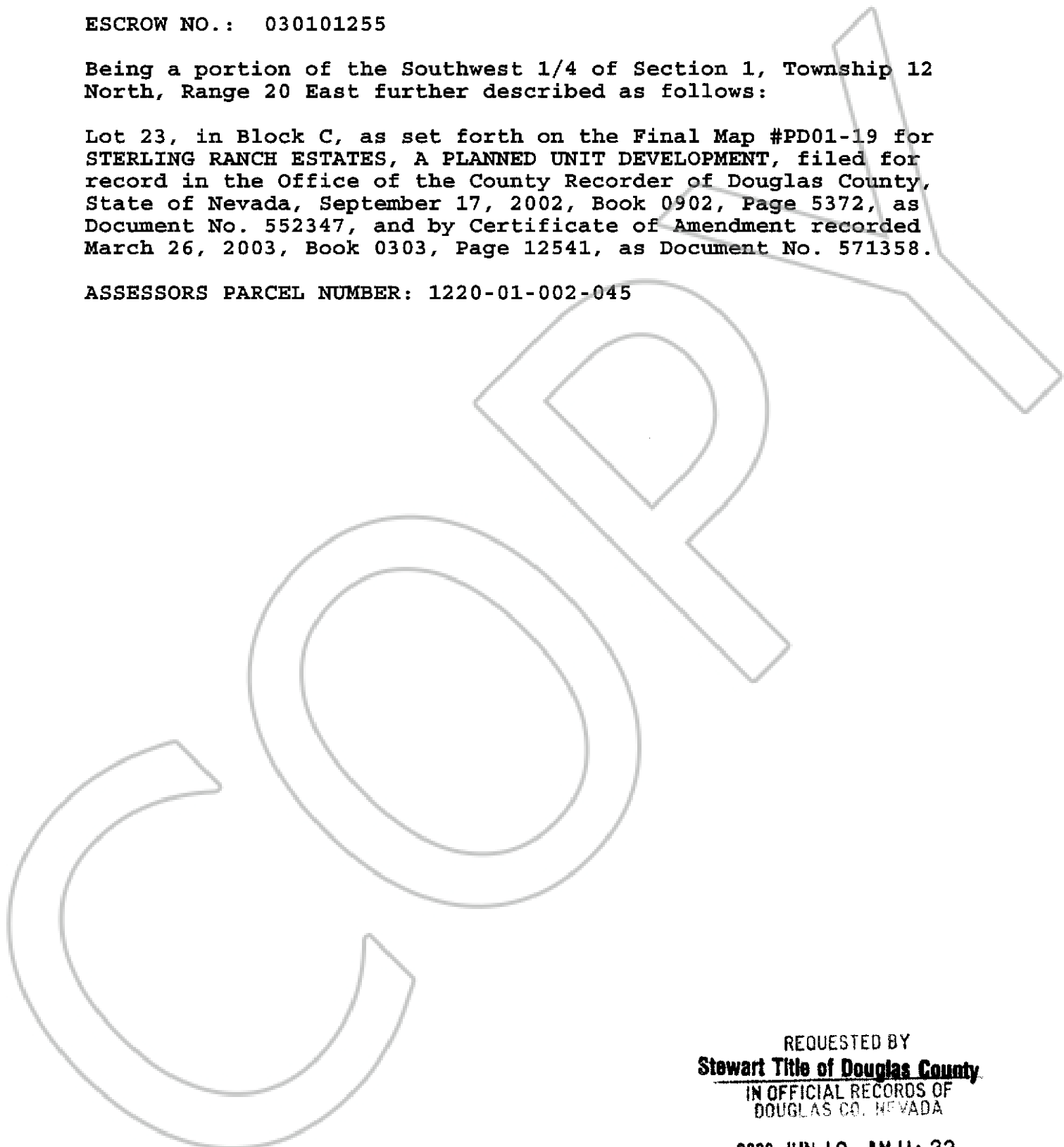

REQUESTED BY  
**Stewart Title of Douglas County**  
IN OFFICIAL RECORDS OF  
DOUGLAS CO. NEVADA

2003 JUN 19 AM 11:32

WERNER CHRISTEN  
RECORDER

\$ 15<sup>00</sup> PAID *KJ* DEPUTY

**0580592**

**BK 0603 PG 09886**