

EXHIBIT "A"

LEGAL DESCRIPTION

ESCROW NO.: 020209109

Unit 2 of Lot 23 Condominiums, as set forth on Sheet 7 of the Third Amended Map of Tahoe Village, Unit No. 2, filed for record August 14, 1979, as Document No. 35555, Official Records of Douglas County, State of Nevada.

TOGETHER WITH an undivided 1/18ths interest in and to those areas designated as Common Areas as set forth on the map of Lot 23 Condominiums as set forth on Sheet 7 of the Third Amended Map of Tahoe Village Unit No. 2, filed for record August 14, 1979, as Document No. 35555, Official Records of Douglas County, State of Nevada.

Assessors Parcel No. 1319-30-710-002

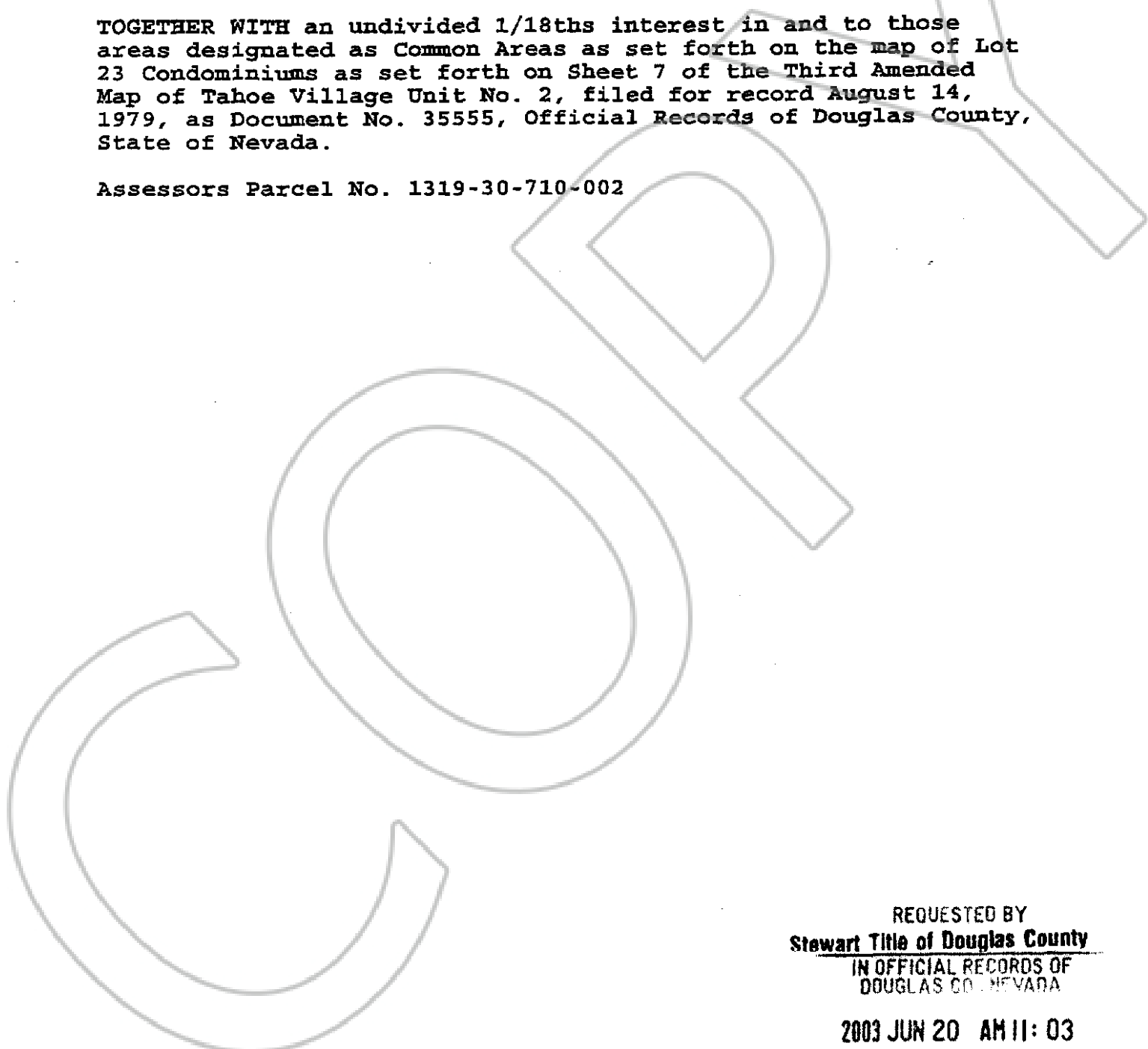

REQUESTED BY
Stewart Title of Douglas County
IN OFFICIAL RECORDS OF
DOUGLAS CO. NEVADA

2003 JUN 20 AM 11:03

WERNER CHRISTEN
RECORDER

\$ 15⁰⁰ PAID *Bl* DEPUTY

0580749

BK0603PG10669