

A.P.N. # 1220-13-801-004
MINDEN, NV 89423
ESCROW NO. 030801566
RECORDING REQUESTED BY:
STEWART TITLE COMPANY

WHEN RECORDED MAIL TO:
JOHN FENT
P.O. BOX 1914
MINDEN, NV 89423

(Space Above for Recorder's Use Only)

NOTICE OF COMPLETION

Must be filed within 15 days after completion NRS 108.228

Individual or Corporation

NOTICE IS HEREBY GIVEN:

1. That the interest or estate stated in paragraph 3 below in the real property hereinafter described is owned by the following:

NAME	STREET AND NO.	CITY	STATE
JOHN FENT	P.O. BOX 1914	MINDEN, NV	89423

(If more than one owner of the interest stated, the name and address of each must be inserted.)

SHELLY FENT	P.O. BOX 1914		
-------------	---------------	--	--

2. That the full name and address of the owner of said interest or estate, if there is only one owner, and the full names and addresses of all the co-owners who own said interest or estate as joint tenants, as tenants in common or otherwise, if there is more than one owner, are set forth in the preceding paragraph.

3. That the nature of the title of said owner, or if more than one, then of said owner and co-owners is: In Fee.

(If other than fee, strike out "In Fee" and insert for example "purchase under contract of purchase" or "lessee.")

4. That on the 20th day of May, 2003 a work of improvement on the real property hereinafter described was completed.

5. That the name of the original contractor, if any, for such work of improvement was JOHN FENT

(If no contractor for work of improvement as a whole, insert "No Contractor.")

That the real property herein referred to is situated in the City of Gardnerville
County of DOUGLAS, State of Nevada and is described as follows:

See Exhibit "A" attached hereto and by reference made a part hereof for complete legal description.
Commonly known as: 1890 PINTO CIRCLE, GARDNERVILLE, NV 89410

Read this note before signing.

If more than one owner, only one need sign, personally or by an agent. The owner or agent who signs the notice itself must also sign the verification below.

BY JOHN FENT

VERIFICATION

The undersigned being duly sworn, says: That he/she/they read the foregoing notice and knows the contents thereof and the same is true of his/her/their own knowledge.

STATE OF NEVADA
COUNTY OF DOUGLAS } ss.

BY JOHN FENT

This instrument was acknowledged before me on 6/30/03,
by, JOHN FENT

Signature

Traci E. Adams

Notary Public (One inch Margin on all sides of document for Recorder's Use ONLY)

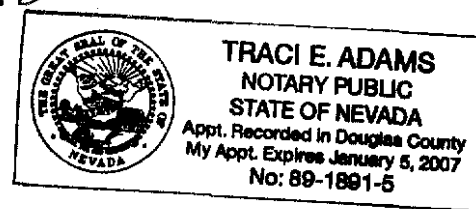

0580800

BK0603PG10937

EXHIBIT "A"

LEGAL DESCRIPTION

ESCROW NO.: 030801566

Lot 1 as set forth on that certain Parcel Map for Tilley filed for record in the office of the County Recorder of Douglas County, Nevada, on January 8, 1980, in Book 180, Page 376, as Document No. 40420.

ASSESSOR'S PARCEL NO. 1220-13-801-004

COPY

REQUESTED BY
Stewart Title of Douglas County
IN OFFICIAL RECORDS OF
DOUGLAS CO. NEVADA

2003 JUN 20 PM 3: 25

WERNER CHRISTEN
RECORDER

\$15⁰⁰ PAID *KJ* DEPUTY

0580800

BK 0603 PG 10938

A.P.N. # 1220-13-801-004
MINDEN, NV 89423
ESCROW NO. 030801566
RECORDING REQUESTED BY:
STEWART TITLE COMPANY

WHEN RECORDED MAIL TO:
JOHN FENT
P.O. BOX 1914
MINDEN, NV 89423

(Space Above for Recorder's Use Only)

NOTICE OF COMPLETION
Must be filed within 15 days after completion NRS 108.228
Individual or Corporation

NOTICE IS HEREBY GIVEN:

1. That the interest or estate stated in paragraph 3 below in the real property hereinafter described is owned by the following:

NAME	STREET AND NO.	CITY	STATE
JOHN FENT	P.O. BOX 1914	MINDEN, NV	89423
(If more than one owner of the interest stated, the name and address of each must be inserted.)			
SHELLY FENT	P.O. BOX 1914		

2. That the full name and address of the owner of said interest or estate, if there is only one owner, and the full names and addresses of all the co-owners who own said interest or estate as joint tenants, as tenants in common or otherwise, if there is more than one owner, are set forth in the preceding paragraph.
3. That the nature of the title of said owner, or if more than one, then of said owner and co-owners is: In Fee.

(If other than fee, strike out "In Fee" and insert for example "purchase under contract of purchase" or "lessee.")

4. That on the 20th day of May, 2003 a work of improvement on the real property hereinafter described was completed.

5. That the name of the original contractor, if any, for such work of improvement was JOHN FENT

(If no contractor for work of improvement as a whole, insert "No Contractor.")

That the real property herein referred to is situated in the City of Gardnerville County of DOUGLAS, State of Nevada and is described as follows:

See Exhibit "A" attached hereto and by reference made a part hereof for complete legal description. Commonly known as: 1890 PINTO CIRCLE, GARDNERVILLE, NV 89410

Read this note before signing.

If more than one owner, only one need sign, personally or by an agent. The owner or agent who signs the notice itself must also sign the verification below.

BY JOHN FENT

VERIFICATION

The undersigned being duly sworn, says: That he/she/they read the foregoing notice and knows the contents thereof and the same is true of his/her/their own knowledge.

STATE OF NEVADA } ss.

BY JOHN FENT

COUNTY OF DOUGLAS

This instrument was acknowledged before me on 6/30/03 by, JOHN FENT

Signature Traci E. Adams

Notary Public (One inch Margin on all sides of document for Recorder's Use ONLY)

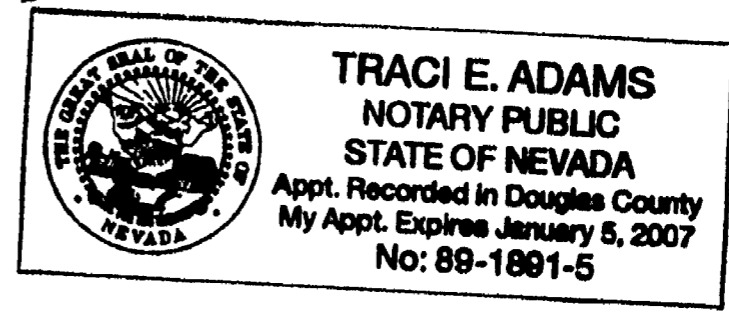

0580800

BK0603PG10937

EXHIBIT "A"

LEGAL DESCRIPTION

ESCROW NO.: 030801566

Lot 1 as set forth on that certain Parcel Map for Tilley filed for record in the office of the County Recorder of Douglas County, Nevada, on January 8, 1980, in Book 180, Page 376, as Document No. 40420.

ASSESSOR'S PARCEL NO. 1220-13-801-004

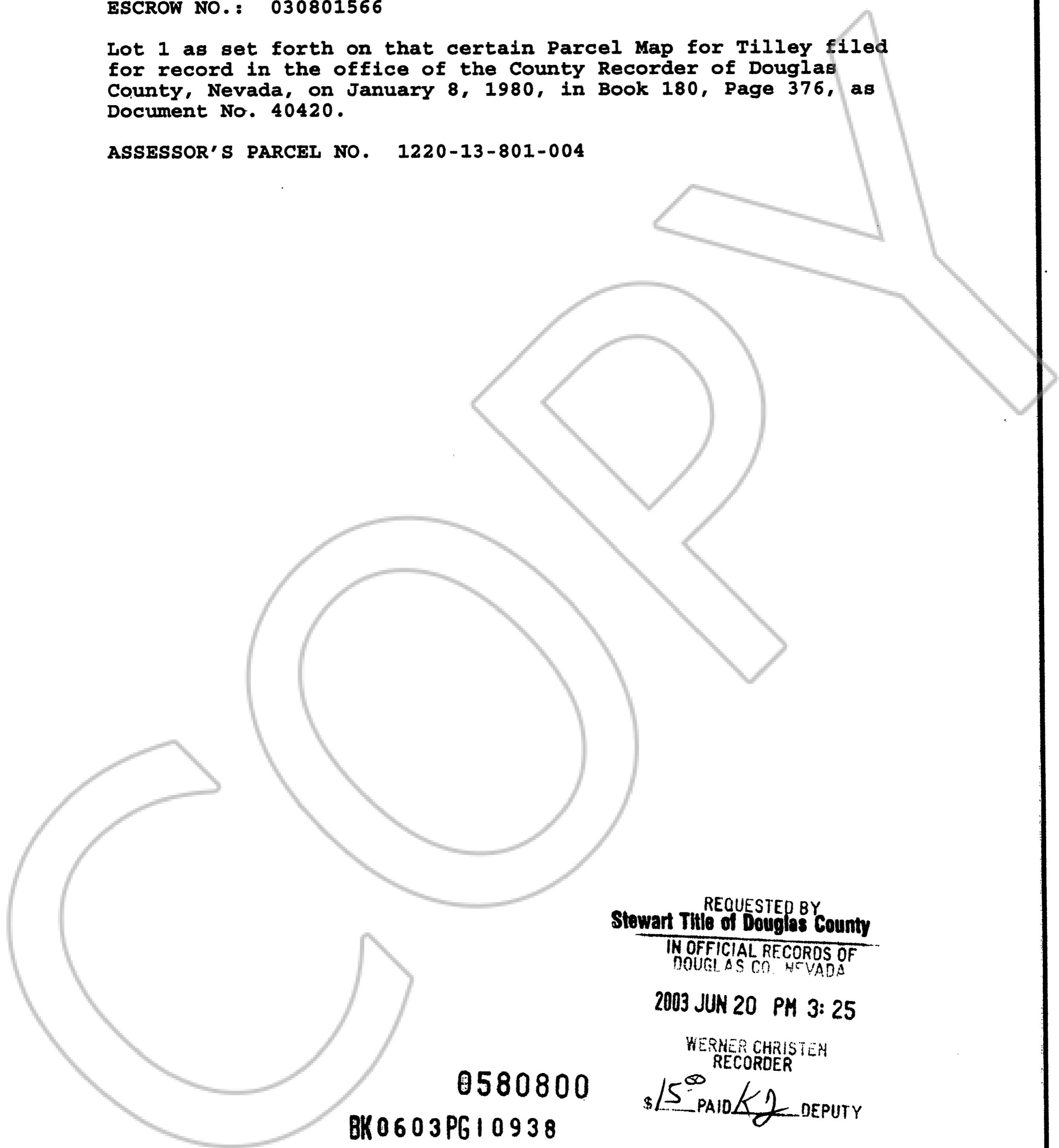

REQUESTED BY
Stewart Title of Douglas County
IN OFFICIAL RECORDS OF
DOUGLAS CO. NEVADA

2003 JUN 20 PM 3: 25

WERNER CHRISTEN
RECORDER

\$15⁰⁰ PAID *KJ* DEPUTY

0580800

BK0603PG10938

