



Recording Requested by  
and Return to:

Don L. Ross, Esq.  
Woodburn and Wedge  
P.O. Box 2311  
Reno, NV 89505

Send Tax Statements To Grantee:

CENTERVILLE BUILDING, LLC  
1390 Centerville Lane  
Gardnerville, NV 89410

COPY

**EXHIBIT "A"**

A Parcel of land situated in and being a portion of the NE 1/4 of Section 5, Township 12 North, Range 20 East, M.D.B.&M., described as follows:

Parcel No. 1, as set forth on that certain Parcel Map for Walter G. Lund and Carol E. Lund filed for record in the office of the County Recorder of Douglas County, Nevada, on December 27, 1977, as Document No. 16135.

This legal description was taken from Grant, Bargain and Sale Deed recorded August 13, 1986 as Document #139028, Book 886, Page 1359.

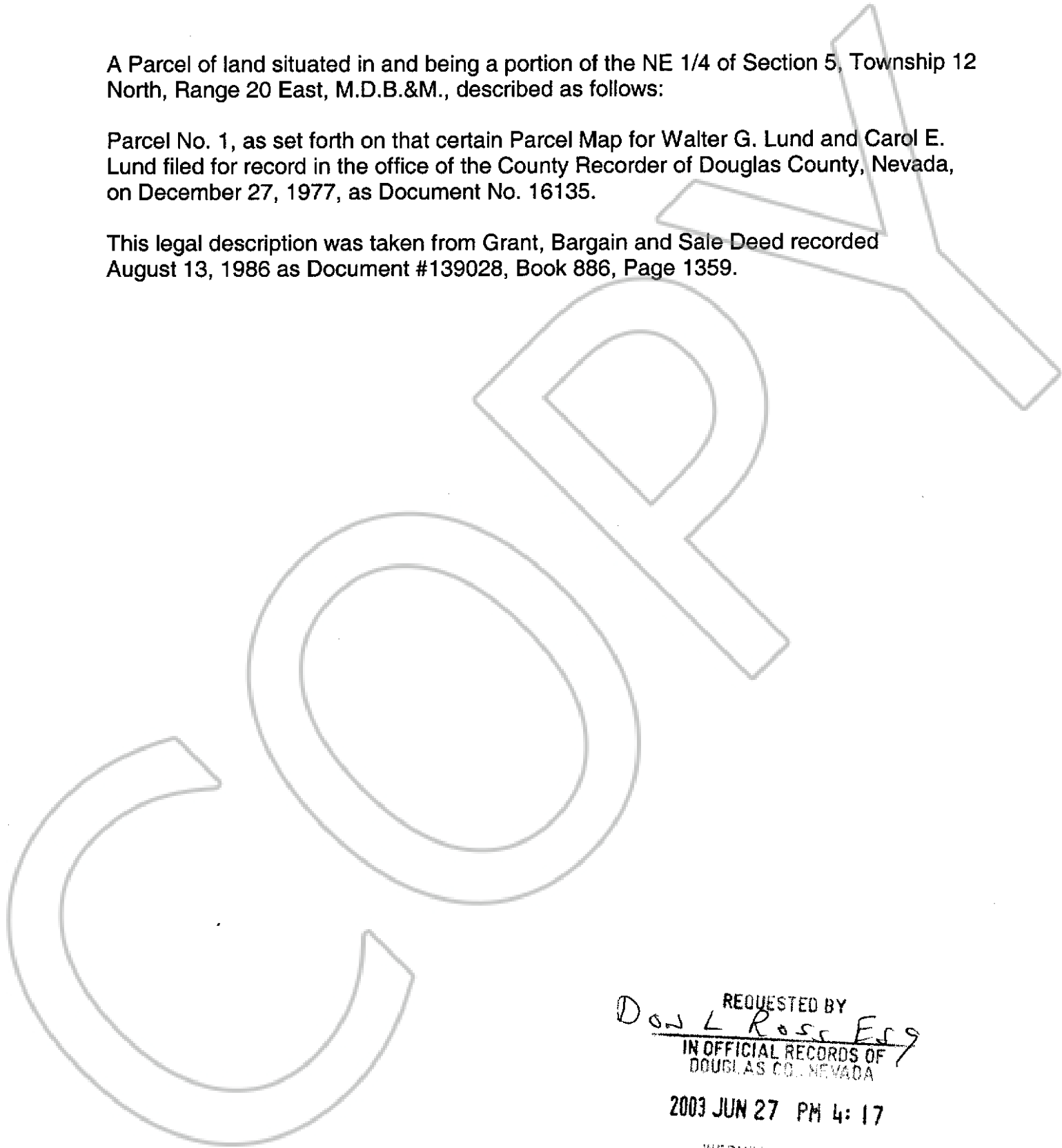

REQUESTED BY  
*Dan L. Rose Esq*  
IN OFFICIAL RECORDS OF  
DOUGLAS CO., NEVADA

2003 JUN 27 PM 4:17

WERNER CHRISTER  
RECORDER

*16* PAID *KJ* DEPUTY

3

0581794

BK0603PG16087