

A.P.N. # 1320-31-511-010

R.P.T.T. \$ 515.45  
ESCROW NO. 030801563

RECORDING REQUESTED BY:  
**STEWART TITLE COMPANY**  
MAIL TAX STATEMENTS TO:  
**SAME AS BELOW**

WHEN RECORDED MAIL TO:  
**GRANTEE**  
617 VICTORIA COURT  
GARDNERVILLE, NV 89460

REQUESTED BY  
**Stewart Title of Douglas County**  
IN OFFICIAL RECORDS OF  
DOUGLAS CO., NEVADA  
2003 JUL -1 PM 4:00  
WERNER CHRISTEN  
RECORDER  
\$ 40<sup>00</sup> PAID RL DEPUTY

(Space Above for Recorder's Use Only)

**GRANT, BARGAIN, SALE DEED**

THIS INDENTURE WITNESSETH: That **ALAN S. THOMSON AND GERALDINE M. THOMSON, HUSBAND AND WIFE** AS JOINT TENANTS

in consideration of \$10.00, the receipt of which is hereby acknowledged, does hereby Grant, Bargain Sell and Convey to  
**ROBERT S. PARKS AND LAURA A. PARKS, HUSBAND AND WIFE**  
AS JOINT TENANTS

and to the heirs and assigns of such Grantee forever, all that real property situated in the  
County of **Douglas** State of Nevada, bounded and described as follows:

**SEE EXHIBIT "A" ATTACHED HERETO AND MADE A PART HEREOF**

Together with all and singular the tenements, hereditaments and appurtenances thereunto belonging or in anywise appertaining, and any reversions, remainders, rents, issues or profits thereof.

DATE: **May 29, 2003**

Alan S. Thomson  
**ALAN S. THOMSON**  
Geraldine M. Thomson  
**GERALDINE M. THOMSON**

STATE OF NEVADA }  
   } ss.  
COUNTY OF DOUGLAS }

This instrument was acknowledged before me on 6/4/2003,  
by ALAN S. THOMSON and GERALDINE M. THOMSON

Signature *Charlene L. Hanover*

(Space Below for Recorder's Use Only)

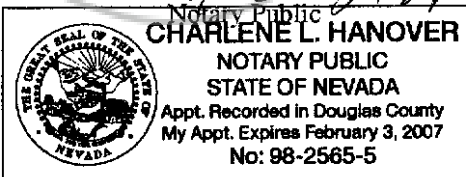

**0582271**  
**BK0703PG00639**

**EXHIBIT "A"**

**LEGAL DESCRIPTION**

ESCROW NO.: 030801563

All that certain lot, piece or parcel of land situate in the County of Douglas, State of Nevada, described as follows:

Lot 6, Block C, as set forth on the Official Plat of MACKLAND SUBDIVISION, filed in the Office of the County Recorder on December 4, 1980, Book 1280, Page 475, Document No. 51372, and by Certificate of Amendment recorded November 7, 1984, Book 1184, Page 510, Document No. 109722, both instruments of Official Records of Douglas County, Nevada.

Assessment Parcel No. 1320-31-511-010

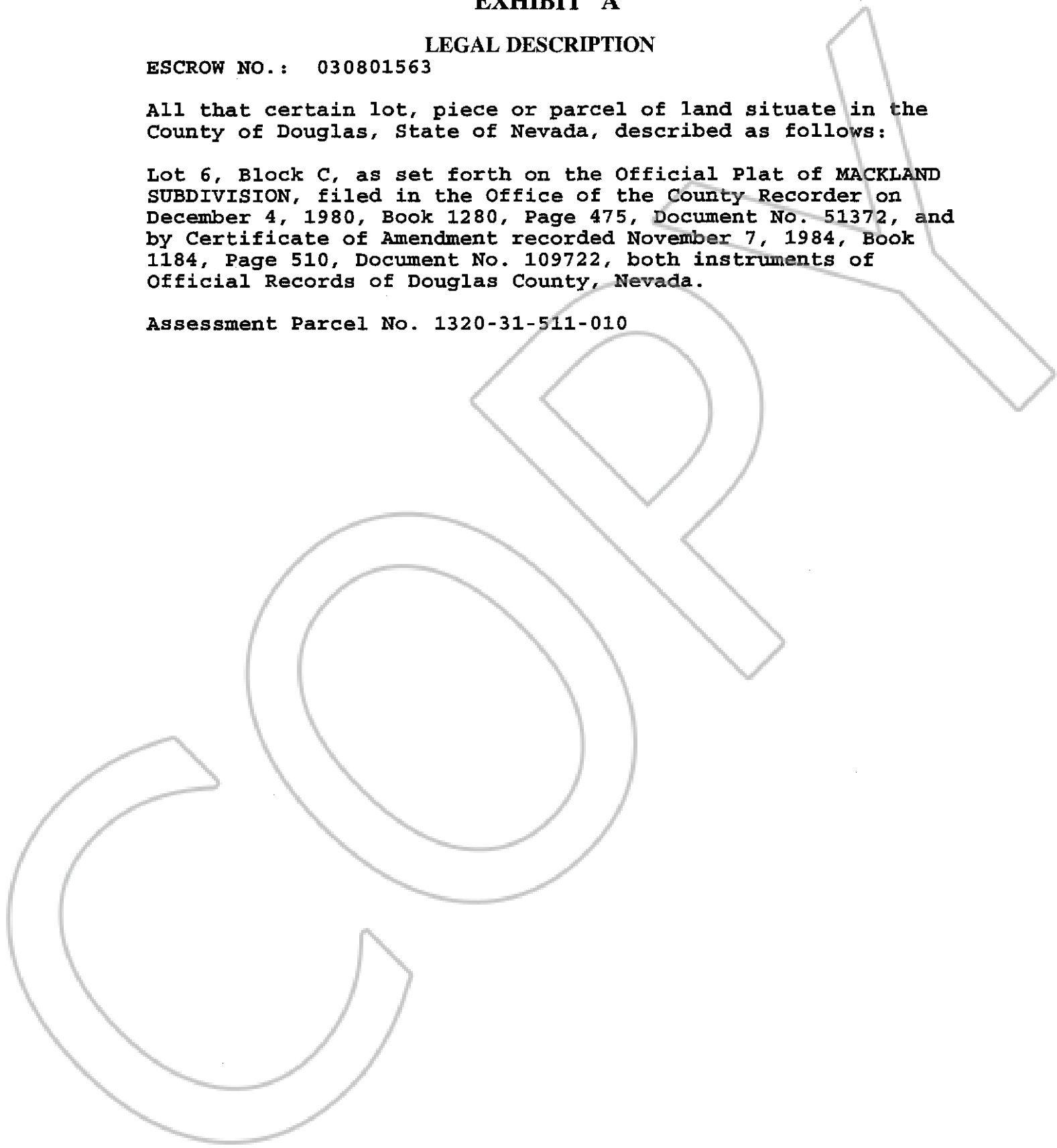

0582271

BK0703PG00640