

LINE DATA

BEARING	DISTANCE
L1 N 71°25'05" E	16.64'
L2 N 18°34'55" W (R)	4.50'

CURVE DATA

Δ	R	L	T
C1 57°33'49"	55.00'	55.26'	30.21'

- REFERENCE DOCUMENTS**
- (R1) JACKSON CREEK RANCH ESTATES, RECORDED IN BOOK 298, PAGE 4120, AS DOCUMENT No. 433187, OFFICIAL RECORDS OF DOUGLAS COUNTY.
 - (R2) RECORD OF SURVEY FOR JERALD R. JACKSON, RECORDED IN BOOK 1198, PAGE 3140, AS DOC. No. 454054, OFFICIAL RECORDS OF DOUGLAS COUNTY.
 - (R3) AMENDED RECORD OF SURVEY FOR JERALD R. JACKSON, RECORDED IN BOOK 501, PAGE 9960, AS DOC. No. 515523, OFFICIAL RECORDS OF DOUGLAS COUNTY.
 - (R4) RECORD OF SURVEY IN SUPPORT OF A BOUNDARY LINE ADJUSTMENT FOR THE JERALD R. JACKSON 1975 TRUST & THE IRENE M. WINDHOLZ TRUST RECORDED IN BOOK 802, PAGE 4320, AS DOC. No. 549527, OFFICIAL RECORDS OF DOUGLAS COUNTY.

BASIS OF BEARINGS

THE BEARING N 71°25'06" E FOR THE NORTHWESTERLY LINE AS SHOWN PER THE FINAL MAP FOR JACKSON CREEK RANCH ESTATES, AS DOCUMENT No. 433187, OFFICIAL RECORDS OF DOUGLAS COUNTY WAS USED AS THE BASIS OF BEARINGS FOR THIS MAP.

EASEMENTS:

A 5.00 FOOT EASEMENT ALONG ALL SIDE AND REAR PROPERTY LINES AND A 7.50 FOOT WIDE EASEMENT ALONG ALL STREET RIGHT-OF-WAY WITHIN THIS RECORD OF SURVEY ARE HEREBY GRANTED FOR PUBLIC UTILITY PURPOSES.

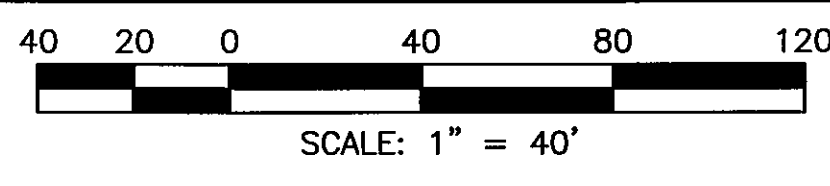

OWNER'S CERTIFICATE:

- WE, THE UNDERSIGNED OWNERS OF THE AFFECTED PARCELS AS SHOWN ON THIS MAP DO HEREBY STATE:
1. WE HAVE EXAMINED THIS PLAT AND APPROVE AND AUTHORIZE ITS RECORDING,
 2. WE AGREE TO EXECUTE THE REQUIRED DOCUMENTS CREATING ANY EASEMENT WHICH IS SHOWN HEREON,
 3. WE AGREE TO EXECUTE THE REQUIRED DOCUMENTS ABANDONING ANY EXISTING EASEMENT PURSUANT TO THE PROVISIONS OF NRS 278.010 TO 278.630, INCLUSIVE, AND SECTIONS 2 AND 3 OF CHAPTER 479 OF THE SIXTY-SIXTH LEGISLATIVE SESSION,
 4. ALL PROPERTY TAXES ON THE LAND FOR THE FISCAL YEAR HAVE BEEN PAID,
 5. ANY LENDER WITH AN IMPOUND ACCOUNT FOR THE PAYMENT OF TAXES HAS BEEN NOTIFIED OF THE ADJUSTMENT OF THE BOUNDARY LINE OR THE TRANSFER OF THE LAND.

Jerald R. Jackson
 JERALD R. JACKSON
 TRUSTEE OF THE JERALD R. JACKSON 1975 TRUST
 DATE 6-24-03

Irene M. Windholz
 IRENE M. WINDHOLZ
 TRUSTEE OF THE IRENE M. WINDHOLZ TRUST
 DATE 6-24-03

NOTARY CERTIFICATES:

STATE OF Nevada } S.S.
Douglas COUNTY }
 ON THIS 24th DAY OF June, 2003,
 PERSONALLY APPEARED BEFORE ME, A NOTARY PUBLIC IN AND FOR SAID COUNTY AND STATE, JERALD R. JACKSON, TRUSTEE OF THE JERALD R. JACKSON 1975 TRUST WHO ACKNOWLEDGED THAT HE EXECUTED THE ABOVE INSTRUMENT.

Sandra L. Winchell
 SANDRA L. WINCHELL
 NOTARY PUBLIC
 MY COMMISSION EXPIRES ON 11-04-06

STATE OF Nevada } S.S.
Douglas COUNTY }
 ON THIS 24th DAY OF June, 2003,
 PERSONALLY APPEARED BEFORE ME, A NOTARY PUBLIC IN AND FOR SAID COUNTY AND STATE, IRENE M. WINDHOLZ, TRUSTEE OF THE IRENE M. WINDHOLZ TRUST WHO ACKNOWLEDGED THAT SHE EXECUTED THE ABOVE INSTRUMENT.

Sandra L. Winchell
 SANDRA L. WINCHELL
 NOTARY PUBLIC
 MY COMMISSION EXPIRES ON 11-04-06

LEGEND

- - INDICATES SET 5/8" REBAR AND CAP P.L.S. 3209
- - INDICATES Fd. 5/8" REBAR AND CAP P.L.S. 3209
- ⦿ - INDICATES Fd. CLASS "A" WELL MONUMENT, P.L.S. 3209
- 22/23 27/26 - INDICATES Fd. SECTION CORNER AS NOTED

NOTE: THIS RECORD OF SURVEY IS NOT IN CONFLICT WITH THE REQUIREMENTS OF NRS 278.010 TO 278.630, INCLUSIVE.

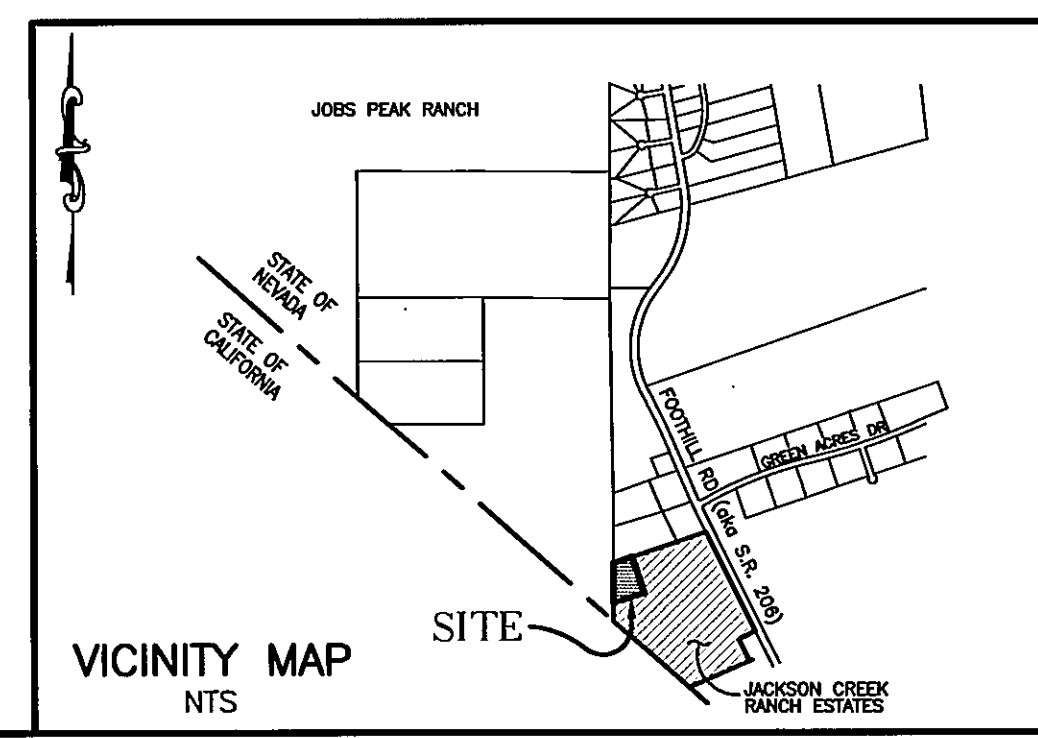

SURVEYOR'S CERTIFICATE:

- I, DAVID D. WINCHELL, A PROFESSIONAL LAND SURVEYOR REGISTERED IN THE STATE OF NEVADA, CERTIFY THAT:
1. THIS PLAT REPRESENTS THE RESULTS OF A SURVEY CONDUCTED UNDER MY SUPERVISION AT THE INSTANCE OF JERALD R. JACKSON.
 2. THE LANDS SURVEYED LIE WITHIN THE NORTH 1/2 OF SECTION 26, TOWNSHIP 12 NORTH, RANGE 19 EAST, M.D.B.&M., AND THE SURVEY WAS COMPLETED ON JUNE 13, 2003.
 3. THIS PLAT COMPLIES WITH APPLICABLE STATUTES OF THIS STATE AND ANY LOCAL ORDINANCES IN EFFECT ON THE DATE THAT THE SURVEY WAS CONDUCTED IN ACCORDANCE WITH CHAPTER 625 OF THE NEVADA ADMINISTRATIVE CODE.
 4. THE MONUMENTS DEPICTED ON THE PLAT ARE OF THE CHARACTER SHOWN, OCCUPY THE POSITIONS INDICATED, AND ARE OF SUFFICIENT DURABILITY.

David D. Winchell
 DAVID D. WINCHELL
 REGISTERED PROFESSIONAL LAND SURVEYOR
 EXPIRES 6/30/04
 P.L.S. 3209
 DATE 6/24/03

COUNTY TAX COLLECTOR'S CERTIFICATE:

I, BARBARA J. REED, DOUGLAS COUNTY CLERK-TREASURER AND EX-OFFICIO TAX COLLECTOR DO HEREBY CERTIFY THAT ALL PROPERTY TAXES ON THIS LAND FOR THE FISCAL YEAR HAVE BEEN PAID. (APN 1219-26-001-041, -042)

Barbara J. Reed
 BARBARA J. REED
 DOUGLAS COUNTY CLERK-TREASURER
 By: *Carl John Deputy Treasurer*

COMMUNITY DEVELOPMENT DEPARTMENT CERTIFICATE:

IT IS HEREBY CERTIFIED THAT THIS PLAT WAS PRESENTED BEFORE THE DOUGLAS COUNTY COMMUNITY DEVELOPMENT ON THE 13th DAY OF JULY, 2003, AND WAS DULY APPROVED. FURTHERMORE THIS MAP IS IN SUBSTANTIAL CONFORMANCE WITH ALL APPLICABLE PROVISIONS OF STATE STATUTES AND COUNTY CODE.

Tammy J. Vogt
 BY: TAMMY J. VOGT
 PLANNING, BUILDING AND ECONOMIC DEVELOPMENT DIRECTOR
 COMMUNITY DEVELOPMENT DEPARTMENT

COUNTY RECORDER'S CERTIFICATE:

FILED THIS 3rd DAY OF July, 2003 AT 55 MINUTES PAST 11 O'CLOCK P.M. IN BOOK 0703 AT PAGE 1542.
 DOCUMENT NUMBER 582441
 RECORDED AT THE REQUEST OF Irene Windholz

Gamela Kronenberg, Deputy
 DOUGLAS COUNTY RECORDER

RECORD OF SURVEY
 IN SUPPORT OF A BOUNDARY LINE ADJUSTMENT FOR
**THE JERALD R. JACKSON 1975 TRUST &
 THE IRENE M. WINDHOLZ TRUST**
 LOCATED WITHIN A PORTION OF THE NORTH 1/2 OF SECTION 26
 TOWNSHIP 12 NORTH, RANGE 19 EAST, M.D.B. & M.
 BEING LOTS 6A & 7A RECORD OF SURVEY IN SUPPORT OF A BOUNDARY LINE
 ADJUSTMENT FOR THE JERALD R. JACKSON 1975 TRUST & THE IRENE M. WINDHOLZ
 TRUST, RECORDED IN BOOK 802, PAGE 4320, AS DOC. No. 549527
 DOUGLAS COUNTY NEVADA
 SHEET 1 OF 1 SHEET

26-12-19