

REQUESTED BY  
**Stewart Title of Douglas County**  
IN OFFICIAL RECORDS OF  
DOUGLAS CO., NEVADA

2003 JUL -3 PM 3: 23

WERNER CHRISTEN  
RECORDER

\$ 16.00 BC DEPUTY

APN 1320-33-311-031

Recording Requested By:

**Stewart Title of Douglas County**

1650 N. Lucerne, Ste. 101

Minden, NV 89423

---

Notice of Completion  
(Title of Document)

This page added to provide additional information required by NRS 111.312 Sections 1-2.  
(Additional recording fee applies)

This cover page must be typed.

0582479

BK0703PG01749



**EXHIBIT "A"**

**LEGAL DESCRIPTION**

**ESCROW NO.: 020308729**

**Lot 26, Block B, as set forth on Final Subdivision Map  
FSM-1006-2 for CHICHESTER ESTATES Phase 2, filed for record in  
the office of the County Recorder of Douglas County, State of  
Nevada, on December 9, 1996, in Book 1296 at Page 1286, as  
Document No. 402540.**

**Assessors Parcel No. 1320-33-311-031**

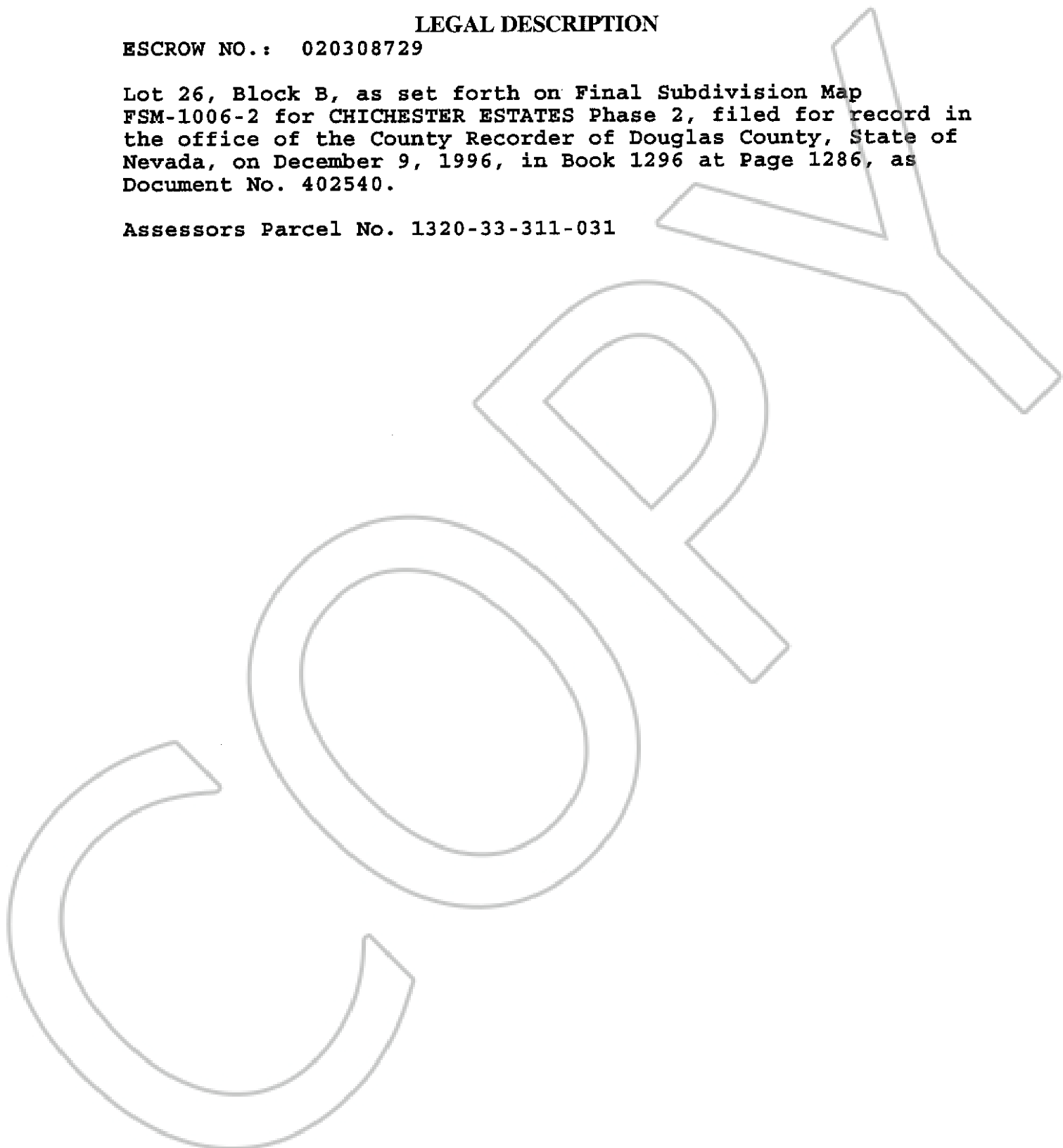

**0582479**

**BK0703PG01751**