

A.P.N. # 1318-23-710-088

R.P.T.T. \$ 611.00  
ESCROW NO. 030201755

RECORDING REQUESTED BY:  
**STEWART TITLE COMPANY**  
MAIL TAX STATEMENTS TO:  
Richard Kasa  
P.O. 1097  
Solvang Ca 93464  
WHEN RECORDED MAIL TO:  
**GRANTEE** Mr Kasa  
P.O. 1097  
Solvang CA 93464

REQUESTED BY  
**Stewart Title of Douglas County**  
IN OFFICIAL RECORDS OF  
DOUGLAS CO., NEVADA

2003 JUL 11 PM 3:19

WERNER CHRISTEN  
RECORDER

615<sup>00</sup> PAID Kg DEPUTY

(Space Above for Recorder's Use Only)

### GRANT, BARGAIN, SALE DEED

THIS INDENTURE WITNESSETH: That **R. THOMAS DRISCOLL** and **PATRICIA J. DRISCOLL**, Trustees of **THE DRISCOLL FAMILY REVOCABLE LIFETIME A-B TRUST DATED APRIL 22, 1996**

in consideration of \$10.00, the receipt of which is hereby acknowledged, does hereby Grant, Bargain Sell and Convey to  
**RICHARD S. KASA AND LAURIE KASA, HUSBAND AND WIFE**  
AS COMMUNITY PROPERTY

and to the heirs and assigns of such Grantee forever, all that real property situated in the  
City of \_\_\_\_\_ County of **Douglas** State of Nevada, bounded and described as follows:  
**SEE EXHIBIT "A" ATTACHED HERETO AND MADE A PART HEREOF**

Together with all and singular the tenements, hereditaments and appurtenances thereunto belonging or in anyway appertaining, and any reversions, remainders, rents, issues or profits thereof.

DATE: **May 22, 2003**



*R. Thomas Driscoll*  
\_\_\_\_\_  
R. THOMAS DRISCOLL, TRUSTEE

*Patricia J. Driscoll*  
\_\_\_\_\_  
PATRICIA J. DRISCOLL, TRUSTEE

STATE OF Nevada }  
  } ss.  
COUNTY OF Douglas }

This instrument was acknowledged before me on 6/10/03.  
by R. Thomas Driscoll, Trustee.  
Patricia J. Driscoll, Trustee.

Signature *Lori Mae Silva*  
\_\_\_\_\_  
Notary Public  
(Space Below for Recorder's Use Only)

**0583005**

**BK0703PG04827**

**EXHIBIT "A"**

**LEGAL DESCRIPTION**

**ESCROW NO.: 030201755**

**Lot 88, as shown on the map of LAKEWOOD KNOLLS SUBDIVISION,  
Douglas County, Nevada, filed in the Office of the County  
Recorder of Douglas County, Nevada, on May 29, 1958, under  
Document No. 13163.**

**Assessor's Parcel No. 1318-23-710-088**

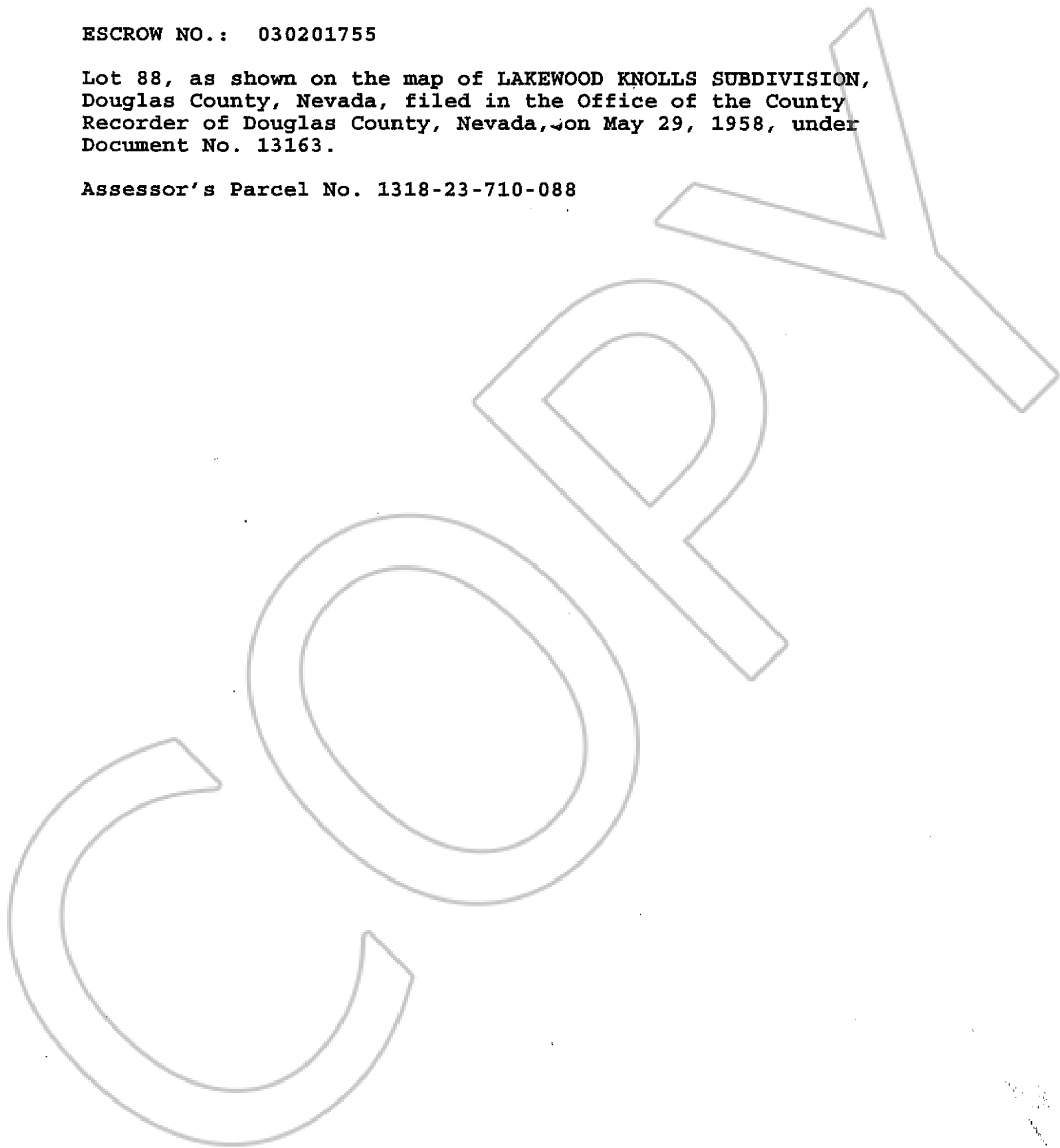

**0583005**

**BK0703PG04828**