

A.P.N. # 1219-23-001-016

R.P.T.T. \$ 5

ESCROW NO. _____

RECORDING REQUESTED BY _____

MAIL TAX STATEMENTS TO:
✓ **GRANTEE** *Thomas W Greenlee Sr*
424 LILLIAN COURT
GARDNERVILLE, NV. 89460

WHEN RECORDED MAIL TO:
GRANTEE
424 LILLIAN COURT
GARDNERVILLE, NV. 89460

REQUESTED BY
Carol Greenlee
IN OFFICIAL RECORDS OF
DOUGLAS CO., NEVADA

2003 JUL 14 AM 9:10

WERNER CHRISTEN
RECORDER

\$15.00 FEE
_____ *AB* DEPUTY

(Space Above for Recorder's Use Only)

GRANT, BARGAIN, SALE DEED

THIS INDENTURE WITNESSETH: That **THOMAS W. GREENLEE, SR.,** a married man as his sole and separate property

in consideration of \$10.00, the receipt of which is hereby acknowledged, does hereby Grant, Bargain Sell and Convey to **THOMAS W. GREENLEE, SR.** and **CAROL S. GREENLEE,** husband and wife as joint tenants

and to the heirs and assigns of such Grantee forever, all that real property situated in the **unincorporated area** County of **DOUGLAS** State of Nevada, bounded and described as:
SEE EXHIBIT "A" ATTACHED HERETO AND MADE A PART HEREOF

Together with all and singular the tenements, hereditaments and appurtenances thereunto belonging or in anywise appertaining, and any reversions, remainders, rents, issues or profits thereof.

DATE: **July 11, 2003**

Thomas W Greenlee Sr
THOMAS W. GREENLEE, SR.

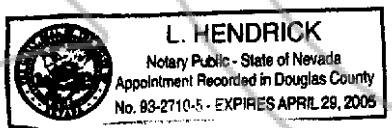

STATE OF NEVADA }
 } ss.
COUNTY OF DOUGLAS }

This instrument was acknowledged before me on 7-11-03
by, **THOMAS W. GREENLEE, SR.**

Signature *L. Hendrick*
Notary Public (One inch margin on all sides of document for Recorder's Use Only)

0583053
BK 0703 PG 05200

EXHIBIT "A"

LEGAL DESCRIPTION

Being a portion of the Northwest 1/4 of Section 23, Township 12 North, Range 19 East, M.D.B.&M., further described as follows:

Parcel 1 of Parcel Map No. 1 for Lillian Clarasso and Natale Clarasso, filed for record in the office of the County Recorder of Douglas County, State of Nevada, on October 23, 1984, in Book 1084, Page 2518, as Document No. 109102, and by Certificate of Amendment recorded December 4, 1986, in Book 1286, Page 476, Document No. 146105.

Assessment Parcel No. 1219-23-001-016

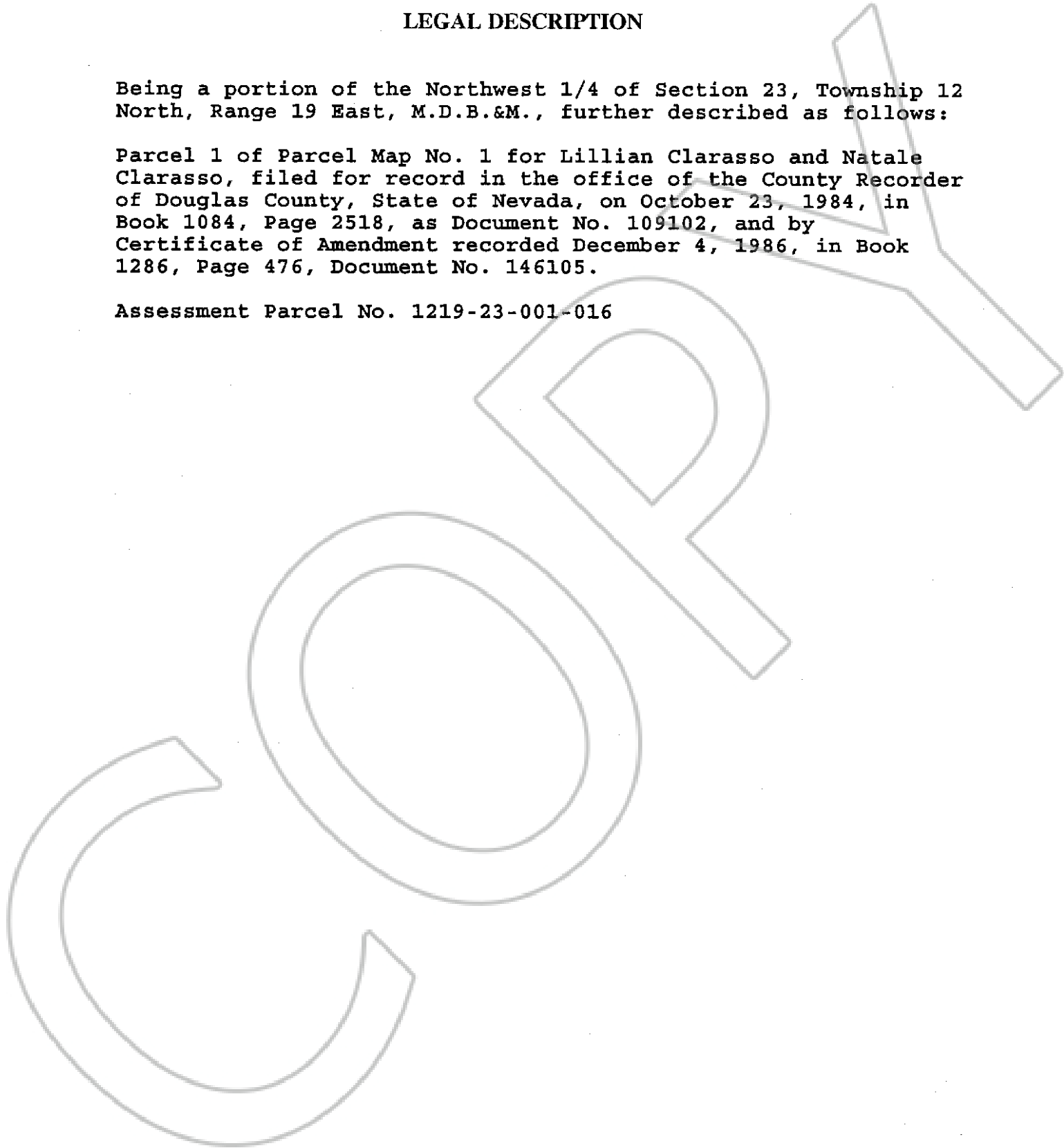

0583053

BK 0703 PG 05201