

REQUESTED BY  
**Stewart Title of Douglas County**

IN OFFICIAL RECORDS OF  
DOUGLAS CO., NEVADA

2003 JUL 17 PM 3:13

WERNER CHRISTEN  
RECORDER

\$ 41.00 PAID KJ DEPUTY

APN 1420-33-810-064

Recording Requested By:

**Stewart Title of Douglas County**

1650 N. Lucerne, Ste. 101

Minden, NV 89423

---

*RPTT/309.40*

*DEEN*

(Title of Document)

This page added to provide additional information required by NRS 111.312 Sections 1-2.  
(Additional recording fee applies)

This cover page must be typed.

0583545

BK0703PG07845

A.P.N. # 1420-33-810-064

R.P.T.T. \$ 309.40  
ESCROW NO. 030200596  
Full Value

RECORDING REQUESTED BY:  
**STEWART TITLE COMPANY**  
WHEN RECORDED MAIL TO:  
MAIL TAX STATEMENTS TO:

**GRANTEE**  
1322 JOHNSON LANE  
MINDEN, NV 89423

**GRANT, BARGAIN, SALE DEED**

THIS INDENTURE WITNESSETH: That **NORMAN E. THOMAS AND MARY ANN THOMAS, HUSBAND AND WIFE**

in consideration of \$10.00, the receipt of which is hereby acknowledged, does hereby Grant, Bargain Sell and Convey to  
**JOHN M. EDDY AND LESLIE M. EDDY, HUSBAND AND WIFE AS JOINT TENANTS**

and to the heirs and assigns of such Grantee forever, all that real property situated in the County of **Douglas** State of Nevada, bounded and described as follows:  
**Lot 13, of IDLE ACRES SUBDIVISION, as shown on the Official Map thereof, filed in the Office of the County Recorder of Douglas County, Nevada, on April 5, 1960, in Book 1 of Maps, Document No. 15812.**

**Assessors Parcel No 1420-33-810-064**

Together with all and singular the tenements, hereditaments and appurtenances thereunto belonging or in anywise appertaining, and any reversions, remainders, rents, issues or profits thereof.

DATE: **April 10, 2003**

*Norman E. Thomas*  
\_\_\_\_\_  
**NORMAN E. THOMAS**

*Mary Ann Thomas*  
\_\_\_\_\_  
**MARY ANN THOMAS**

STATE OF Nevada }  
COUNTY OF Douglas } ss.

This instrument was acknowledged before me on 5/13/03  
by, NORMAN E. THOMAS and MARY ANN THOMAS

Signature Denise Rudnick  
Notary Public

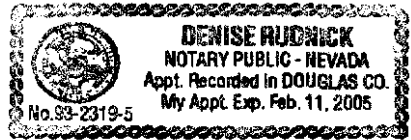

**0583545**  
**BK0703PG07846**

**EXHIBIT "A"**

**LEGAL DESCRIPTION**

ESCROW NO.: 030200596

Lot 13, of IDLE ACRES SUBDIVISION, as shown on the Official Map thereof, filed in the Office of the County Recorder of Douglas County, Nevada, on April 5, 1960, in Book 1 of Maps, Document No. 15812.

Assessors Parcel No 1420-33-810-064

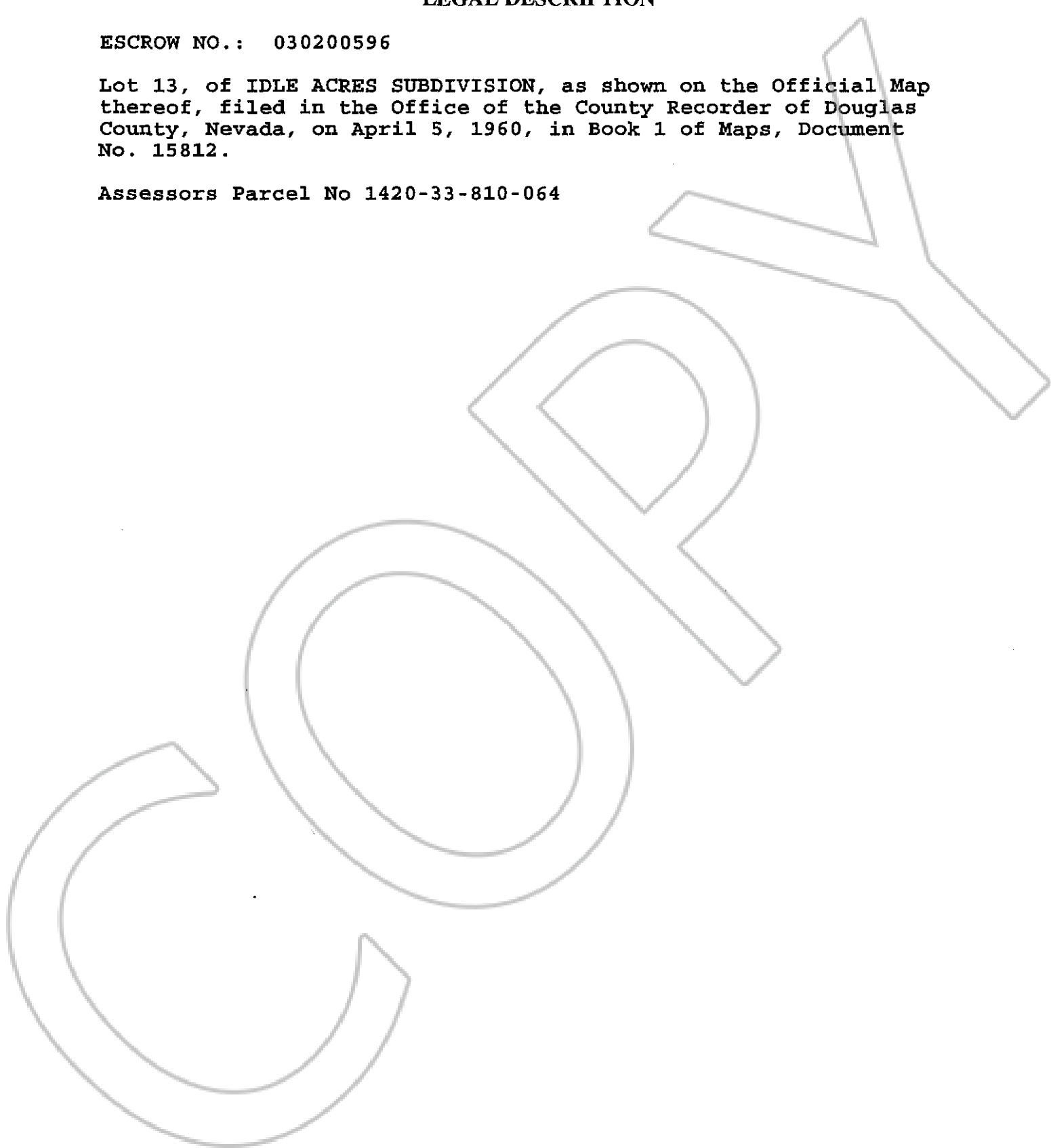

0583545  
BK0703PG07847