

A.P.N. # 1220-17-411-006

R.P.T.T. \$ #8a  
ESCROW NO. 030201827

RECORDING REQUESTED BY:  
**STEWART TITLE COMPANY**

MAIL TAX STATEMENTS TO:  
**SAME AS BELOW**  
P.O. Box 1709  
Card. NV 89410

WHEN RECORDED MAIL TO:  
Grantee  
P.O. Box 1709  
Card. NV 89410

REQUESTED BY  
**Stewart Title of Douglas County**  
IN OFFICIAL RECORDS OF  
DOUGLAS CO., NEVADA

2003 JUL 18 PM 3:43

WERNER CHRISTEN  
RECORDER

\$15.00 PAID KJ DEPUTY

(Space Above for Recorder's Use Only)

**GRANT, BARGAIN, SALE DEED**

THIS INDENTURE WITNESSETH: That **JERRY M. NOOSINOW AND JEAN L. NOOSINOW, HUSBAND AND WIFE AS JOINT TENANTS**

in consideration of \$10.00, the receipt of which is hereby acknowledged, does hereby Grant, Bargain Sell and Convey to **JERRY M. NOOSINOW AND JEAN L. NOOSINOW, TRUSTEES OF THE JERRY M. AND JEAN L. NOOSINOW FAMILY TRUST DATED SEPTEMBER 7, 2001**

and to the heirs and assigns of such Grantee forever, all that real property situated in the County of **DOUGLAS** State of Nevada, bounded and described as:

**SEE EXHIBIT "A" ATTACHED HERETO AND MADE A PART HEREOF**

Together with all and singular the tenements, hereditaments and appurtenances thereunto belonging or in anywise appertaining, and any reversions, remainders, rents, issues or profits thereof.

DATE: **July 11, 2003**

THIS INSTRUMENT IS BEING RECORDED AS AN ACCOMMODATION ONLY NO LIABILITY, EXPRESSED OR IMPLIED, IS ASSUMED AS TO ITS REGULARITY OR SUFFICIENCY NOR AS TO ITS AFFECT, IF ANY, UPON TITLE TO ANY REAL PROPERTY DESCRIBED THEREIN.

STEWART TITLE OF DOUGLAS COUNTY

Jerry M. Noosinow  
**JERRY M. NOOSINOW**  
Jean L. Noosinow  
**JEAN L. NOOSINOW**

STATE OF Nevada  
COUNTY OF Douglas ss.



This instrument was acknowledged before me on 7-14-03  
by **JERRY M. NOOSINOW and JEAN L. NOOSINOW**

Signature Mary H. Kelsh  
Notary Public (One inch margin on all sides of document for Recorder's Use Only)

0583699

BK0703PG08664

**EXHIBIT "A"**

**LEGAL DESCRIPTION**

**ESCROW NO.: 030202477**

**Lot 25, Block B, as said Lot and Block are shown on the Amended map of RANCHOS ESTATES, filed in the office of the County Recorder of Douglas County, State of Nevada, on October 30, 1972, as Document No. 62493.**

**Assessor's Parcel No. 1220-16-210-053**

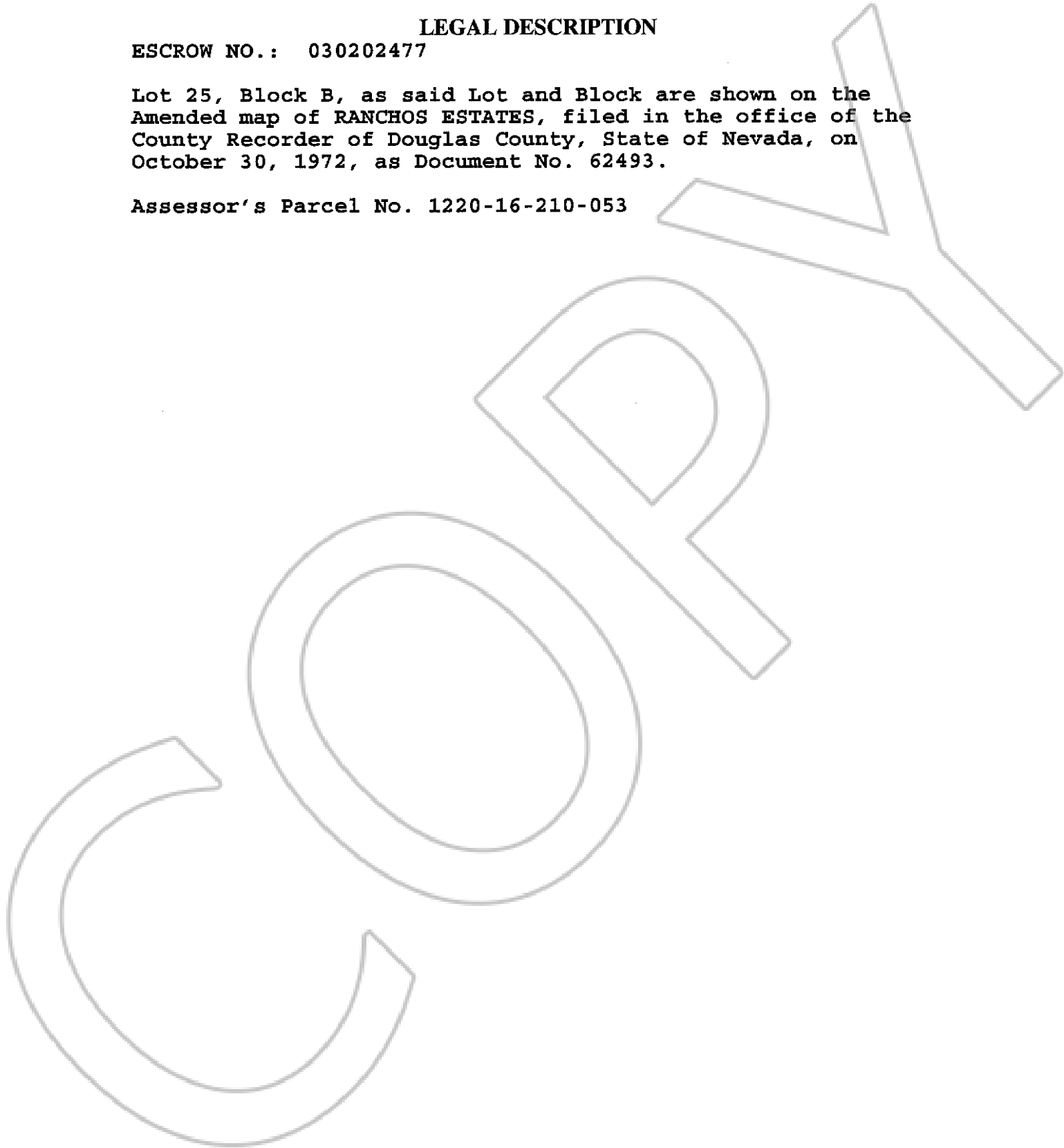

**0583699**

**BK0703PG08665**