

16-
#2

REQUESTED BY
Karen Nelson
IN OFFICIAL RECORDS OF
DOUGLAS CO., NEVADA

2003 JUL 22 PM 3:15

WERNER CHRISTEN
RECORDER

16.00 PAID KJ DEPUTY

APN: 1220-22-310-152

RECORDING REQUESTED BY: }
Anderson & Dorn, Ltd. }
294 East Moana Lane, Suite B-27 }
Reno, Nevada 89509 }

AFTER RECORDING MAIL TO: }
Karen Keebaugh Nelson }
135 Zellmer Lane }
Markleeville, CA 96120 }

MAIL TAX STATEMENT TO: }
Karen Keebaugh Nelson }
135 Zellmer Lane }
Markleeville, CA 96120 }

RPTT: \$0.00 Exempt (8a)
Exempt (8a): A transfer of title to or from a trust, if the transfer is made without consideration.

GRANT, BARGAIN, SALE DEED

THIS INDENTURE WITNESSETH THAT,

KAREN SUE KEEBAUGH also known as KAREN KEEBAUGH NELSON, as a single woman,

For no consideration, does hereby Grant, Bargain, Sell and Convey unto:

Curtis A. Nelson and Karen Keebaugh Nelson, Trustees or their successors in trust, under the NELSON LIVING TRUST, dated August 5, 2002 and any amendments thereto, (Wife Separate Property),

A 50% interest in that real property situated in the **County of Douglas**, State of Nevada, more particularly described in Exhibit "A", attached hereto and incorporated herein.

- Subject To:
- 1. Taxes for the Current fiscal year, paid current
 - 3. Restrictions, Conditions, Covenants, Rights, Rights of Way, and Easements now of record, if any.

0584019

BK0703PG10105

WITNESS our hands, this 22 day of July, 2003.

Karen Sue Keebaugh
KAREN SUE KEEBAUGH

STATE OF Nevada }
COUNTY OF Washoe } ss:
}

This instrument was acknowledged before me, this

22nd day of July, 2003,
by KAREN SUE KEEBAUGH aka KAREN KEEBAUGH NELSON

Jacquelyn Lemmon Thomas
Notary Public

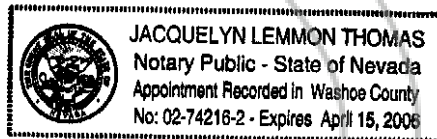

0584019

BK0703PG10106

EXHIBIT "A"

Legal Description:

Lot 732, as shown on the map of GARDNERVILLE RANCHOS UNIT NO. 7, filed for record in the office of the County Recorder of Douglas County, Nevada, on March 27, 1974, as Document No. 72456.

Property Address: 685 Long Valley Road Gardnerville, NV 89460

APN: 1220-22-310-152

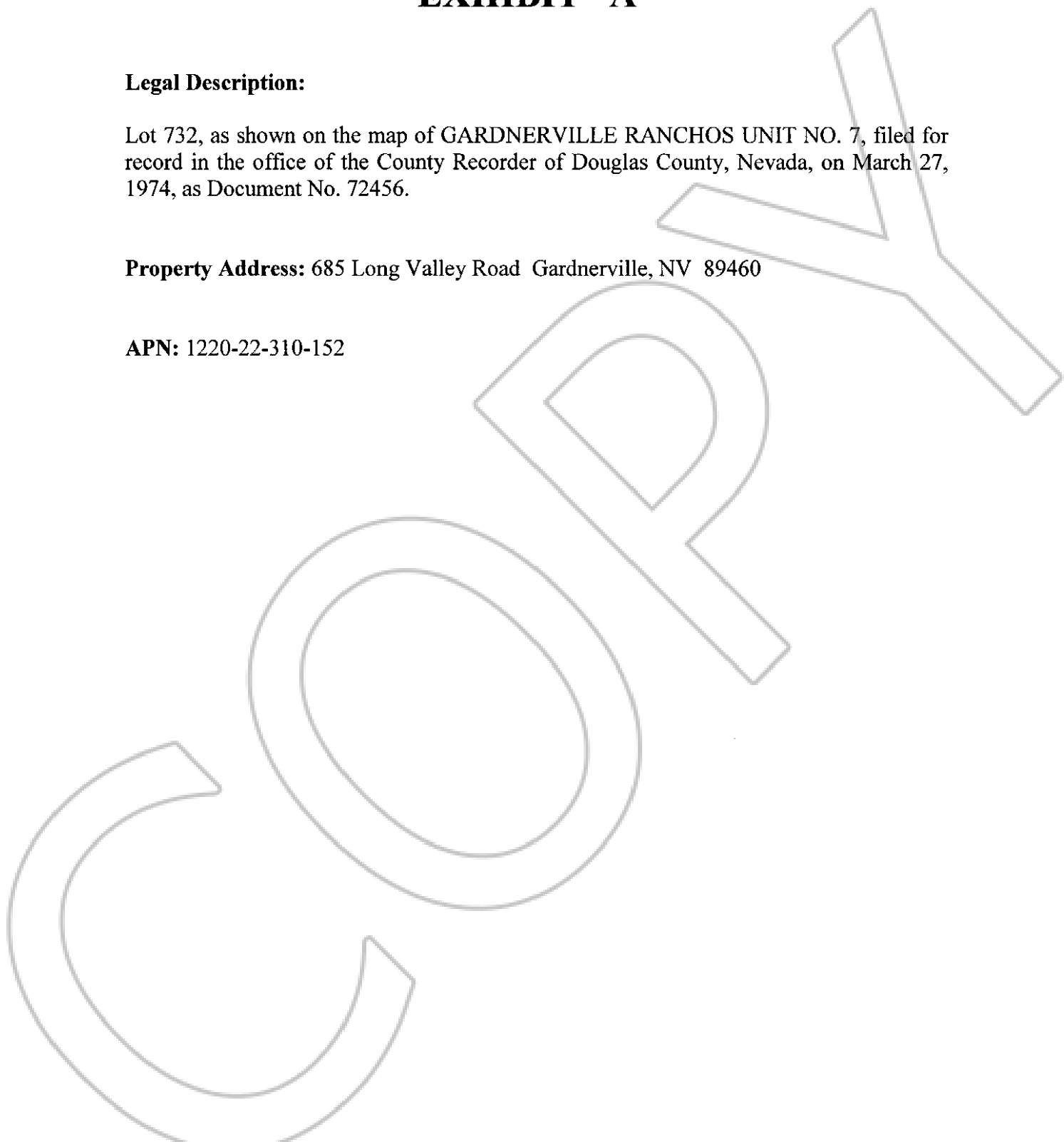

0584019
BK0703PG10107